



FELLOWS' DINING ROOM

DINING 80

With a delightful view of the lawn through the windows, the Fellows' Dining Room is a fabulous venue for formal dining, seating up to 80 guests. Alternatively, the room can also be used for summer events, exhibitions, and refreshment services. Initially designed as an arts and crafts classroom in 1903, it became a College library in 1936. It later became the Combination Room in 1968 and then a College dining room in 2004. Its glazed doors to the west open out onto the lawn making it a popular venue when the weather is fine. The Drawing Room and the Fellows' Dining Room are both licensed to hold civil wedding ceremonies.

DIMENSIONS

8.5m x 20m
170m²

CAPACITIES

Dining 80
Cabaret 80

 Light switch

 Double plug socket

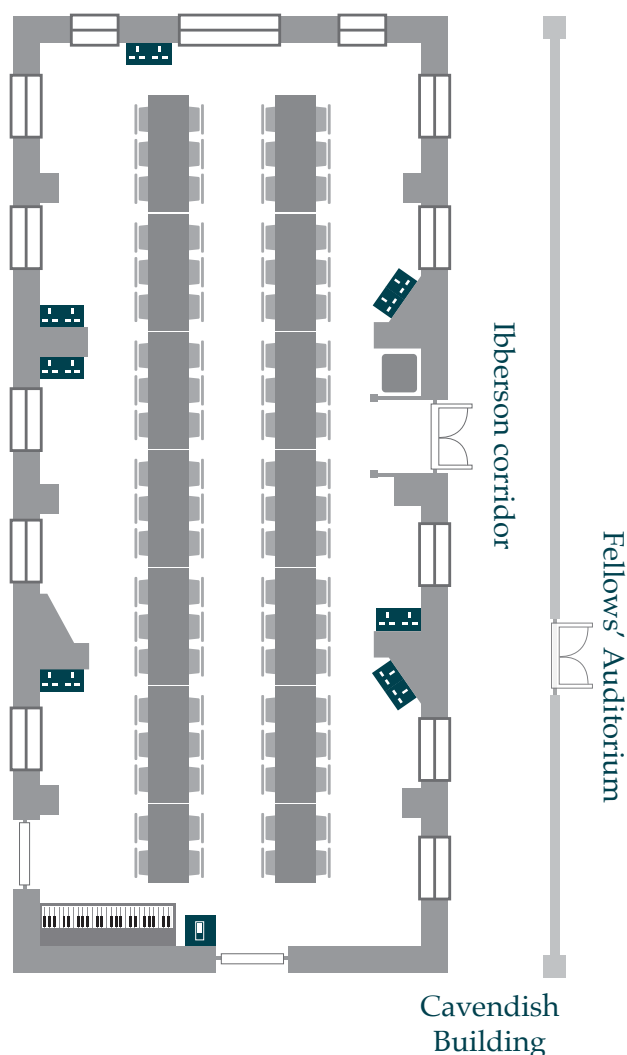

FELLOWS' DINING ROOM LAYOUT

LOCATION

Ibberson Building
Ground floor (step-free access)
Enter via the Cavendish or
New Dining Hall Door

EQUIPMENT

Audio system
Wireless microphone
WiFi coverage

OTHER FACILITIES

AV technician on request

P Parking is available on a
first come first serve basis.

✓ In the event of a fire:
Evacuate at the nearest exit and
assemble on the D+E lawn.

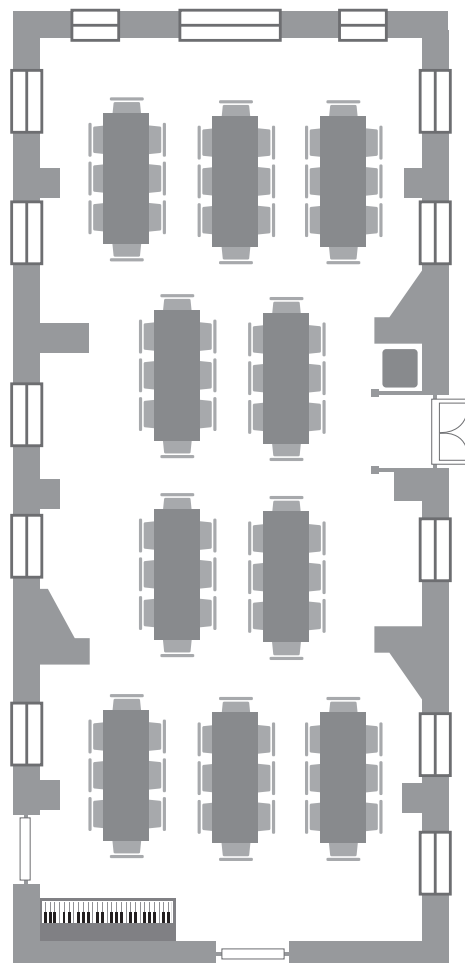

CABARET 80