

# pitch

**Pitch.**  
Canary Wharf  
Christmas Events  
17th November - 22nd December





# Pitch Wharf

First Floor - Main bar area



# Pitch Wharf

Pitch Wharf was built with hosting spectacular events all year around in mind. Overlooking the Canal and spread across two distinct floors, your guests can enjoy a night to remember where a little competitive fun meets a lot of style and sophistication.

The main floor features a panoramic view of The Wharf, 11 simulator bays, a huge bar and a sprawling lounge with live DJ as requested.

The huge windows are a feature which our guests love and allow attendees to enjoy a rare mix of gaming with sunlight throughout. For very large groups the downstairs bar with outdoor terrace and shuffle area can also be hired to create a blockbuster experience.



# Activities

This festive season, Pitch Wharf brings an unforgettable blend of entertainment, competition, and celebration. Not only can you choose to have exclusive use of the stunning venue, and enjoy the delicious food, we will also work with you to customise your event, incorporating the fun activities of your choice to ensure everyone is joining in and having a great time. Selection of activities include:

- Fun interactive golf games for all abilities
- Casino corner
- Big Screen Racing Games
- Trackman golf courses
- Shuffleboard

If you would like to split your evening between multiple activities for a period before enjoying a classic Christmas party with festive music, this can be arranged.





# Shuffleboard

Alongside our interactive bays and vibrant social spaces, Pitch Wharf is levelling up with the addition of **three shuffleboard tables!**

This exciting new addition brings more ways to compete, connect, and unwind. Perfect for elevating your events, shuffleboard adds a unique blend of strategy and social play to any occasion.

# Food & Drink

Our food offering will undoubtedly be a standout feature of your special event. When mixed with delicious cocktails, Japanese lager and a very modern wine list, your guests will be spoilt for choice.





# Full Venue Hire

Wow your guests with a full venue hire at Pitch Wharf for up to 400 guests, with exclusive access to all gaming bays, shuffleboard tables, the social lounge, DJ and the outdoor terrace.

This is the perfect venue for corporate events, private parties, brand activations, and large-scale celebrations. As one of the largest event spaces in Canary Wharf, Pitch Wharf offers a versatile and dynamic setting that can be tailored to suit a wide range of events.

To secure the space, a **minimum spend of £30K applies** which will vary depending on the day.

# Full Venue Hire

Ground Floor -->

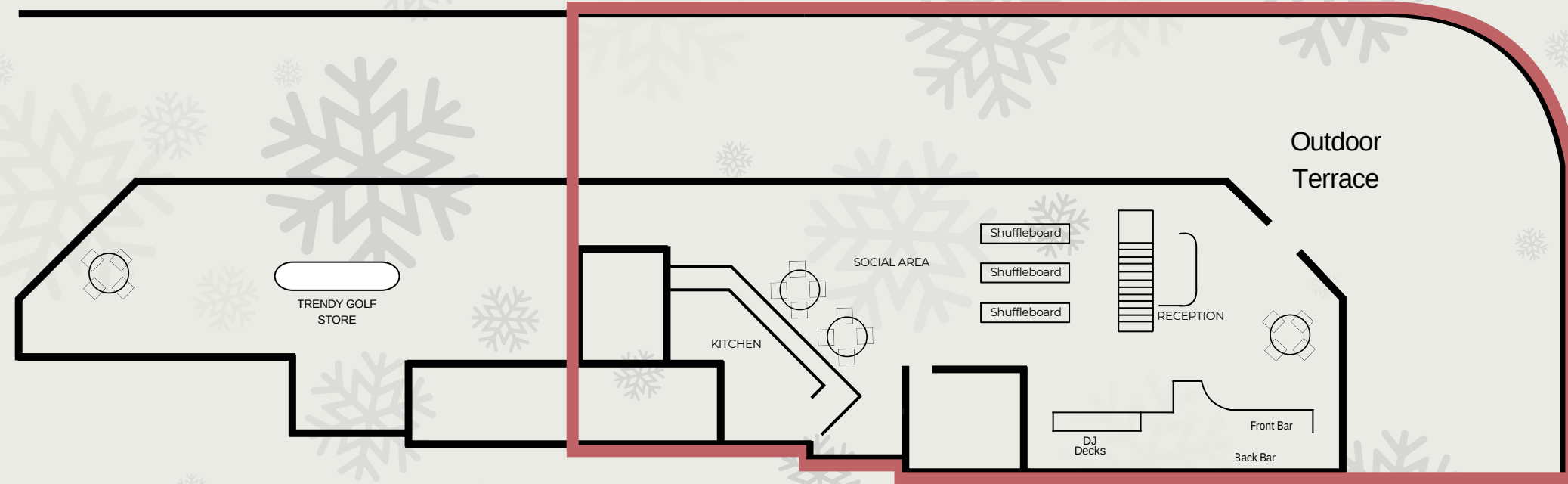

First Floor -->

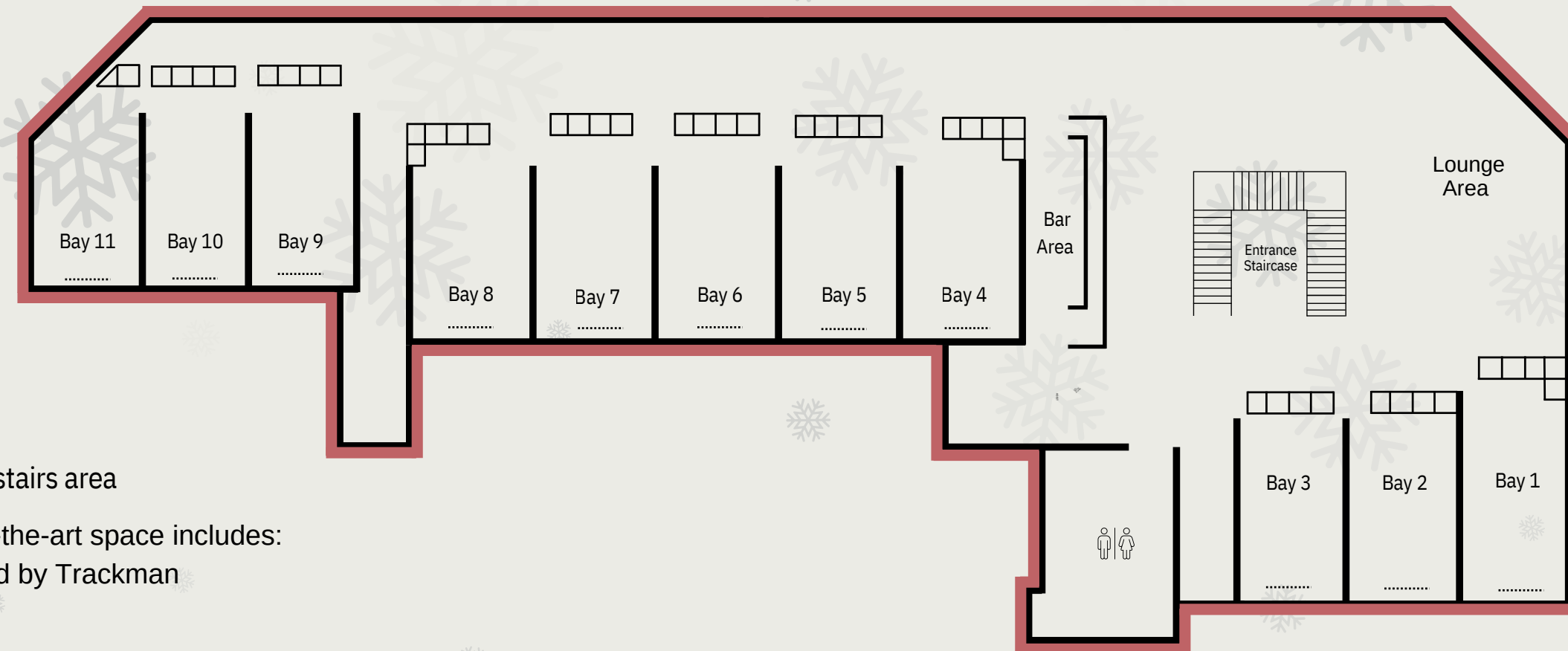

● = Full access to all of downstairs and upstairs area

Covering 14,500 square feet, this state-of-the-art space includes:

- Eleven Ultra-HD gaming bays powered by Trackman
- A bar and restaurant
- Riverside terrace with seating
- Panoramic View
- Three Shuffleboards

# Half Venue Hire – Upstairs

Half-venue hire at Pitch Wharf offers exclusive access to our upstairs space which includes 11 golf bays and a large social area with panoramic views of Canary Wharf.

Capacity up to 220 people.

To secure the space, a **minimum spend of £12K** applies which will vary depending on the day.

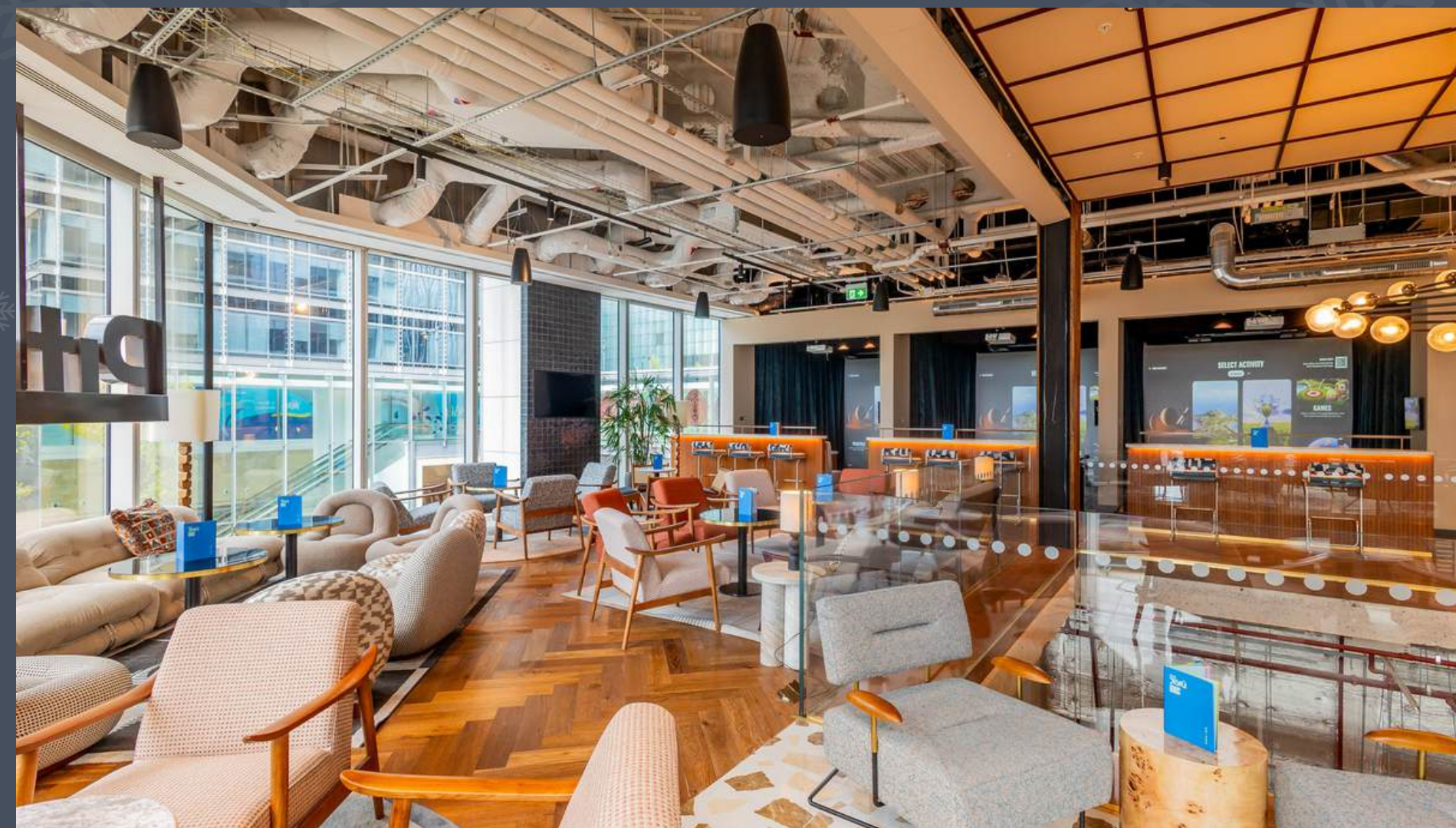



# Half Venue Hire - Up & Downstairs

Half-venue hire at Pitch Wharf offers a dedicated area downstairs with three golf bays and shuffleboard tables. Perfect for team socials, client events, and celebrations, this option provides a vibrant atmosphere while keeping the space private for your group.

Capacity up to 220 people.

To secure the space, a **minimum spend of £12K** applies which will vary depending on the day.

# Half Venue Hire

Ground Floor -->

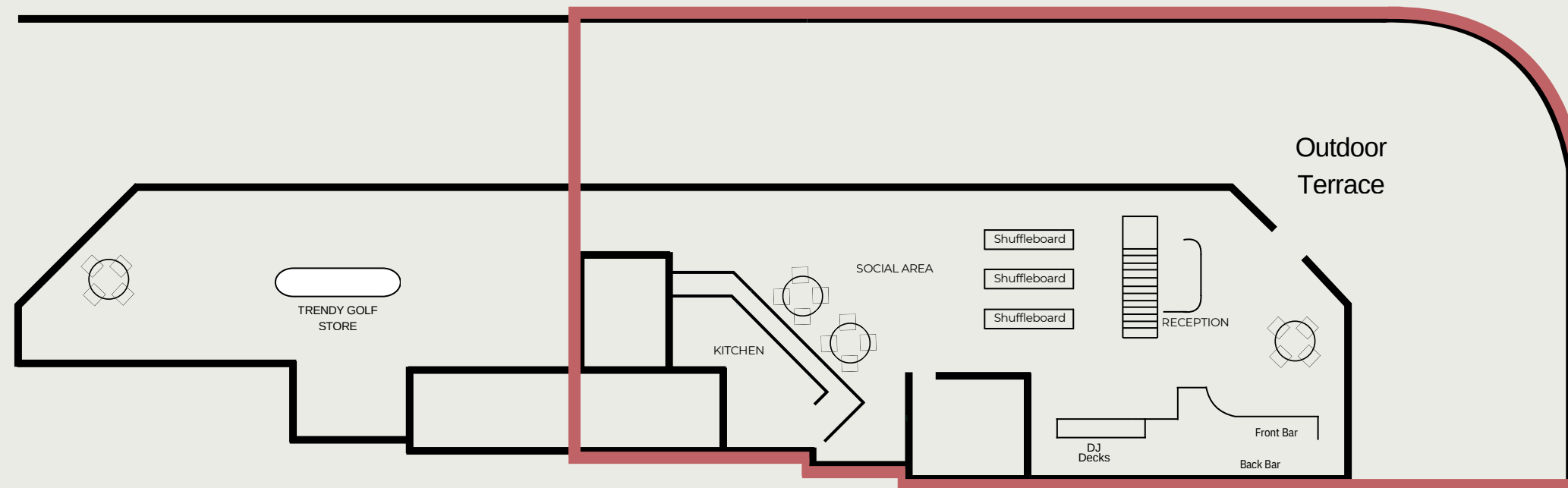

First Floor -->

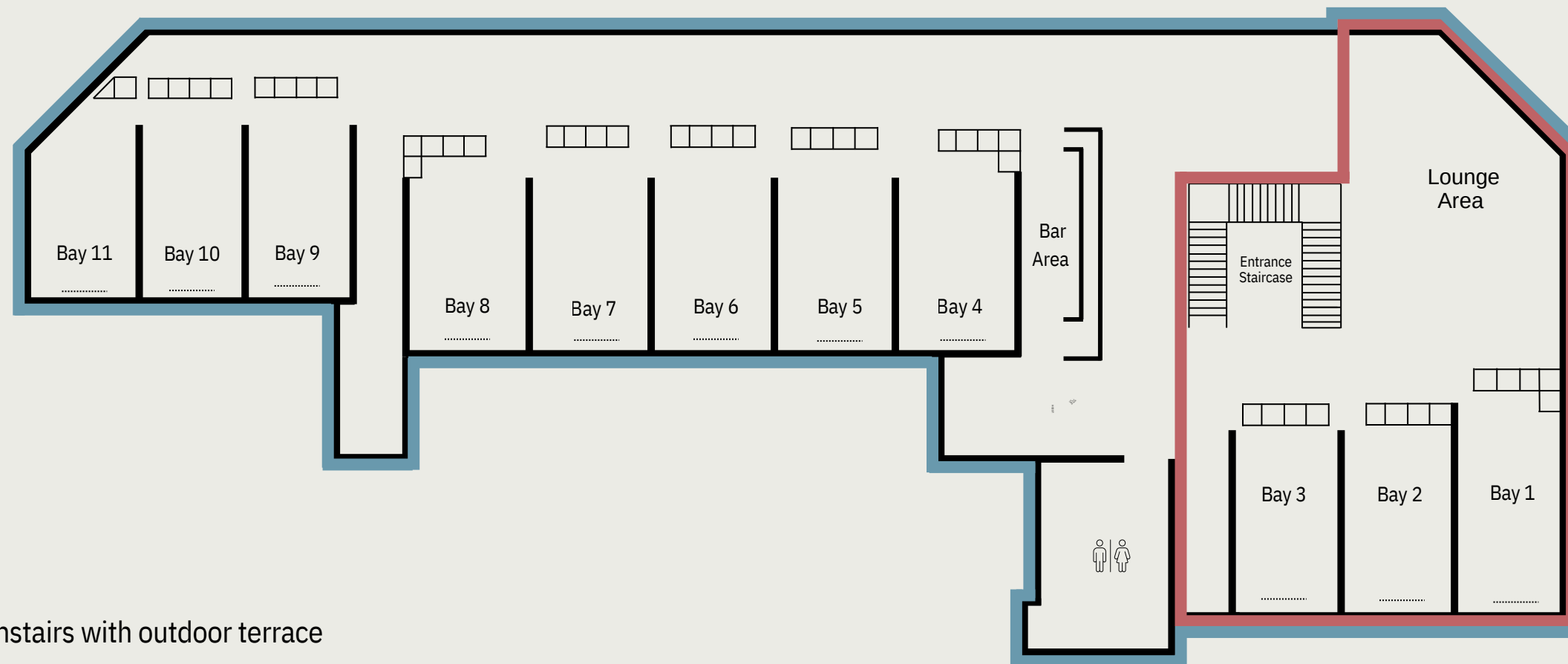

- = Three bays upstairs and area downstairs with outdoor terrace
- = Full access to all of upstairs

# Small Area Hire

For a more tailored event experience, our small area hire at Pitch Wharf offers flexible options to suit your needs. Choose from exclusive access to three bays and the downstairs shuffleboard area, five bays, or a custom setup.

Our private spaces offer exclusive access to top-tier golf technology, lively social areas, and a premium food and drink offering.

Recommended for 60 people.

To secure the space, a **minimum spend of £5K** applies which will vary depending on the day.



# Small Area Hire

Ground Floor -->

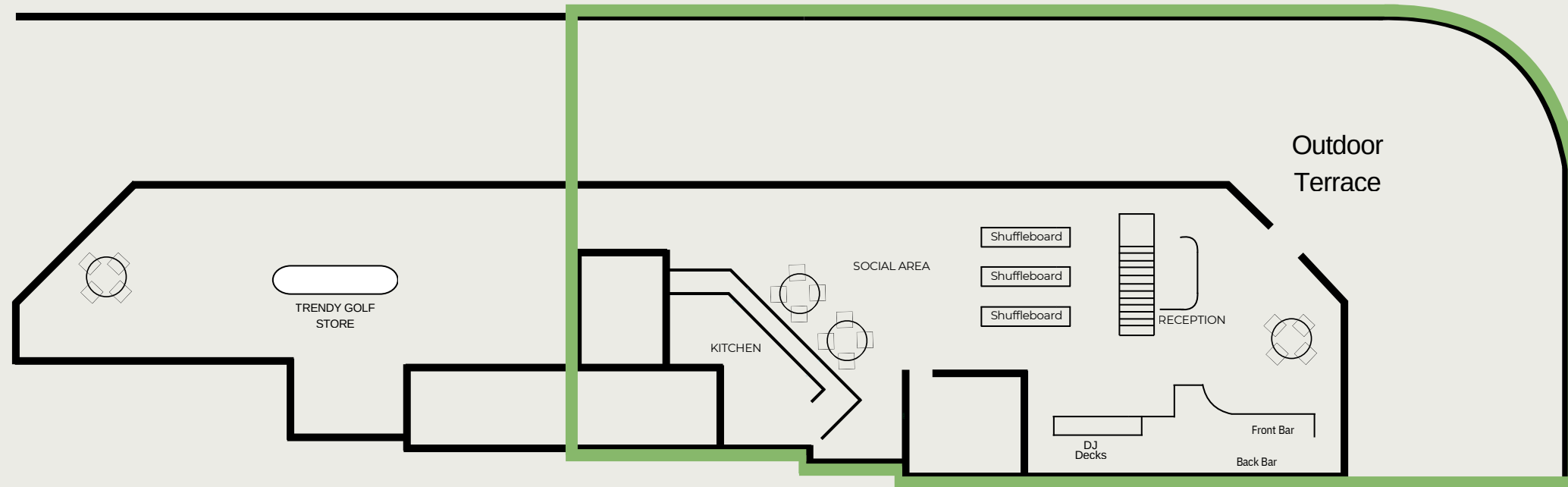

First Floor -->

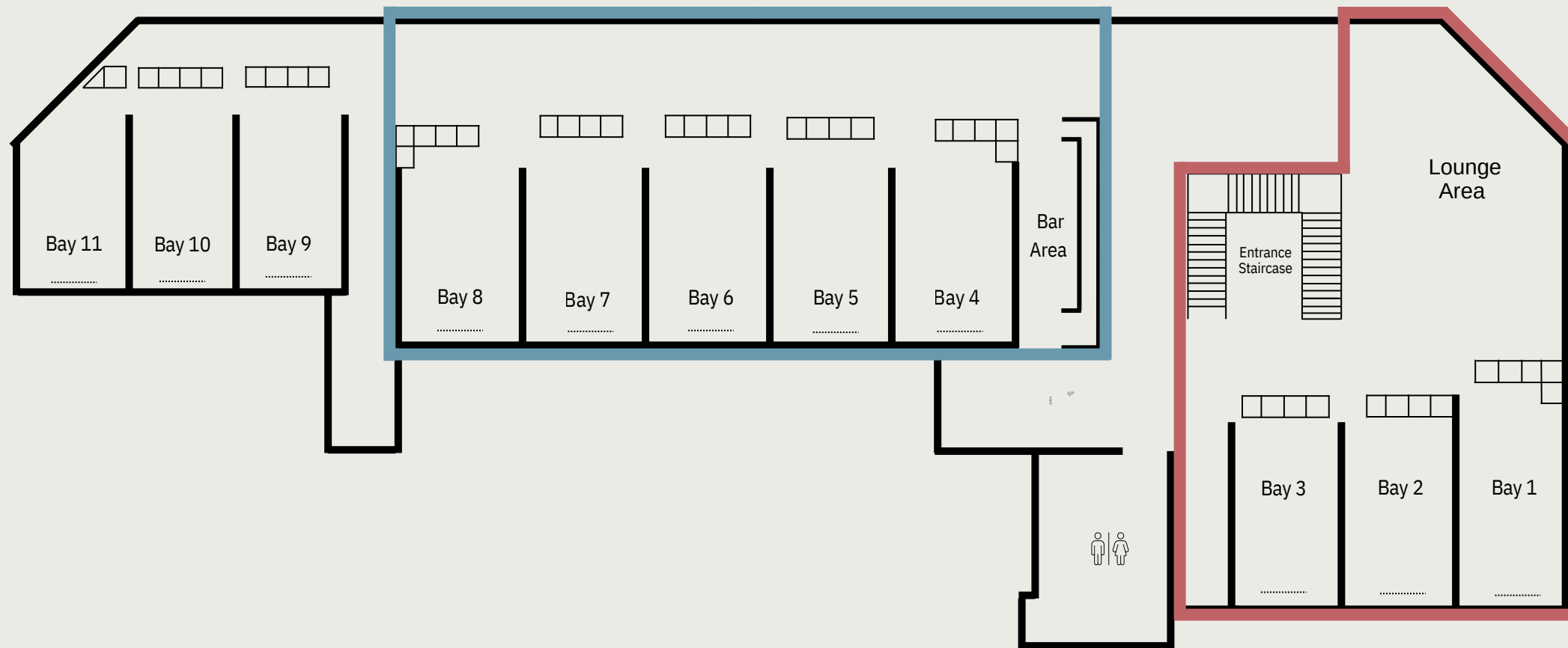

- = Upstairs 5 bays and bar
- = Upstairs 3 bays
- = Downstairs social area



# Shuffleboard Events

Our shuffleboard area and downstairs bar provides the perfect setting for a lively and social event. With plenty of space to play, enjoy great drinks, and soak up the atmosphere, it's the ultimate spot for some friendly competition.

For those of you looking for either an event with a higher capacity or to mix activities to suit all tastes, our "Shuffle social" area is a great option to entertain your guests.

Up to 200 if utilising the outdoor terrace.

To secure the space, a **minimum spend of £5K applies** which will vary depending on the day.



# Shuffleboard Area Hire

Ground Floor -->

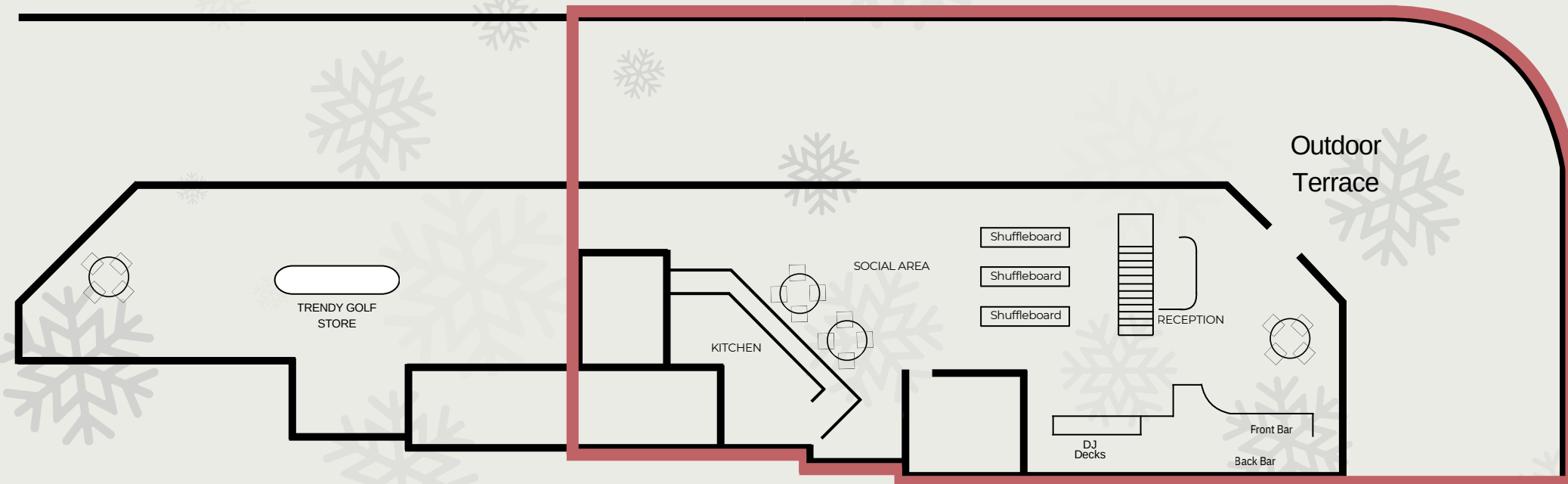

● = Downstairs shuffleboard area and outdoor terrace

# Festive Events Packages

If you want a more bespoke package per person, we have options available for your Christmas do.

For all packages, Pitch will curate a selection of dishes from our menu based on dietary requirements.

## Prancer

£65 per head

2 hours game time

1 dish per person

2 drinks per person

## Dancer

£90 per head

3 hours game time

2 dishes per person

3 drinks per person

## Rudolph

£115 per head

4 hours game time

3 dishes per person

4 drinks per person

*\*Please note, during peak festive periods, minimum spends will apply.*

# Included Drinks

Perfect for those regular team rewards or the more budget conscious. Our events packages cater for all.  
Prices are inclusive of VAT



## PRANCER

Bottled Beers  
Ciders  
Single House Spirits  
House Wines 125ml  
Soft Drinks  
Tea & Coffee



## DANCER

Pints of Beer  
Bottled Beers  
Ciders  
Double House Spirits  
House Wines 175ml  
Soft Drinks  
Tea & Coffee



## RUDOLPH

Pints of Beer  
Bottled Beers  
Ciders  
Double Premium Spirits  
House Wines 250ml  
House Cocktails  
Prosecco  
Soft Drinks  
Tea & Coffee

# Additional Upgrades

Add these additional upgrades to any of our packages to really celebrate in style. As an example, by adding the £12 upgrade to dancer and prancer, you can enjoy our house cocktails.

1.

House cocktail list  
£12 per head

2.

Bubbles on arrival from  
£10 per head



The word "Pitch" is displayed in large, white, illuminated, sans-serif letters across a window. The window reflects the interior of a modern building with a grid ceiling and warm lighting. A green exit sign is visible in the reflection above the letters.

# Contact Us

For any enquiries, please contact Ben Charlesworth  
[bencharlesworth@pitchdn.co.uk](mailto:bencharlesworth@pitchdn.co.uk)

# Canary

30 Churchill Place  
London  
E14 5EU