

EVENTS DECK



71 GREAT TITCHFIELD STREET
W1W 6RB

WHAT IS KAVE?

Kave is London's exciting new Speakeasy.

A secretive unmarked door in Drunch on Great Titchfield Street opens onto one of the Capital's most enticing hidden Kave's descending the stairs the basement boasts one large Kave with vaulted ceiling, bar and DJ desk in center of the room as well as two smaller Kaves under separate arches. The decor juxtapositions the raw 200 year old brickwork with contemporary design and luxurious fixture and furniture. With capacity for up to 80 people, guests can enjoy a mediterranean sharing style menu as well as a range of quirky cocktails accompanied by a state-of-the-art surround sound system playing music of your choice.

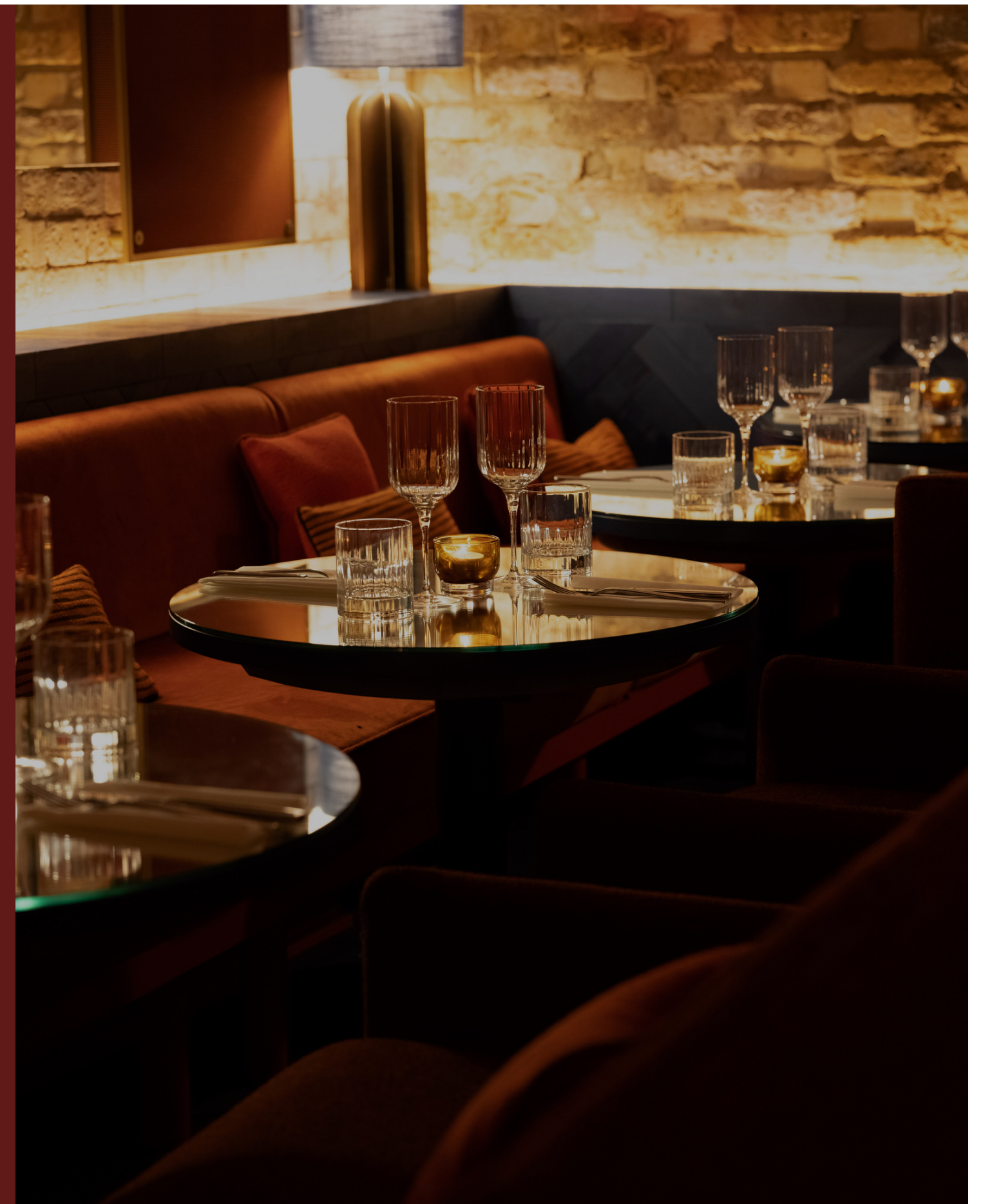

KAVE PRIVATE HIRE

KAVE is a stunning and versatile space, perfect for a range of different occasions. With its dim lighting and vintage-yet classy design, KAVE is the ideal space for corporate events, birthday parties, intimate product launches and networking events. Whether you're looking to have a social dinner or an energetic party, KAVE has it all.





JEMS ROOM

JEMS ROOM

KAVE also features two breakaway vaults perfect for private dining . Jem's room features a large beach bed style sofa alongside customisable tables and chairs and dim lighting.

Capacity - 8



INTIMATE & UNIQUE
SPACE

KAVE

IN THE HEART OF
FITZROVIA

KEFS ROOM

KEF'S ROOM

Kef's room is identical to Jem's room in terms of size - yet features a cosy, rounded sofa encompassing the whole space with a chic orange spider marble table, ambient lighting and surround sound. Ideal for an ambient group dining experience.

Capacity - 7



KAVE LAYOUT

Standing 80

Seating 40

Own Bar

Own DJ Desk

Movable furniture & lighting

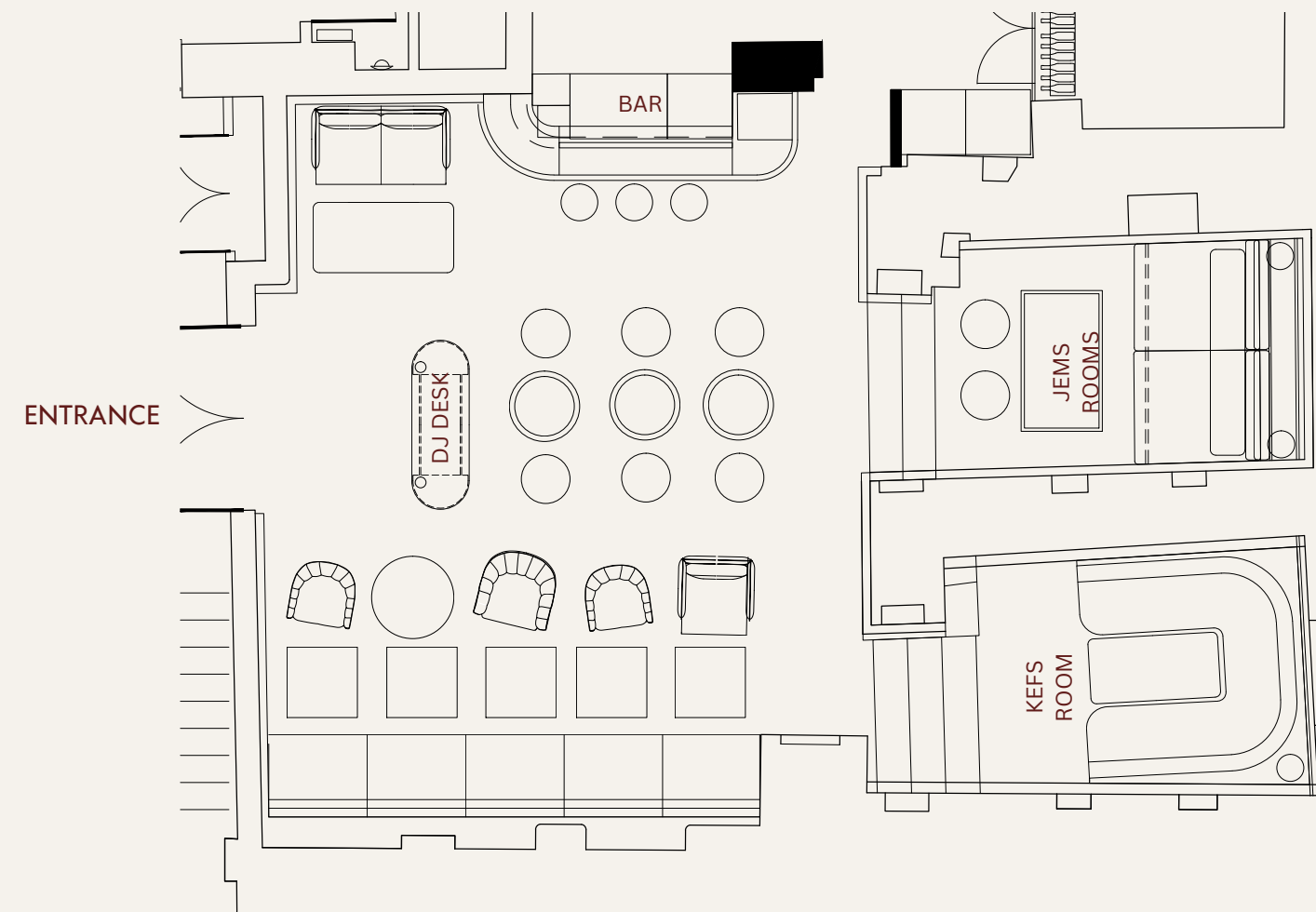

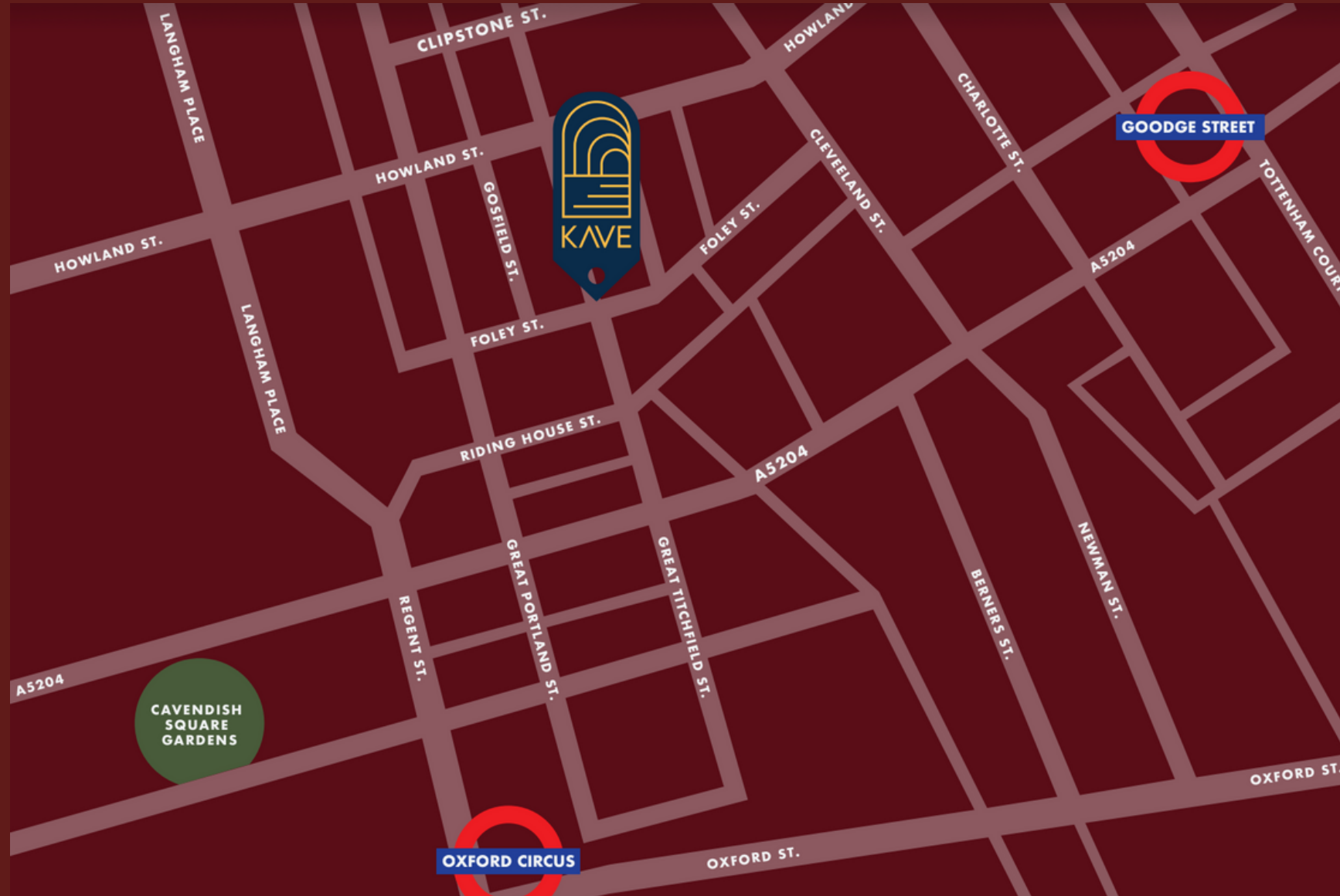

OPENING TIMES

THURSDAY	20:00 – 01:00
FRIDAY	20:00 – 01:00
SATURDAY	20:00 – 01:00

TRAVEL

71 Great Titchfield Street, W1W 6RB, London

Phone Number

+4420 75808075

Website

www.kavelondon.com

Email Address

Info@kavelondon.com