

LOS MOCHIS

LONDON CITY

Private Dining and Events

[@losmochislondon](#) | [losmochis.co.uk](#)

[100 Liverpool St, 9th Floor, London, EC2M 2AT](#) | [Enquire Here](#)

INTRODUCTION

Where Tokyo meets Tulum. Discover the diverse settings of Los Mochis London City, located at 100 Liverpool Street's Broadgate. Our 14,000 sq. ft. restaurant offers stunning panoramic views and a vibrant mix of dining spaces, including a Main Dining Area, Sushi Bar, Agaveria & Lounge, Private Dining Room, Mezzanine Semi-Private Dining Room, and a weather-proof 3,000 sq. ft. Rooftop Terrace.

Perfectly suited to host all manner of events – from corporate breakfasts, birthday dinners, and parties – each area provides its own distinctive ambience.

To enquire about planning your event, please fill out our enquiry form [here](#).

VIEW 360° TOUR



THE DESIGN

Designed by OV&Co, the restaurant blends Mexican and Japanese aesthetics, ideal for gatherings. Earthy tones contrast the modern exterior, creating a warm, inviting atmosphere for events.

The space seamlessly connects areas, with Cherry Chung's woven tunnel providing an immersive touch from the lively Agaveria to the Main Dining sections featuring a bonsai garden, Josefine Winding sculptures, and the serene terrace.

Notable artworks include murals and ceramic masks by Jorge Tellaeche, a renowned Mexican artist, lighting installations by Oms, another prominent Mexican artist, and pop art portraits by muralist Dimitrias Meizar.

VIEW 360° TOUR

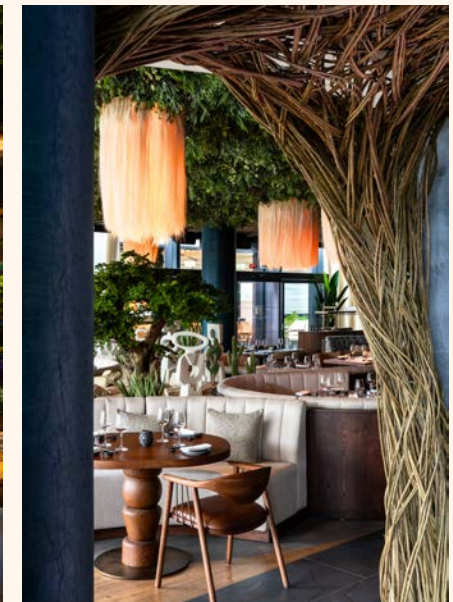

GROUP BOOKINGS, EVENTS & CATERING

Los Mochis London City is an ideal setting for all types of events including private dinners, birthday occasions, and other celebrations.

Our commitment to providing an exceptional experience sets us apart, and we are proud to offer bespoke menus tailored to your specific requirements to ensure a memorable event.

We have multiple areas for events, including an exclusive private dining room, an outdoor rooftop terrace available throughout the year, and a stunning Semi-private Mezzanine, Dining Room, Agaveria Bar and Lounge area.

We also provide catering for small and large events, from catered canapé and cocktail parties at home, the office, or a venue of your choice to menu pairings for private dinner parties.



THE MENU

Mexican and Japanese cuisines are merged seamlessly resulting in complex flavour combinations including fresh sashimi, maki rolls, ceviches, tiraditos, robata grill, and unique tacos. Central to the culinary narrative is a steadfast commitment to utilising the highest quality, seasonal, and sustainable ingredients sourced exclusively from top-tier suppliers.

Designed for sharing, our dishes are entirely gluten, nut, and celery-free. Our main menu contains minimal dairy, allowing you to indulge without compromise.

We offer a range of set menus and canapé options.

View sample group set menus [here](#).

View sample canapé menus [here](#).



THE DINING ROOM

Nestled in the heart of Los Mochis, London City, our dining room is the perfect space for hosting parties, celebrations, and corporate events.

It offers a tailored experience for a standing or seated reception, ensuring every occasion is unforgettable. A dedicated event planner will coordinate every aspect of your experience.

View sample group set menus [here](#).

View sample canapé menus [here](#).

VIEW 360° TOUR

TOTAL SQ FT: 2960

DINING
SEATED: 120
STANDING: 200

MEZZANINE
SEATED: 30
STANDING: 35



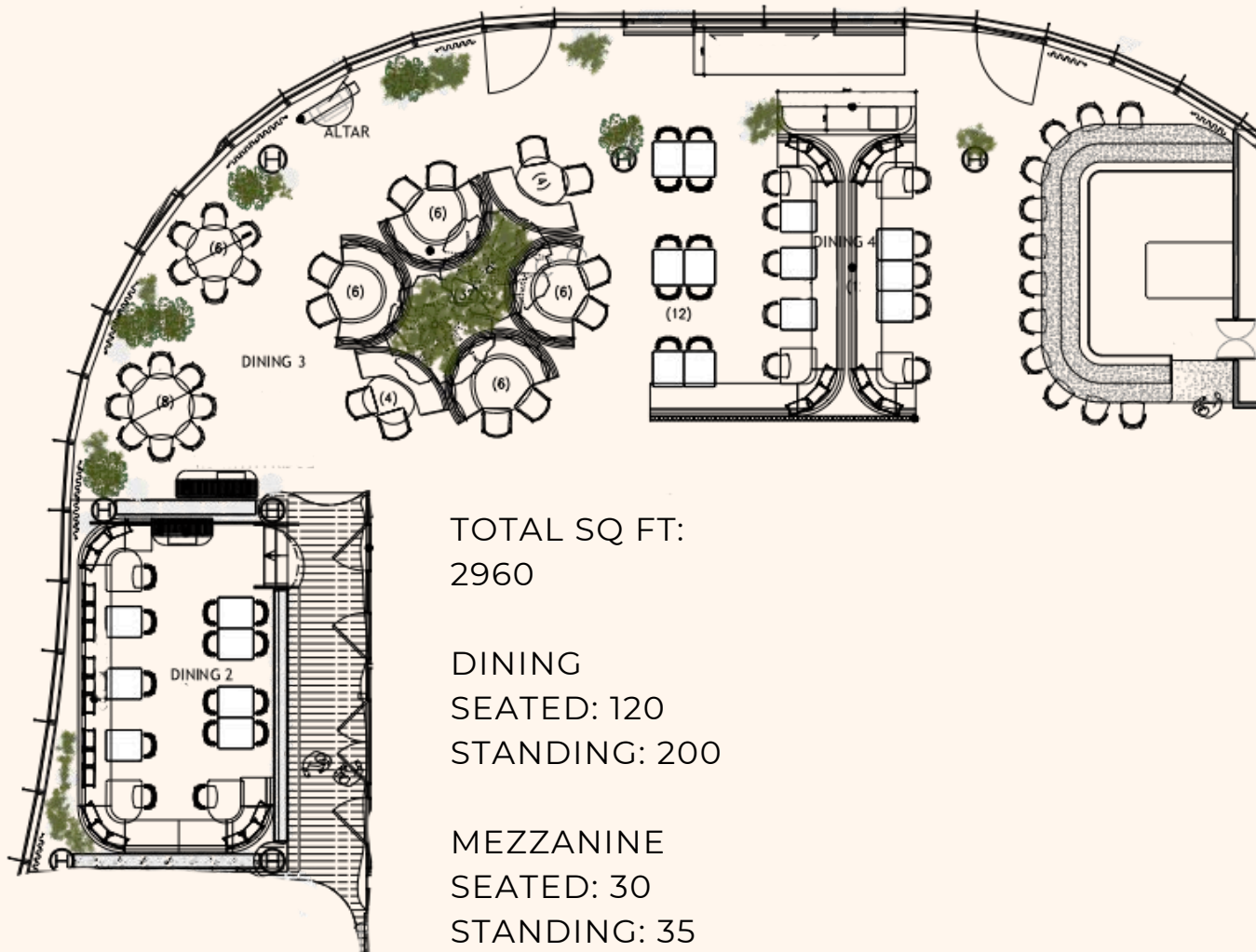

TOTAL SQ FT:
2960

DINING
SEATED: 120
STANDING: 200

MEZZANINE
SEATED: 30
STANDING: 35

DINING ROOM LAYOUT

*All capacities are approximate guidelines and may be subject to change.

MEZZANINE

Los Mochis London City features a chic mezzanine, designed to elevate your celebrations or corporate events with sophistication. This intimate space offers a unique atmosphere, ideal for smaller gatherings.

Attended by a dedicated team, the mezzanine ensures a personalised, memorable dining experience. Guests can savour signature dishes while enjoying the quiet, secluded setting, making it the perfect backdrop for lasting moments.

Menu cards can be printed to your specifications, and we offer complimentary place cards. Bespoke floral arrangements are available at an additional cost.

View sample group set menus [here](#).

View sample canapé menus [here](#).

VIEW 360° TOUR

TOTAL SQ FT: 388

SEATED: 30

STANDING: 35



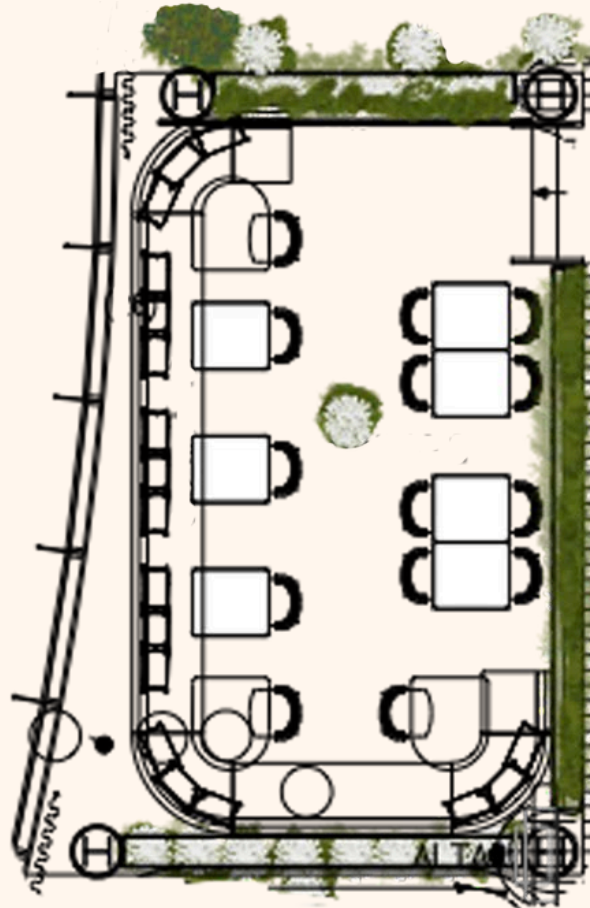

TOTAL SQ FT: 388
SEATED: UP TO 30
STANDING: UP TO 35

MEZZANINE ROOM LAYOUT

*All capacities are approximate guidelines and may be subject to change.

[@losmochislondon](#) | [losmochis.co.uk](#)

[100 Liverpool St, 9th Floor, London, EC2M 2AT](#) | [Enquire Here](#)

PRIVATE DINING ROOM

Los Mochis London City features an exclusive private dining room, perfectly suited to hosting all manner of events and special occasions – from business breakfasts, to celebratory lunches, or birthday dinners. The refined décor and attentive staff ensure a personalised experience for all.

The room includes an integrated screen projector and sound system, allowing you to play your own music or enjoy our provided playlist. Menu cards can be printed and dedicated to your requirements, and we provide complimentary place cards. Floral bespoke arrangements can be provided with an additional cost.

View sample group set menus [here](#).

View sample canapé menus [here](#).

VIEW 360° TOUR

TOTAL SQ FT: 337
SEATED: UP TO 22
STANDING: UP TO 30



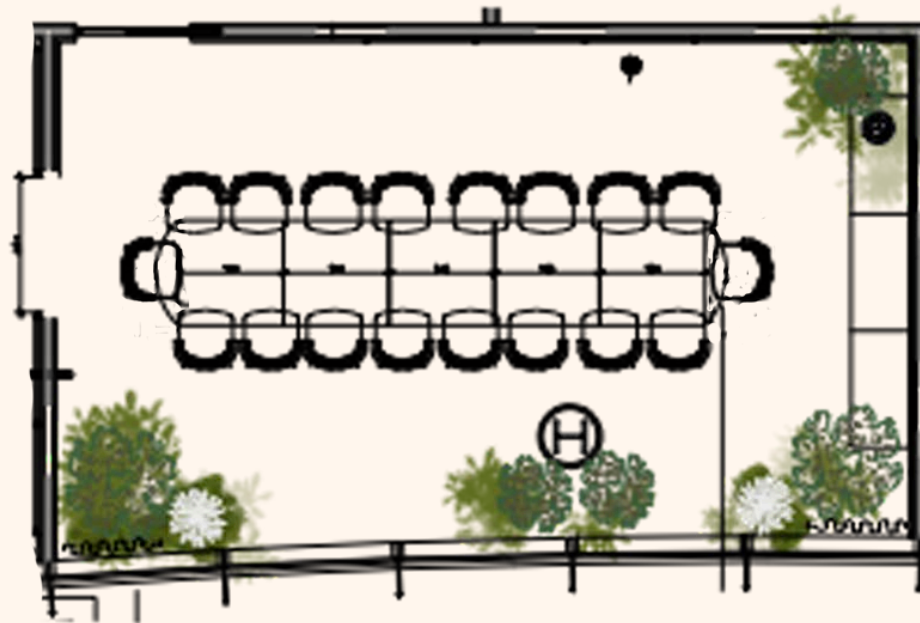

TOTAL SQ FT: 337
SEATED: UP TO 22
STANDING: UP TO
30

PRIVATE DINING ROOM LAYOUT

*All capacities are approximate guidelines and may be subject to change.

[@losmochislondon](#) | [losmochis.co.uk](#)

[100 Liverpool St, 9th Floor, London, EC2M 2AT](#) | [Enquire Here](#)

ROOFTOP TERRACE

The Rooftop Terrace spans 3,000 sq. ft. offering serene, panoramic views of London's skyline, including St. Paul's Cathedral, making it an enchanting setting for your event. Ideal for seated or standing receptions, all-day dining, an extensive cocktail menu, and exclusive agave spirits, sakes, and wines, it's the ideal space for gatherings.

The terrace also features outdoor dining, a bar, and a lounge area, and is fully weather-proof to ensure a warm, inviting atmosphere.

View sample group set menus [here](#).

View sample canapé menus [here](#).

VIEW 360° TOUR

TOTAL SQ FT: 3,000

SEATED: 150

STANDING: 200



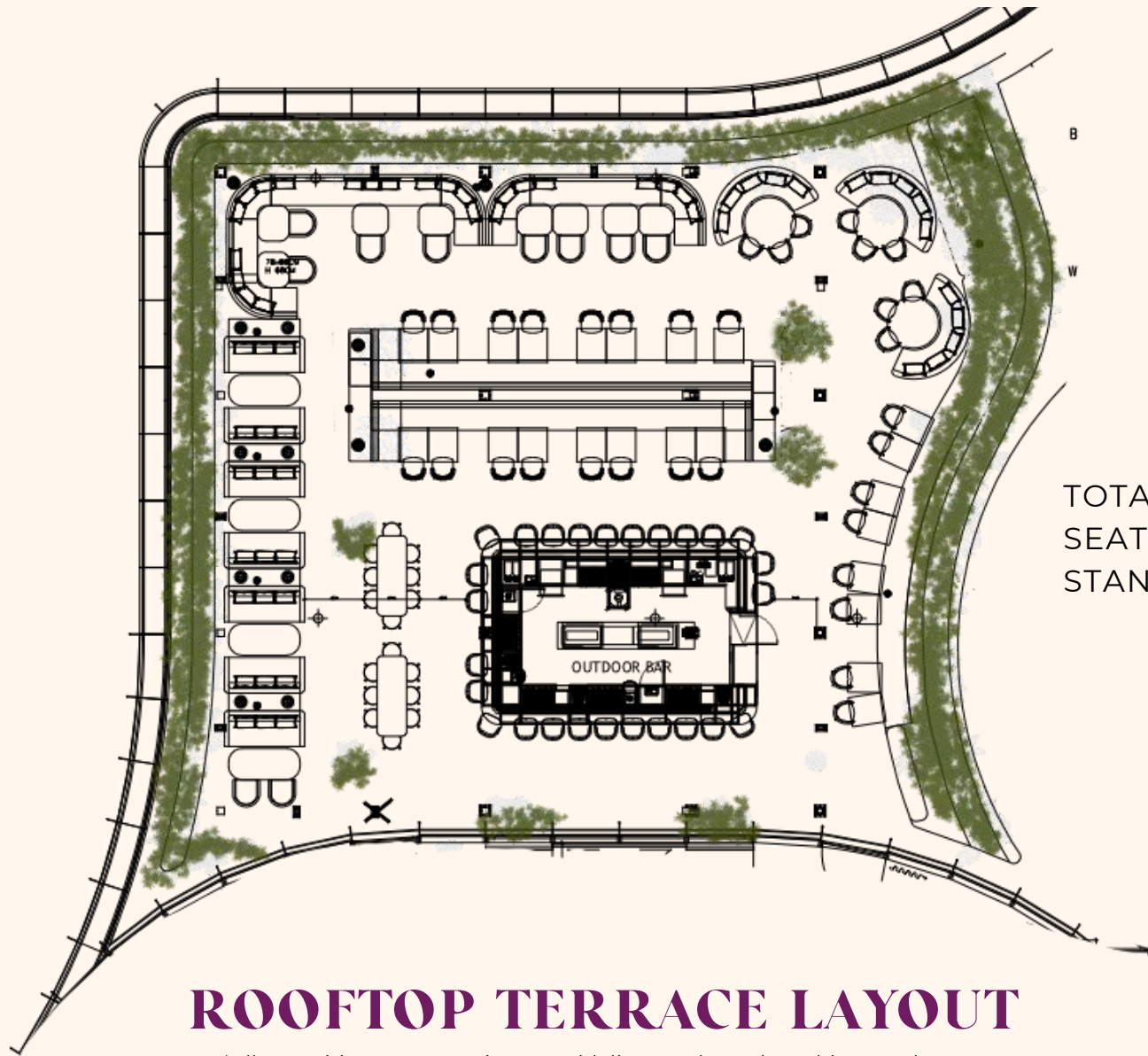

TOTAL SQ FT: 3,000
SEATED: 150
STANDING: 200

ROOFTOP TERRACE LAYOUT

*All capacities are approximate guidelines and may be subject to change.

AGAVERIA & LOUNGE

The Agaveria Bar is a refined destination, perfect for celebrations or corporate gatherings. Ideal for seated or standing receptions, the space boasts one of Europe's largest collections of fine and rare tequilas and mezcal, offering a curated selection of artisanal agave spirits.

The surrounding lounge area also creates a cosy, stylish atmosphere. Our resident DJ sets the tone, beginning with smooth lounge tunes and building to high energy beats.

View sample group set menus [here](#).

View sample canapé menus [here](#).

VIEW 360° TOUR

TOTAL SQ FT: 3,120

SEATED: 150

STANDING: 200

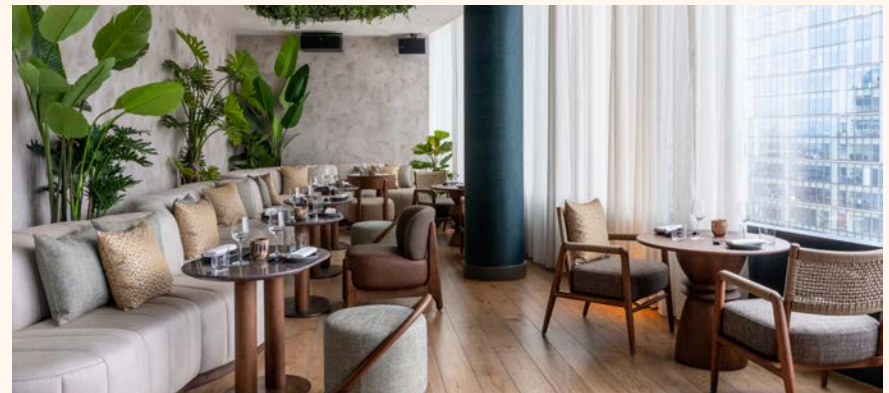

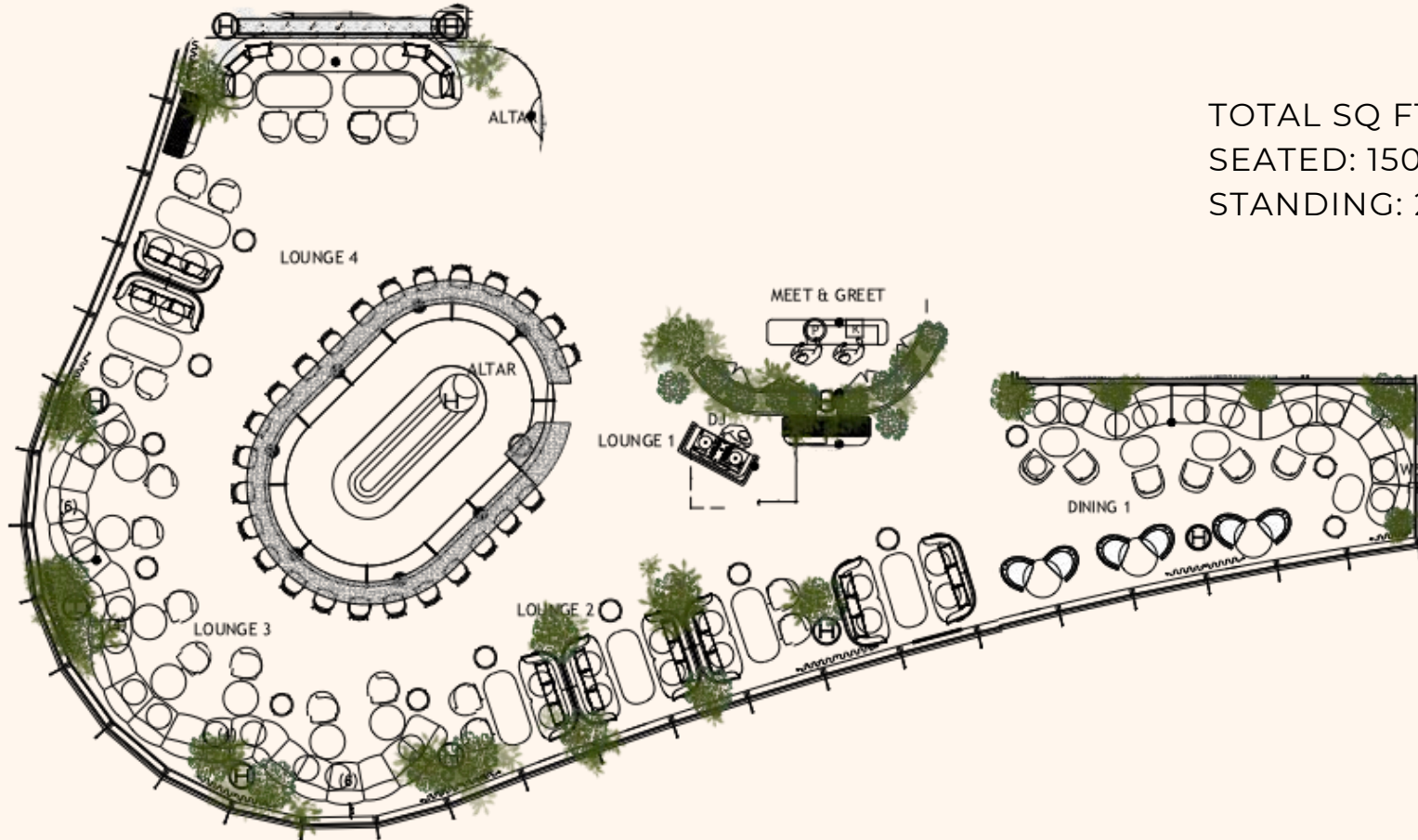

TOTAL SQ FT: 3,120
SEATED: 150
STANDING: 200

AGAVERIA & LOUNGE LAYOUT

*All capacities are approximate guidelines and may be subject to change.



TOTAL SQ FT: 14,000
SEATED: 472
STANDING: 665

FULL VENUE LAYOUT

*All capacities are approximate guidelines and may be subject to change.

FAQ'S

Do you offer private or semi-private hire?

Yes, subject to availability, we can offer both semi and full private hire.

Do you have set menus for events?

We have a variety of set menus for all group bookings and events of 12 or more guests. These are specially curated set menus designed to contain all of our signature Los Mochis London City dishes, as well as some of our other most popular items.

Do you have music?

For an exclusive private hire, we will provide a DJ for your event.

Can we bring an occasion cake?

As we are a nut free restaurant, we cannot allow cakes from outside. However, we do have an in-house pastry team that can provide a variety of options.

Do you take a deposit?

For all group bookings, we require a 50% deposit to secure the booking for you.

Do you have a cancellation policy for group bookings?

For groups of 12 up to 30 guests, our cancellation policy is 14 days. Our events team can assist you with further information on cancellation policies for over 30 guests.

Do you have a dress code?

Our dress code is smart elegant. Smart trainers are permitted; however, tracksuits, gym attire, flip flops/sliders or beachwear are not allowed.

FAQ'S

Do you allow decorations?

For the festive season, we will have themed decorations. We kindly ask that no external decorations or branding, including balloons, be brought into the venue.

Can you cater for my allergies?

We are a gluten, nut and celery free restaurant. For all other allergen information, please contact the events team.

Do you allow corkage?

We do not have a corkage policy.

Do you accept cash?

We do not accept cash, however, we do accept all forms of card payment except for Diners.

Do you provide catering?

For catering enquiries, please email our events team.

Are you wheelchair accessible?

Our whole restaurant is wheelchair accessible.

THE LOCATION

Our entrance resides opposite the Liverpool Street Elizabeth Line tube entry. We offer two elevators up to the 9th floor, for ease of access and we are fully wheelchair accessible.

Taxi drop-offs can be made at the corner of Liverpool Street and Old Broad Street, with a short walking distance to our location at 100 Liverpool Street. Our nearest taxi rank is located at Liverpool Street Station.

Our nearest underground tube station is Liverpool Street, conveniently located on the Elizabeth, Central, Circle, Hammersmith & City, and Metropolitan lines.

CONTACT

PHONE +44 (0) 20 7225 2502

EMAIL events@losmochis.co.uk

WEBSITE losmochis.co.uk

ADDRESS 100 Liverpool Street, 9th Floor,
London, EC2M 2AT

INSTAGRAM [@losmochislondon](https://www.instagram.com/losmochislondon)

CONTACT [Enquire Here](#)

