



CLIVEDEN



MEETINGS AND EVENTS



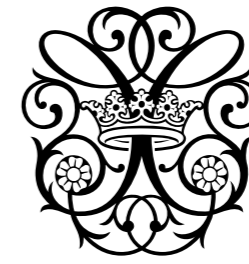
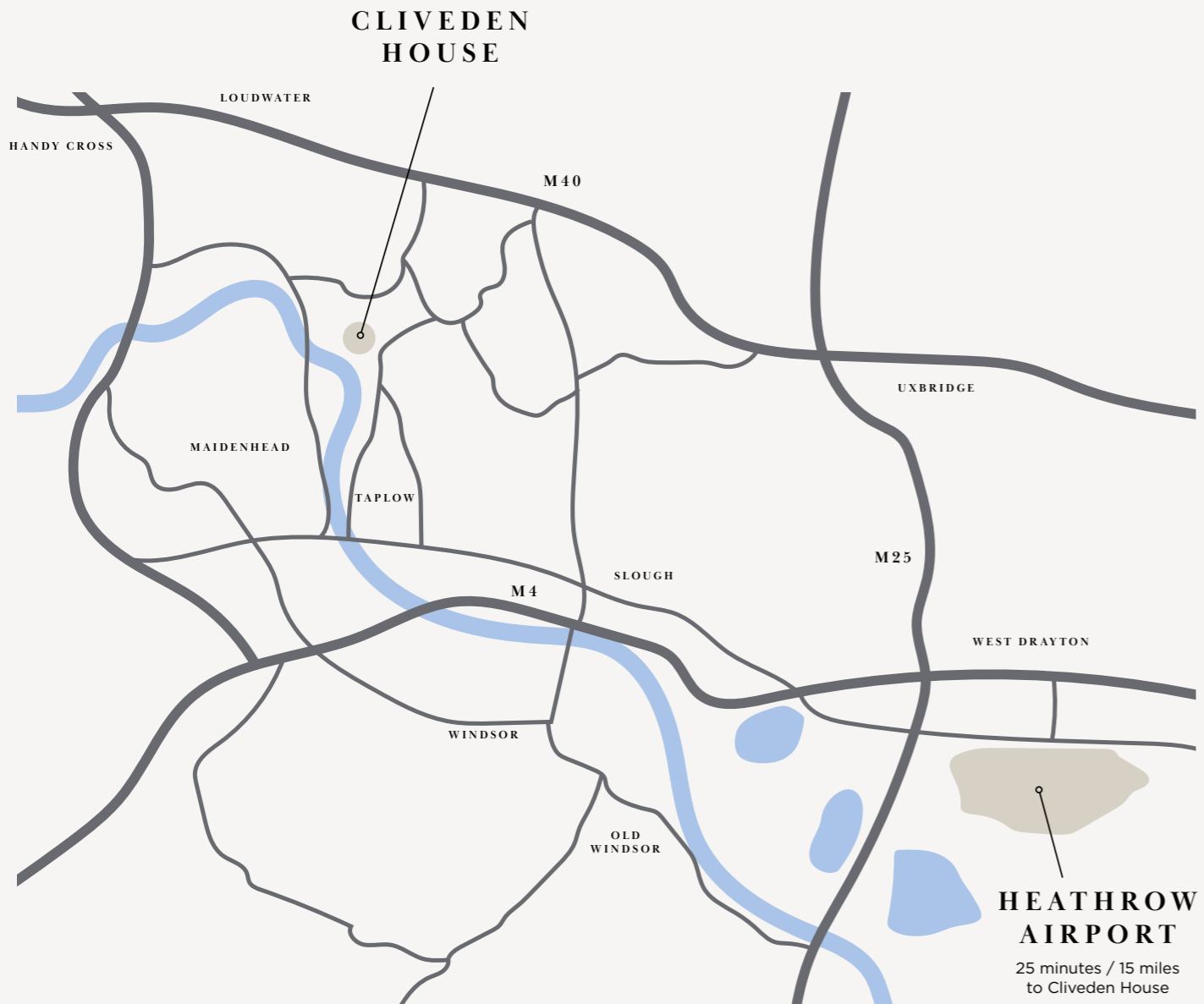

## CLIVEDEN

### MEETINGS AND EVENTS

#### HOST AT CLIVEDEN HOUSE

For over 200 years, the elite has hosted at Cliveden. Join the likes of historical figures such as Chaplin, Churchill, Lennon and Lawrence in hosting your own spectacular meeting or party in our elegant and opulent private rooms.

#### ORGANISE A MEETING

The meeting of minds at our stately home. Whether you're simply looking for a venue to host a business meeting or are wishing to impress your guests with our 5-star facilities, Cliveden House has everything you need and more.

#### PLAN A PARTY

Decadent celebrations have long been linked to our prestigious grounds. Hold your own private event at our venue, complete with unique personal touches and exquisite extravagance.

## CLIVEDEN FLOORPLAN

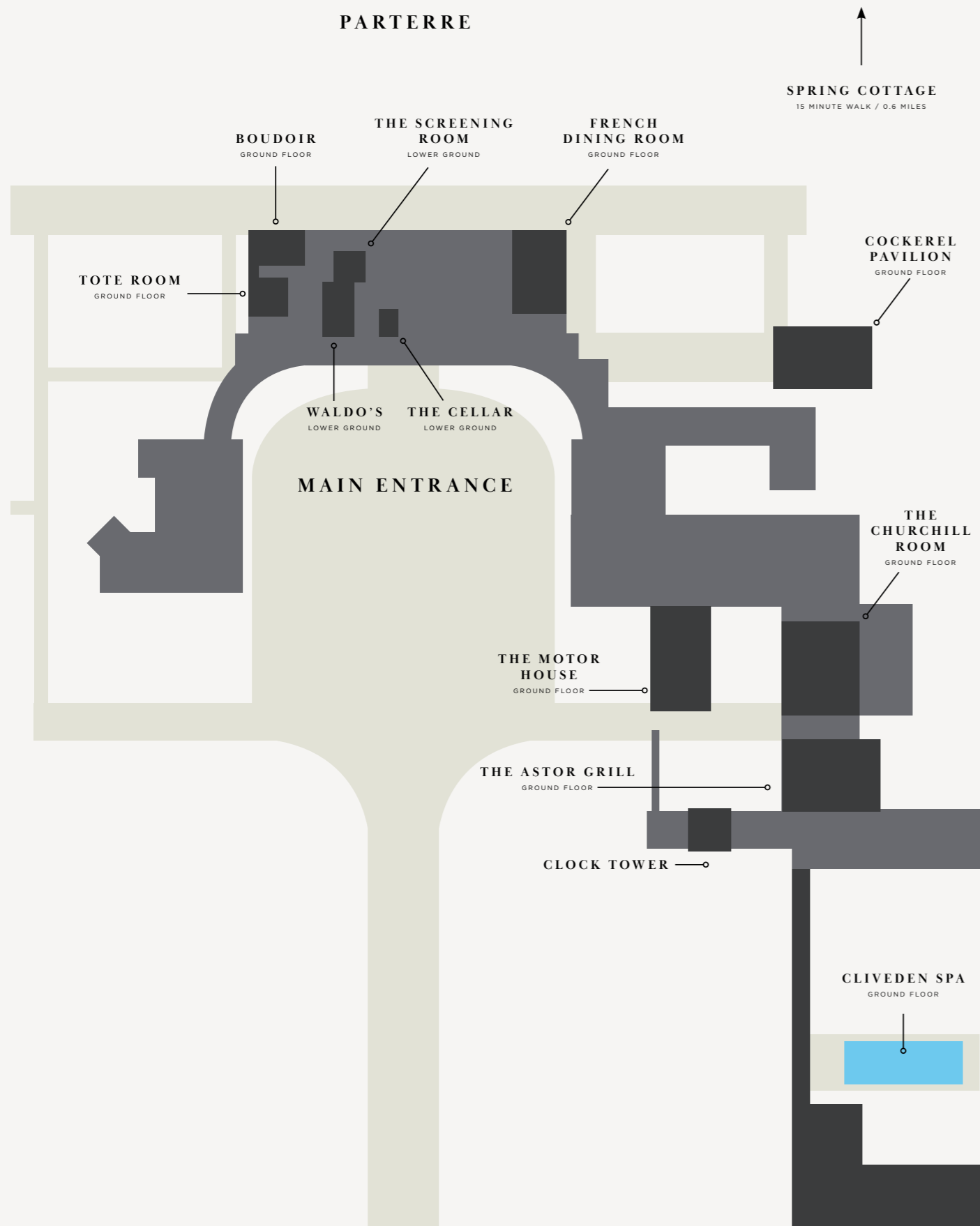

## DAY DELEGATE RATES

Prices available on request

### OUR DAY DELEGATE PACKAGE INCLUDES:

- Full day use of meeting room including set up
- Complimentary Wi-Fi throughout the day
- Dedicated Conference Events Manager
- Use of the hotel's audio-visual equipment including screen, projector and a flipchart
- Arrival, morning and afternoon, tea and coffee breaks with homemade treats
- Mineral water in the meeting room
- Working buffet lunch
- Valet parking for all delegates on arrival
- Service charge

**Minimum 6 delegates / Up to 50 delegates.\***

*A trip to Cliveden would not be complete without a leisurely stroll around the beautiful 376 acre estate. An additional charge of £2 (£18 for guests staying the night) is levied by the National Trust for all guests visiting Cliveden House although if you are already a National Trust member there is no extra charge.*

## 24 HOUR PACKAGES

(includes all day delegate items listed above)  
Prices available on request

### OUR 24 HOUR DELEGATE PACKAGE INCLUDES:

- Three course gourmet dinner, excluding beverages
- Luxurious accommodation in one of our beautifully appointed rooms
- Full English breakfast in The Cliveden Dining Room
- Room upgrades subject to availability
- Use of The Spa wet areas, fitness suite, indoor tennis and squash courts

**Minimum 6 delegates / Up to 48 delegates\***

\* If all bedrooms are required, please discuss your requirements with our Events team

Please contact [special.events@clivedenhouse.co.uk](mailto:special.events@clivedenhouse.co.uk) for competitive group rates.

*\*For larger, corporate events and meetings over 50 delegates where both privacy and space are important, use of Cliveden will be required on an exclusive basis, this then allows for greater flexibility and scope for creating unique and inspiring events.*

# Menus

## RECEPTION DRINKS MENU

- Prosecco £48.00 per bottle
- Laurent Perrier NV £85.00 per bottle
- Laurent Perrier Rose NV £125.00 per bottle
- Non-alcoholic cocktails £9.00
- Cocktails from £16.00
- Champagne Cocktails from £21.00
- Jug of Pimm's £75.00
- Soft drinks from £4.50
- Beers from £8

## STARTERS

- Salmon Rilette**  
*pickled crab apples, mizuna, watercress*
- Game Terrine**  
*onion jam, brioche, blackberries*
- Pumpkin Dumpling (P)**  
*pine consommé, walnuts, cranberries*
- Jerusalem Artichoke Risotto**  
*tonka bean, sunflower seeds*
- Gin-Cured Halibut**  
*fermented black grape, fennel*

## MAINS

- Roast Creedy Carvery Chicken**  
*mash, cranberry stuffing*
- Roasted Bass**  
*borlotti beans, squid, confit lemon*
- ChalkStream Trout**  
*Cornish fish stew, saffron*
- Truffle Risotto (V)**  
*winter truffle, balsamic and wild mushroom*
- Best of Brassicas (P)**  
*roast cauliflower, romanesco, caper raisin salsa*

## DESSERTS

- Dark Chocolate Mousse**  
*beetroot ice cream*
- Apple Cheesecake**  
*lime and poppyseed*
- Pineapple Carpaccio (P)**  
*coconut custard, coconut sorbet*
- Salted Caramel Cake**  
*white chocolate sorbet, honeycomb*
- Baked Yoghurt**  
*cranberry, ginger biscuit*
- Selection of Cheeses**  
*onion chutney*
- Tea, Coffee and Bon Bons**

*Menus serve as visual representations and are subject to alterations based on seasonal variations. Current menus can be provided upon request.*



## ACCOMMODATION

Extend your stay and immerse yourself in the full spectrum of experiences Cliveden has to offer. Our array of 47 generously appointed rooms and suites ensures the utmost comfort and relaxation throughout your visit. Graced with exquisite craftsmanship, captivating interiors, and opulence, your guests will relish in timeless elegance during your event.





# Exclusively Yours...

One of the finest venues in the UK. With a history as the private party house of the elite, ours is the perfect venue for your exclusive event.



## THE FINER DETAILS:

- A venue featuring dining rooms, event spaces and lounges flexible for your requirements
- A basement wine cellar that can be adapted
- A house that can be uniquely decorated for any theme or occasion
- A private screening room
- Unique gifts for hosts and guests
- A downstairs area perfect for an evening event or even a night club
- 48 luxurious bedrooms and suites (up to 90 guests)
- Spring Cottage, a secluded retreat within the grounds on the banks of the River Thames (6 guests)
- Use of The Spa

## SPECIAL TOUCHES:

Valet parking, Red carpet welcome, House flowers, All staff dedicated to your event

## CONTACT:

Please contact [special.events@clivedenhouse.co.uk](mailto:special.events@clivedenhouse.co.uk) for competitive rates.

For larger, corporate events and meetings over 50 delegates where both privacy and space are important, use of Cliveden will be required on an exclusive basis, this then allows for greater flexibility and scope for creating unique and inspiring events.



# HORSE POWER, GUN POWDER, CLIVEDEN QUEST AND OLYMPIC GOLD

Perched high on the cliff with spectacular views across the Thames Valley, Cliveden has long been a playground for the lifestyles of the royal and rich, and the famous and powerful. Experience the good life with exclusive adrenaline-fuelled activities within easy reach of the estate.



## POLO

Berkshire is the home to many of the most prestigious polo clubs in the UK. Set in the beautiful countryside, a short drive from Cliveden, these privately-owned estates offer an exclusive insight into the world of polo and provide the perfect backdrop to a welcoming and exhilarating introduction to this quintessential sport. Be it as a learn-to-play experience or an entirely bespoke activity, these superb facilities operate throughout the year offering polo during both the summer as well as high-adrenaline arena polo in the winter months. No previous riding experience is necessary.



## SUPERCARS

Cliveden can offer you access to a range of the world's top supercars including the Lamborghini Huracan Spyder, Ferrari 458 Spider, Aston Martin V12 Vantage, Lamborghini LP570 Performante, Ferrari California, Bentley GTC V8, Mercedes GT AMG, Maserati GranCabrio Sport and Range Rover Vogue Autobiography, to name but a few. Enjoy the thrill of driving your chosen supercar, either on a pre-selected route or to a destination of your choice. Packages range from short driving experiences to full day excursions tailored to your preferences. Self-drive hire is available to all guests and can be arranged for 24 hours or more.



## CLASSIC CAR TOUR

A Classic Car Tour is the perfect way to explore the fascinating area surrounding Cliveden House, showcasing the best routes and stunning scenery with stops in Marlow, Cookham or Henley on Thames. There is an exquisite range of classic British, German, Italian and American cars to choose from - each a piece of motoring heritage and history telling its own special story. The cars are available as either self-drive or chauffeured, and the event can include gourmet picnic hampers and competitive challenges.



## SHOOTING OFF PROPERTY

The names Holland and Holland and E. J. Churchill have been synonymous with the finest handmade English shotguns for over 150 years and you can enjoy a visit to these prestigious gunmakers' award-winning shooting grounds. Set amidst acres of stunning woodland, both sites are just 30 minutes from Cliveden and feature over 100 clay shooting stands offering a variety of shooting disciplines. The dedicated team of instructors are amongst the most experienced in the country and provide clay pigeon shooting instruction for novices through to experienced game and clay shooters.



## ESCAPE TO THE LAKE

Set in scenic parkland a short drive from Cliveden, Dorney Lake is a world-class sporting venue with an exceptional heritage offering a stunning backdrop for a customised event. Home of the British Olympic Rowing Team where Team GB famously won a total of 9 medals in 2012, Dorney Lake is an inspiring location for water-based team events in which your participants will be compete for their own sporting glory. Join the ranks of the finest sporting heroes and challenge your team to strive for success at Dorney Lake - team activities include various rowing disciplines, dragon boat racing or, if you like it wet and wild, raft building. If you prefer to stay dry, you can enjoy country sports, treasure hunts or Olympic-style challenges on the venue's 400 acres of grounds, or combine both land and water with an exciting triathlon. Join the ranks of the finest sporting heroes and challenge your team to strive for success at Dorney Lake. Events can be combined with a lake-side lunch or a visit to nearby Windsor.



## THE CLIVEDEN QUEST

The Cliveden Quest is engaging, fun and competitive. Embracing the history of the Grade I listed estate, using your smartphones and an interactive game app, you will be sent back into time on a mission to complete as many challenging questions and tasks as you. Navigate with your team via interactive hotspots and get the chance to explore the estate's spectacular gardens and grounds, whilst going up against the clock to complete the contest.



## THE ITALIAN JOB

In this fast-paced treasure hunt on wheels the group will be briefed on the challenge ahead and then split into teams of four. Provided with the keys to their own Mini Cooper, and a briefcase containing a Nexus 7 tablet with built-in GPS and a cache of cryptic clues, each team will set off on a mission of daring and intrigue, encountering some 'dangerous' characters along the way. Intelligence, creativity and teamwork are required in order to complete as many challenges as possible and pull off the ultimate 'job'! Teams will literally 'blow the bloody doors off' to get to the gold at the conclusion of this high-energy, laugh-out-loud event.



## 4X4 EXPERIENCE

Departing from Cliveden House you can enjoy an exciting off-road driving experience on the stunning 100-acre grounds of nearby Hedsor House. The estate's mile-long track offers the ideal off-road challenge, either as a stand-alone event or as part of a wider activities programme.



THE FRENCH  
DINING ROOM





## THE FRENCH DINING ROOM

The French Dining Room is one of the most exquisite and dazzling rooms in the House, filled with light and beautiful views of the river and Berkshire countryside. On a visit to Paris in 1897 William Waldorf Astor was shown the intricate gilded panelling in Madame de Pompadour's 18th century dining room at the Château d'Asnières. Realising the proportions exactly matched those of the dining room at Cliveden he bought the panelling, table and chairs, then had the entire room reconstructed in his home. Seating up to sixty guests, this Rococo masterpiece provides an incomparable setting for a romantic wedding breakfast, impressive lunch or sumptuous dinner.

### CAPACITIES

Boardroom	28	Reception	80
Dining	60	Theatre	80
U-Shaped	26	Cabaret	24

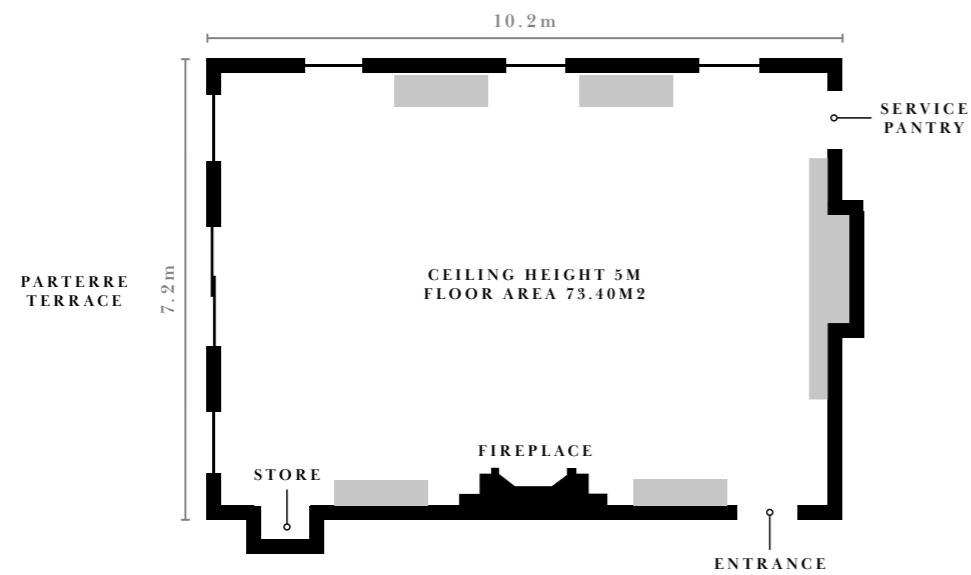



## THE CELLAR DINING ROOM

A unique underground venue with a difference. Once Lord Astor's private wine cellar, the Cellar Dining Room has been beautifully restored and is perfect for a more intimate, informal setting. It has brick walls, mighty pillars and a vaulted ceiling, creating an unusual and atmospheric dining room for smaller parties and private gatherings. It's also perfect for hosting wine tastings.

### CAPACITIES

12 on one rectangle table

Height 3.5m

Width 5.2m

Length 5m







## CHURCHILL BOARDROOM

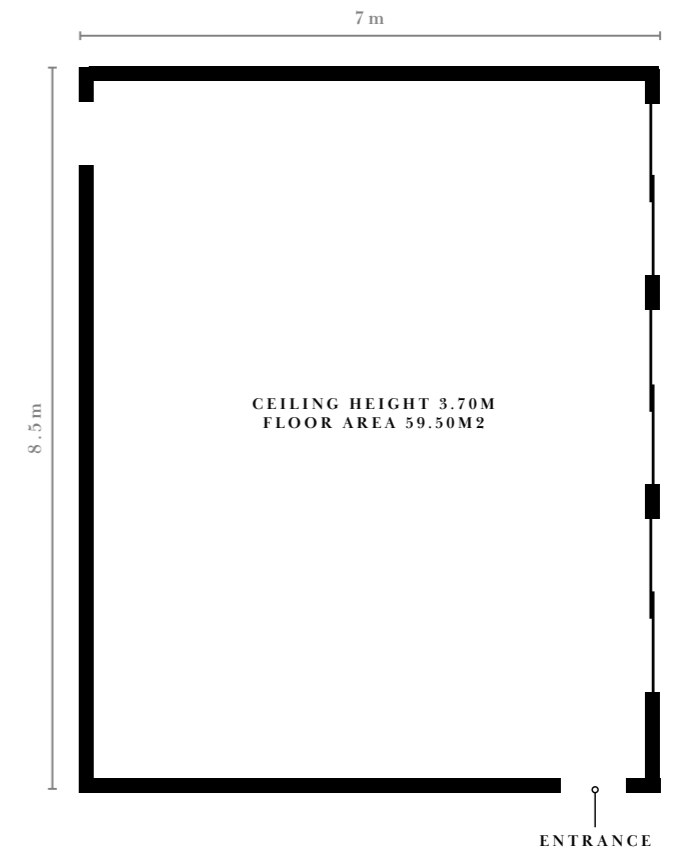

Winston Churchill was a regular guest at Cliveden in Nancy Astor's era, and although they did not often agree, we think they would thoroughly approve of the Churchill conference facilities which have been built in the cobblestoned Clocktower Courtyard, adjacent to The Astor Grill restaurant. This bespoke meeting room is situated in the former mews garage complex. Equipped with the latest technology and plenty of natural daylight there is also parking close by.

### CAPACITIES

Boardroom	24
Terrace BBQ	40
U-Shaped	28
Reception	50
Theatre	50
Cabaret	28



## BOUDOIR AND TOTE ROOM

The Boudoir and Tote Room are located on the ground floor of the House, and were the respective interconnecting sitting rooms of Lady and Lord Astor. As such they follow distinct but complimentary styles - the Boudoir is romantically decorated in blue drapes with large windows overlooking the Parterre and lawn, and the Tote is a smaller room with comfortable furniture around a cosy fireplace. Both rooms are available for private functions, and are perfect for meetings, dining, afternoon tea or private events.

### CAPACITIES BOUDOIR

Boardroom	14
Dining	24
U-Shaped	15
Reception	20
Theatre	30

### CAPACITIES TOTE ROOM

Boardroom	6
Dining	10
U-Shaped	6
Reception	10
Theatre	10

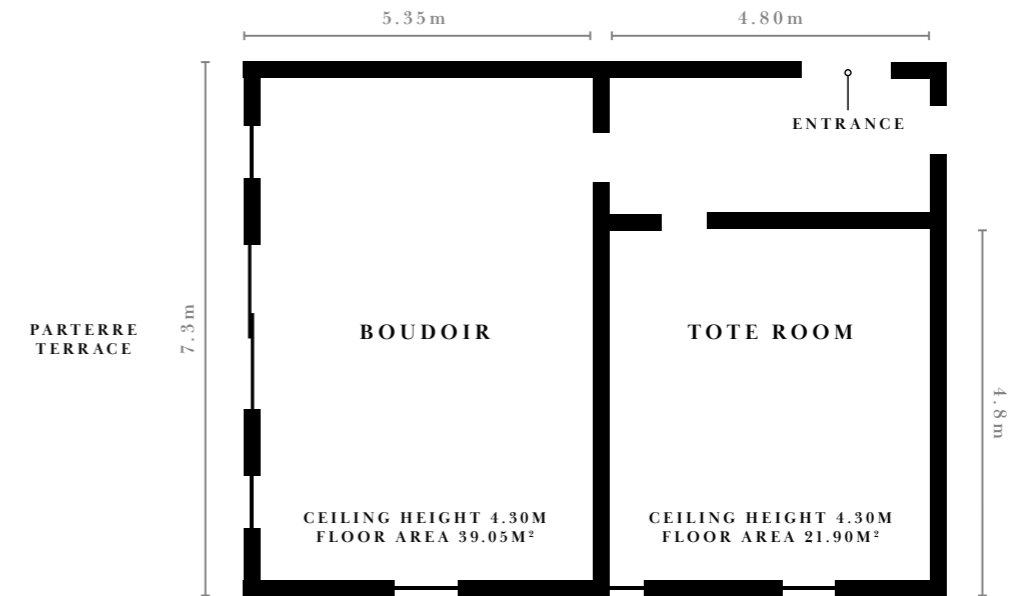



## WALDO'S

Set in the House's former servants' quarters, Waldo's comprises two interconnecting modern function spaces for meetings and private dining.

With natural daylight, air-conditioning and complimentary Wi-Fi, the beautiful rooms feature a fireplace and many paintings highlighting Cliveden's heritage and history.

### CAPACITIES

#### FRONT ROOM

Width	5.4m
Length	7.15m
Boardroom	14
U-Shape	14
Theatre	24
Cabaret with AV	16
Dining (round tables)	20
Dining (oval tables)	20
Drinks Reception	20
Relaxed Informal	18

#### BACK ROOM

Width	5.3m
Length	7.2m
Boardroom	22
U-Shape	16
Theatre	48
Cabaret with AV	18
Dining (round tables)	30
Dining (oval tables)	20
Drinks Reception	40
Relaxed Informal	18







## THE SCREENING ROOM

The state-of-the-art Screening Room is ideal for impressive presentations or festive movie nights. Interconnecting perfectly with Waldo's, the room is fitted with the latest technology combining efficiency and ease of use with the elegance and unparalleled luxury that are the hotel's trademarks.

### CAPACITIES

Width	7.2m
Length	7.7m
Boardroom	18
U-Shape	16
Theatre	60
Cabaret with AV	24
Dining (round tables)	40
Dining (oval tables)	22
Drinks Reception	50
Relaxed Informal	18



## THE MOTOR HOUSE

A versatile meeting space, The Motor House is a bespoke conference and banqueting room accessed via the cobblestoned Clocktower Courtyard. Adjacent to The Astor Grill, it was formerly the garage for Lord Astor's beloved Rolls Royce collection. This delightful private room works perfectly alone, or in combination with the Churchill Boardroom located opposite.

### CAPACITIES

Boardroom	26
U-Shape	24
Theatre	50
Cabaret with AV	28
Relaxed	16
Reception	50
Width	5.8m
Length	10m







SPRING COTTAGE





## UNRIVALLED PEACE AND SECLUSION

Spring Cottage takes its name from the spring that emerges in the nearby chalk cliffs and was originally built as a summerhouse by the Duke and Duchess of Sutherland. It became the much trusted meeting place of Queen Victoria and the Duchess and it was here that the two esteemed ladies would take afternoon tea whilst watching the world float by.

Secluded in its own grounds on the banks of the Thames, Spring Cottage allows for a corporate retreat like no other. Complete with a fridge full of provisions, the Cottage provides a peaceful sanctuary and secluded hideaway perfect for meetings and events. The gothic Tea Room is the main entertaining room and its magnificent architecture and fan-vaulted ceiling provides a truly special setting, whilst the country kitchen is perfect for dining for up to 6 guests. A private chef and your own personal butler can be arranged upon request (additional charge applies). Within the Cottage's private grounds is a jetty, perfect for boarding one of Cliveden's beautiful vintage launches for a champagne cruise with a luxury hamper.

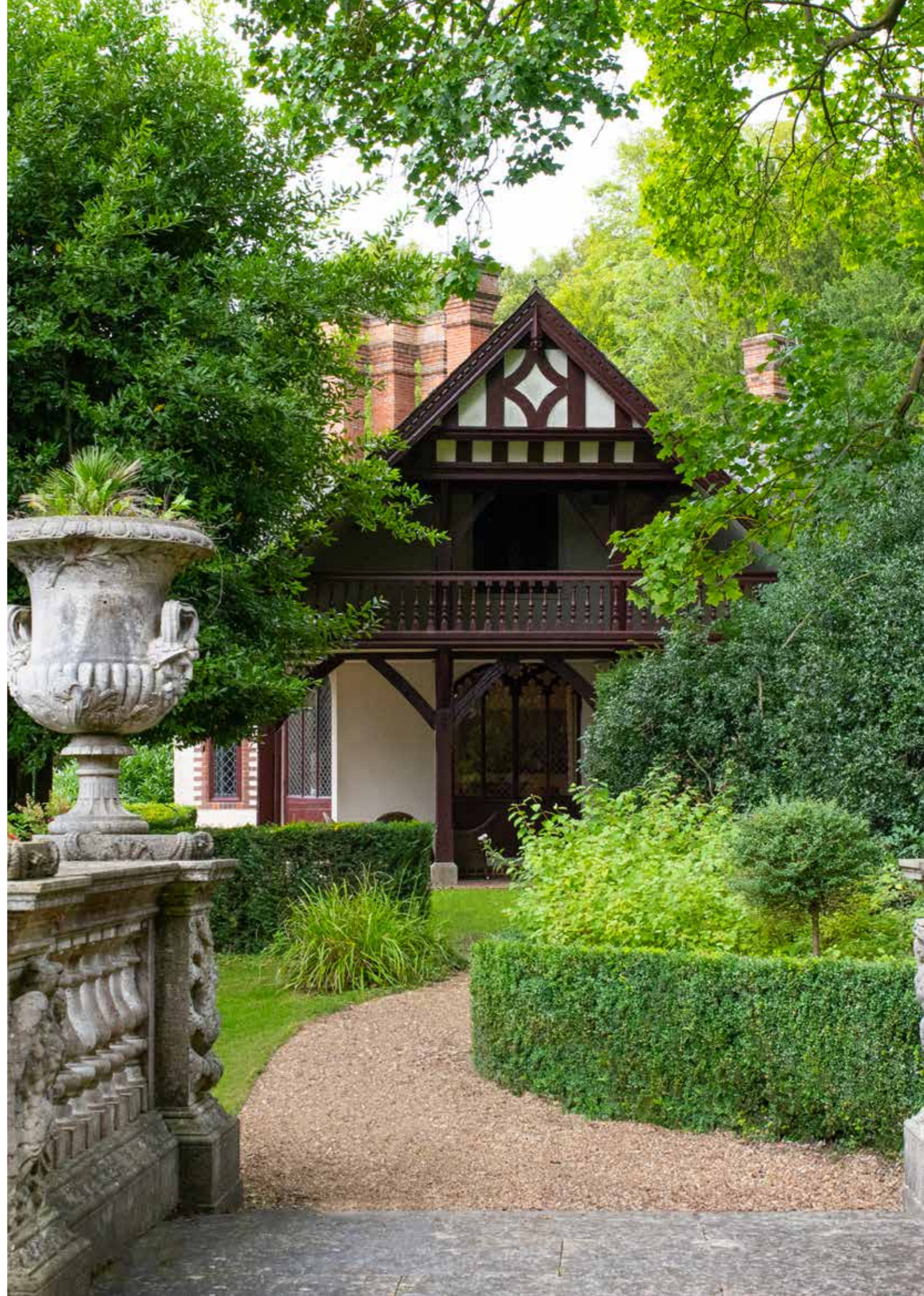





CLIVEDEN

**ENQUIRE NOW**

Taplow | Berkshire | SL6 0JF

TEL 01628 668561

[special.events@clivedenhouse.co.uk](mailto:special.events@clivedenhouse.co.uk)    [www.clivedenhouse.co.uk](http://www.clivedenhouse.co.uk)

