

The Clarendon Room



Brown's largest event space, The Clarendon Room, is named after Clarendon House, once the grandest residence on Piccadilly.

- High ceilings
- Natural daylight
- Private entrance on Dover Street
- Licensed for weddings



Boardroom

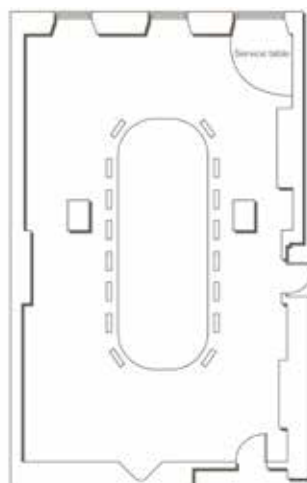

Banquet

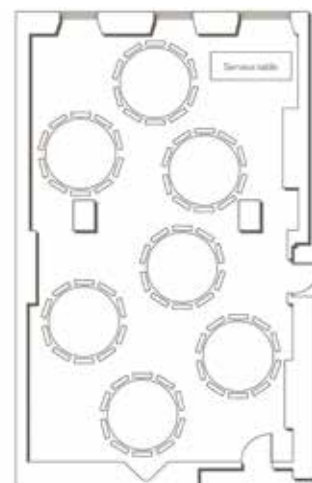

Size	Dimensions L x W x H	Boardroom	Hollow Square	Cabaret	Classroom	Banquet	Standing Reception	Theatre	U-Shape	Wedding Ceremony
76m ² 825ft ²	11.3 x 6.7 x 3.4m 37' x 22" x 11'	32	30	35	30	70	120	70	30	60

The Roosevelt Room



Named after the great American President, Franklin Roosevelt who visited Brown's on his honeymoon with Eleanor Roosevelt.

- Refurbished in 2023
- Located on the first floor
- High ceilings and full-length windows
- Can be interconnected to The Niagara Room
- Licensed for wedding ceremonies



Boardroom

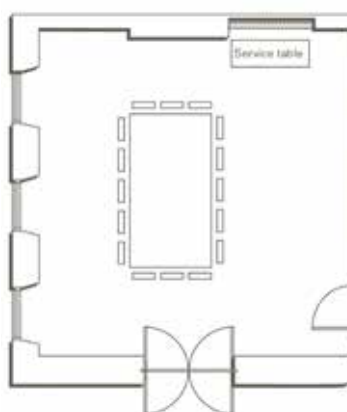

Banquet

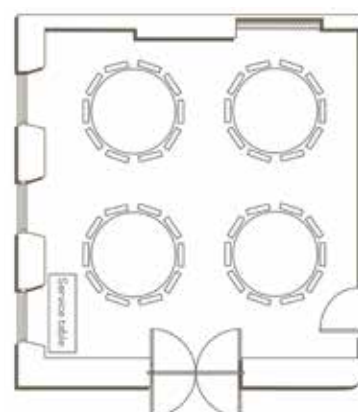

Size	Dimensions L x W x H	Boardroom	Hollow Square	Cabaret	Classroom	Banquet	Standing Reception	Theatre	U-Shape	Wedding Ceremony
52m ² 568ft ²	7.6 x 6.8 x 3.8m 25' x 22'8" x 19'9"	18	20	24	18	40	60	40	16	48



BROWN'S HOTEL
LONDON
A ROCCO FORTE HOTEL

The Niagara Room



Lord Kelvin led the International Niagara Commission meeting at Brown's in 1890, where they agreed to use water power for electricity. This room commemorates this historic event.

- Refurbished in 2023
- Located on the first floor
- High ceilings and full-length windows
- Can be interconnected to The Roosevelt Room



Boardroom

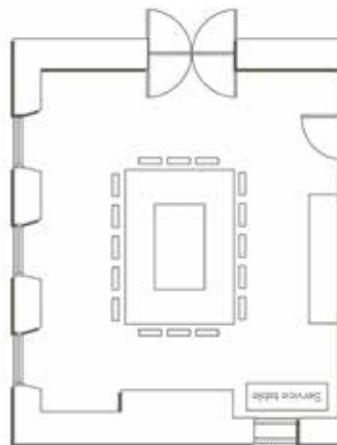

Banquet

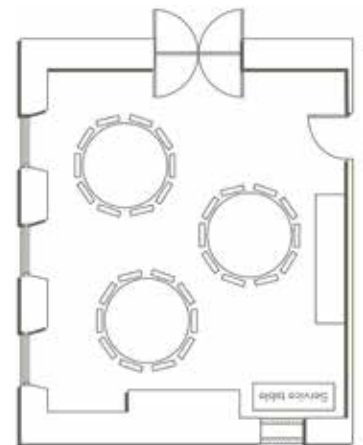

Size	Dimensions L x W x H	Boardroom	Hollow Square	Cabaret	Classroom	Banquet	Standing Reception	Theatre	U-Shape	Wedding Ceremony
50m ² 550ft ²	7.6 x 6.7 x 3.8m 24'10" x 22'2" x 12'9"	16	18	18	18	30	60	40	14	40

The Lord Byron Room



Named after Lord Byron, the Romantic poet and politician. Byron's fortune, entrusted to his butler James Brown, led to the birth of Brown's Hotel.

- Located on the ground floor
- Private entrance from Dover Street
- This space can be interconnected with The Graham Bell Room
- Natural daylight



Boardroom

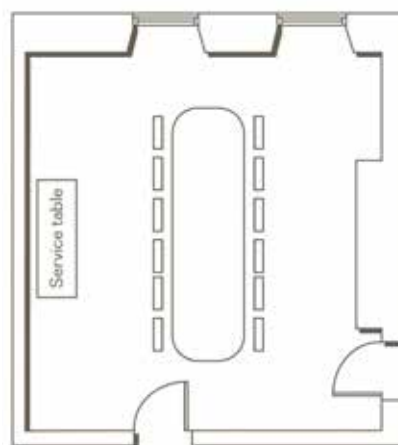

Size	Dimensions L x W x H	Boardroom	Hollow Square	Cabaret	Classroom	Banquet	Standing Reception	Theatre	U-Shape	
30.2m ² 328ft ²	5.6 x 5.3 x 3.3m 18'8" x 17'6" x 11'	12	12	–	12	–	16	10	–	



BROWN'S HOTEL
LONDON
A ROCCO FORTE HOTEL

The Graham Bell Room



It is believed that the very first telephone call in London made by its inventor, Alexander Graham Bell, took place at Brown's Hotel.

- Located on the ground floor
- Private entrance from Dover Street
- This space can be interconnected with The Lord Byron Room
- Natural daylight



Boardroom

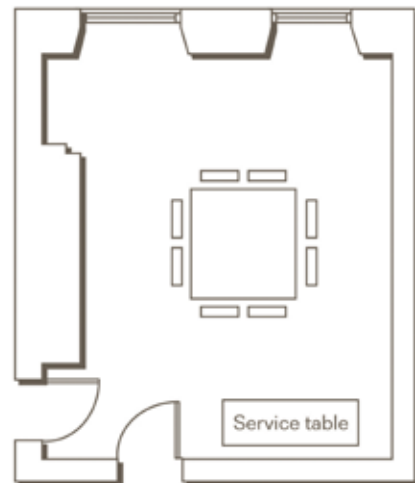

Size	Dimensions L x W x H	Boardroom	Hollow Square	Cabaret	Classroom	Banquet	Standing Reception	Theatre	U-Shape	
21.8m ² 234ft ²	5.1 x 4.2 x 3.3m 17' x 13'10" x 11'	8	8	–	8	–	14	8	–	

The St. George's Room



The most intimate event space at Brown's, The St George's Room commemorates a significant moment in 1889 when we merged The St George Hotel with Brown's Hotel, marking a crucial phase in the hotel's expansion.

- Located on the ground floor
- Private entrance from Dover Street
- Natural daylight



Boardroom

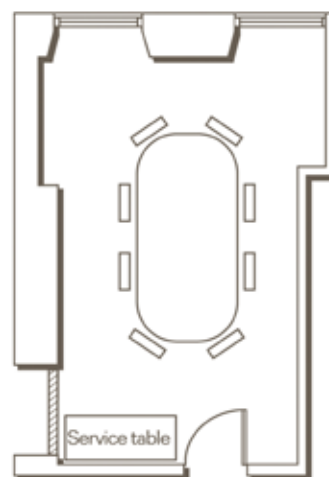

Size	Dimensions L x W x H	Boardroom	Hollow Square	Cabaret	Classroom	Banquet	Standing Reception	Theatre	U-Shape	
20.8m ² 224ft ²	5.5 x 3.8m 18' x 12'4"	8	8	–	8	–	10	8	–	