

No.4

Hamilton
Place



No.4

Hamilton
Place

CONTENTS

- WELCOME
- RECEPTION
- MARSHALL OF CAMBRIDGE ROOM & FOYER
- BILL BOEING LECTURE THEATRE
- MEZZANINE
- ARGYLL ROOM & TERRACE
- HANDLEY PAGE ROOM
- SOPWITH ROOM
- MARTIN BAKER ROOM
- BROUGHTON & FILTON ROOM
- TOULOUSE ROOM

Welcome

No.4

Hamilton
Place

No.4 Hamilton Place is a stunning Edwardian town house in central Mayfair, perfect for both corporate and private events in London.

Our versatile events venue brings together fine Edwardian features which provide a unique backdrop to any occasion as well as a stunning roof terrace with views over Hyde Park.

The venue team at No.4 Hamilton Place understand how important it is to not only provide a beautiful space in which organisers can host their event, but also deliver high end Audio and Video facilities and high-end catering. If you are looking for a historic London venue with all the modern convenience of a purpose-built space, then you have come to the right place.



No.4

Hamilton
Place

RECEPTION

At No.4 Hamilton Place our venue team will be always available at reception.

- A fully functional cloakroom on the ground floor
- Accessible ramps, toilet and lift available.

Marshall of Cambridge Room & Foyer

The Marshall of Cambridge Room and Foyer is an elegant and classic room with plenty of natural light making it well suited to smaller occasions such as private dining, receptions and meetings.

Located on the ground floor of our historic Mayfair venue, the room adjoins the Bill Boeing Lecture Theatre providing a useful area for guest registration, refreshment breaks and exhibition stands during conferences.



No.4

Hamilton
Place



Marshall of Cambridge Room – Floor Plan

No.4

Hamilton
Place

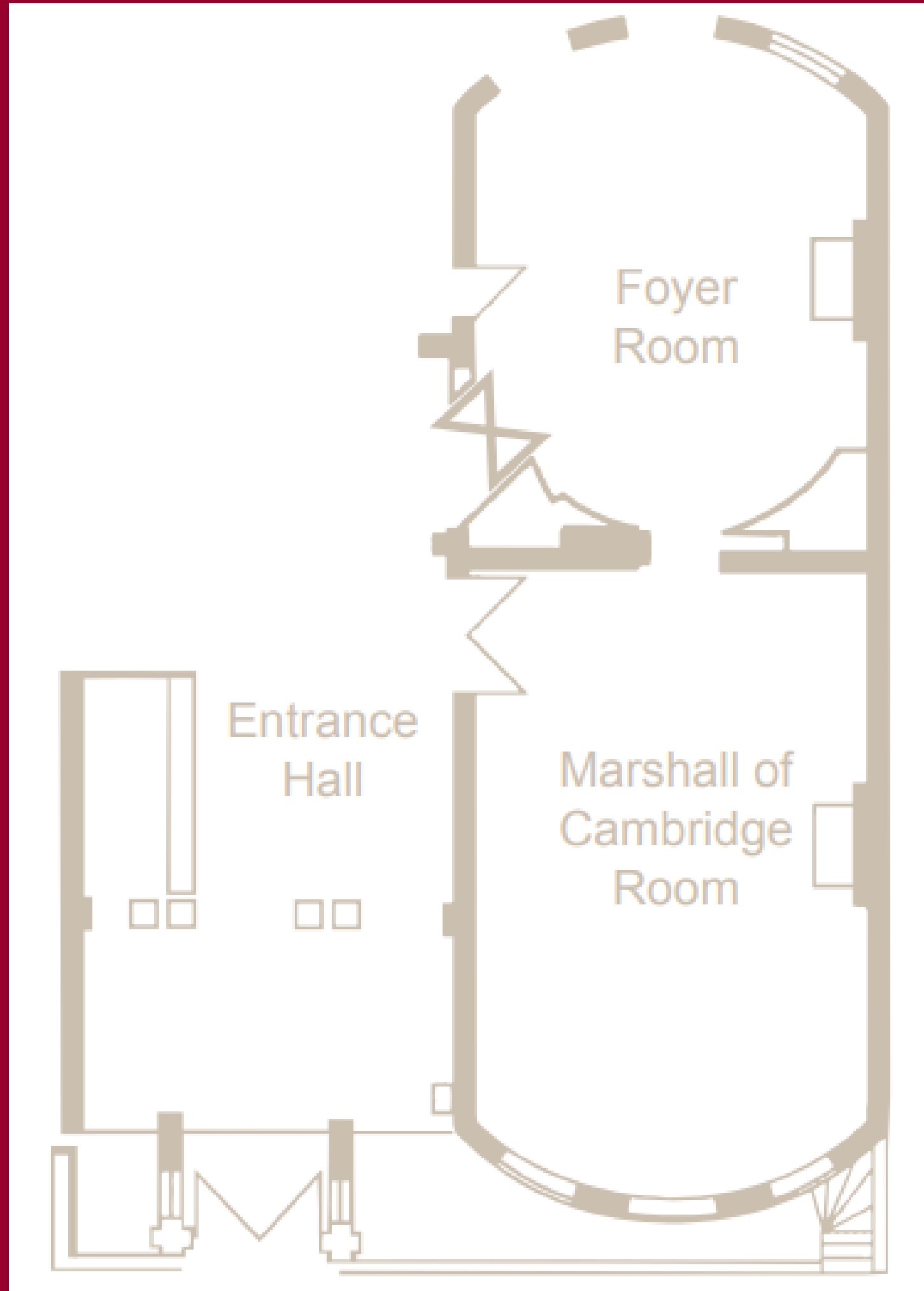

<u>Room Style</u>	<u>Max. Capacity</u>
<u>Theatre</u>	<u>60</u>
<u>Boardroom</u>	<u>24</u>
<u>Classroom</u>	<u>30</u>
<u>U-Shape</u>	<u>24</u>
<u>Dining</u>	<u>50</u>
<u>Receptions</u>	<u>120</u>
<u>Wedding Receptions</u>	<u>80</u>
<u>Wedding Ceremony</u>	<u>80</u>

No.4

Hamilton
Place

Bill Boeing Lecture Theatre

The Bill Boeing is the largest event space at No.4 and is perfectly equipped as a Mayfair conference venue.

It also works as a blank canvas space which can be transformed for larger occasions including parties, weddings, dinners.

The ground floor room has inbuilt Audio and Video, a stage area and can accommodate up to 200 guests in theatre style with removable seating that allows it to be versatile.



Bill Boeing Lecture Theatre - Floor Plan

No.4

Hamilton
Place

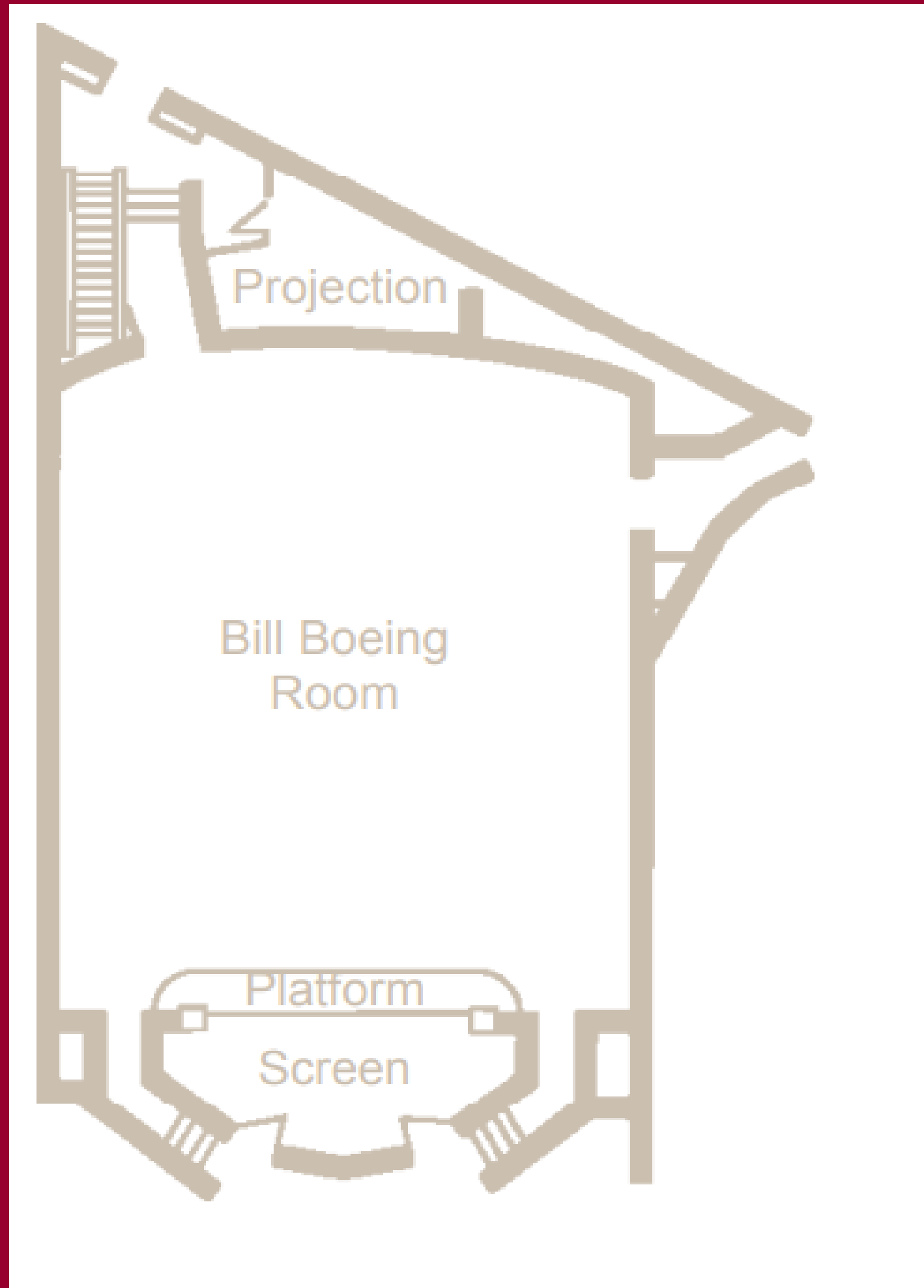

<u>Room Style</u>	<u>Max. Capacity</u>
<u>Theatre</u>	<u>200</u>
<u>Cabaret</u>	<u>100</u>
<u>Classroom</u>	<u>84</u>
<u>Dining</u>	<u>150</u>
<u>Receptions</u>	<u>300</u>
<u>Wedding Receptions</u>	<u>300</u>
<u>Wedding Ceremony</u>	<u>250</u>

No.4

Hamilton
Place

Mezzanine

Cosy space outside our Argyll Room, perfect for a registration or breakout space.



No.4

Hamilton
Place

Argyll Room & Terrace

With its fantastic terrace overlooking Hyde Park, the Argyll Room on the first floor is one of the most unique places in London.

The room itself is beautiful and provides an elegant setting for a variety of events including weddings, dinners and receptions.

The outdoor area of our historic Mayfair venue makes events truly memorable, from sunny BBQs to cosy Christmas drinks in the heated marquee that is provided for the festive season.



No.4
Hamilton
Place



No.4

Hamilton
Place



Argyll Room & Terrace - Floor Plan

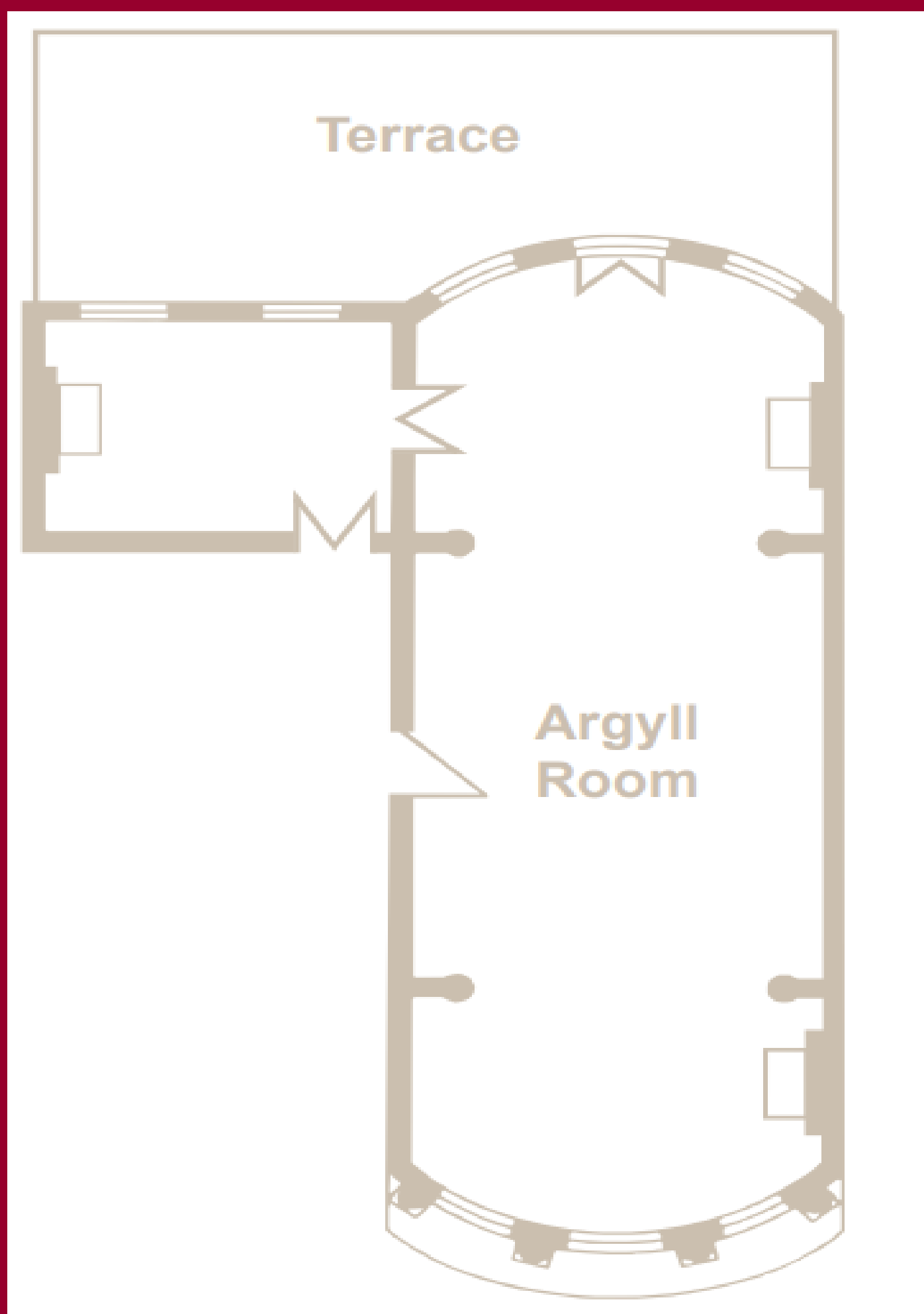

<u>Room Style</u>	<u>Max. Capacity</u>
<u>Theatre</u>	<u>100</u>
<u>Boardroom</u>	<u>40</u>
<u>Cabaret</u>	<u>48</u>
<u>Classroom</u>	<u>60</u>
<u>Dining</u>	<u>120</u>
<u>Receptions</u>	<u>200</u>
<u>Wedding Receptions</u>	<u>120</u>
<u>Wedding Ceremony</u>	<u>100</u>
<u>Barbecues</u>	<u>200</u>

Handley Page Room

The Handley Page Room is spacious with large windows offering fantastic views over Hyde Park.

Located on the second floor, the room is a great meeting space and works well for smaller evening events. It can be combined with the Sopwith Room which is conveniently located opposite, providing additional space for catering breaks, guest registration, drinks receptions and private dining.



No.4

Hamilton
Place

Perfect space for an
intimate dinner



Handley Page Room – Floor Plan

No.4

Hamilton
Place



<u>Room Style</u>	<u>Max. Capacity</u>
<u>Theatre</u>	<u>50</u>
<u>Boardroom</u>	<u>24</u>
<u>Cabaret</u>	<u>28</u>
<u>Classroom</u>	<u>20</u>
<u>Dining</u>	<u>40</u>
<u>Receptions</u>	<u>60</u>
<u>Wedding Receptions</u>	<u>60</u>
<u>Wedding Ceremony</u>	<u>50</u>

No.4

Hamilton
Place

Sopwith Room

The large windows ensure the spacious Sopwith Room on the second floor has plenty of natural light which makes it well suited as a daytime meeting room in Mayfair, as well as smaller evening events.

It works particularly well in combination with the Handley Room which is conveniently located opposite, providing additional space for catering breaks, guest registration, drinks receptions and private dining.

From meetings to a more intimate set up, the Sopwith Room is suitable for any occasion.



Sopwith Room - Floor Plan

No.4

Hamilton
Place

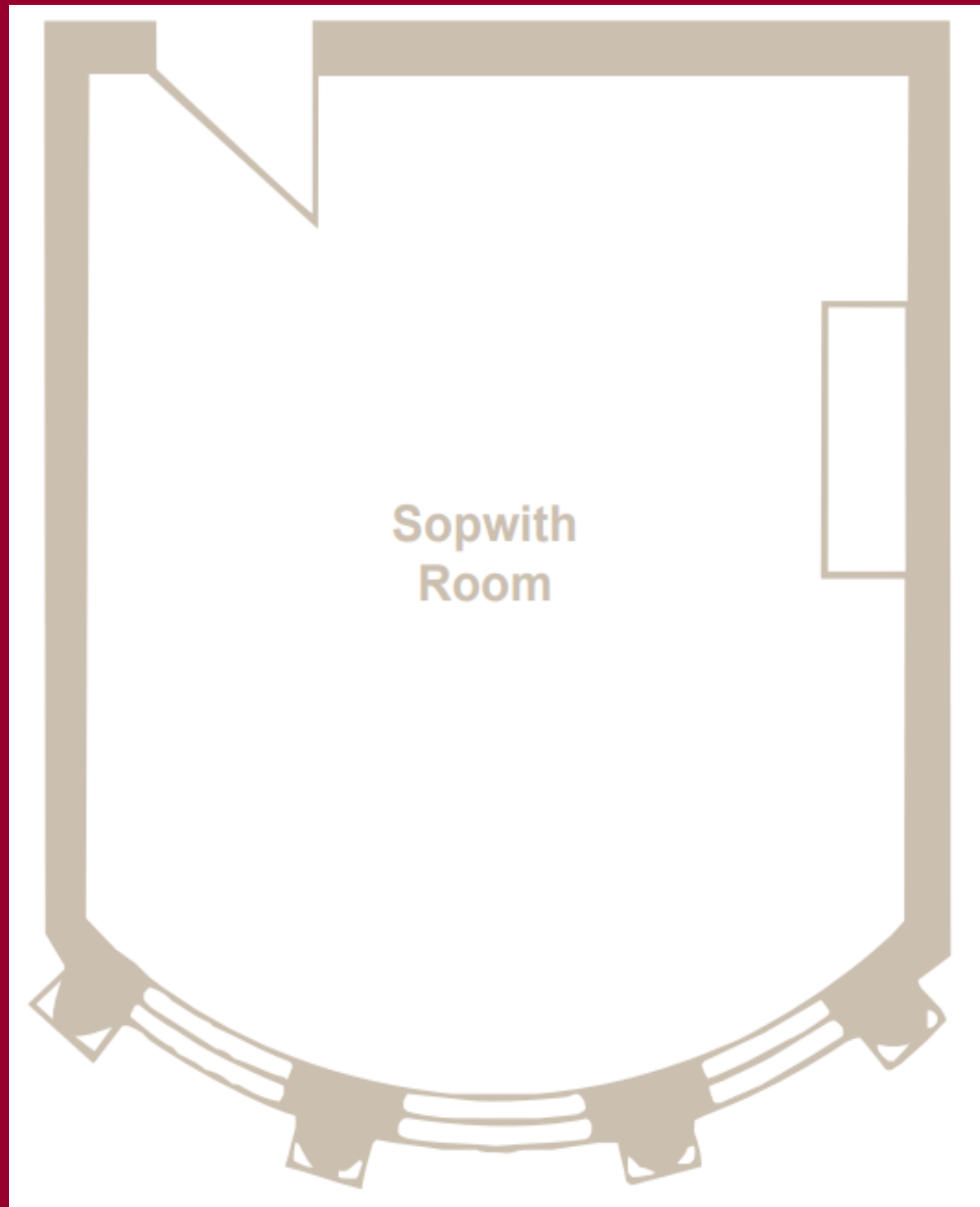

<u>Room Style</u>	<u>Max. Capacity</u>
<u>Theatre</u>	<u>50</u>
<u>Boardroom</u>	<u>24</u>
<u>Cabaret</u>	<u>28</u>
<u>Classroom</u>	<u>20</u>
<u>Dining</u>	<u>40</u>
<u>Receptions</u>	<u>60</u>
<u>Wedding Receptions</u>	<u>60</u>
<u>Wedding Ceremony</u>	<u>50</u>

No.4

Hamilton
Place

Martin-Baker Room

The Martin-Baker Room is located on the third floor and is an ideal Mayfair meeting room with built in Audio and Video and modern furnishings.

The Martin-Baker Company's history is displayed through exciting imagery around the room.

Suitable for all types of meetings.



Martin-Baker Room - Floor Plan



<u>Room Style</u>	<u>Max. Capacity</u>
<u>Theatre</u>	<u>n/a</u>
<u>Boardroom</u>	<u>20</u>
<u>Cabaret</u>	<u>n/a</u>
<u>Classroom</u>	<u>n/a</u>
<u>Dining</u>	<u>n/a</u>
<u>Receptions</u>	<u>n/a</u>
<u>Wedding Receptions</u>	<u>n/a</u>
<u>Wedding Ceremony</u>	<u>n/a</u>

No.4

Hamilton
Place

Broughton & Filton Rooms

Located in the Airbus Business Suite on the lower ground floor, the Broughton & Filton Room is a large meeting space in Mayfair perfect for a boardroom meeting or presentation in theatre style.

The Suite has useful breakout rooms including the Airbus Lounge and the education room, with casual seating and contemporary lighting.

Broughton & Filton Rooms - Floor Plan

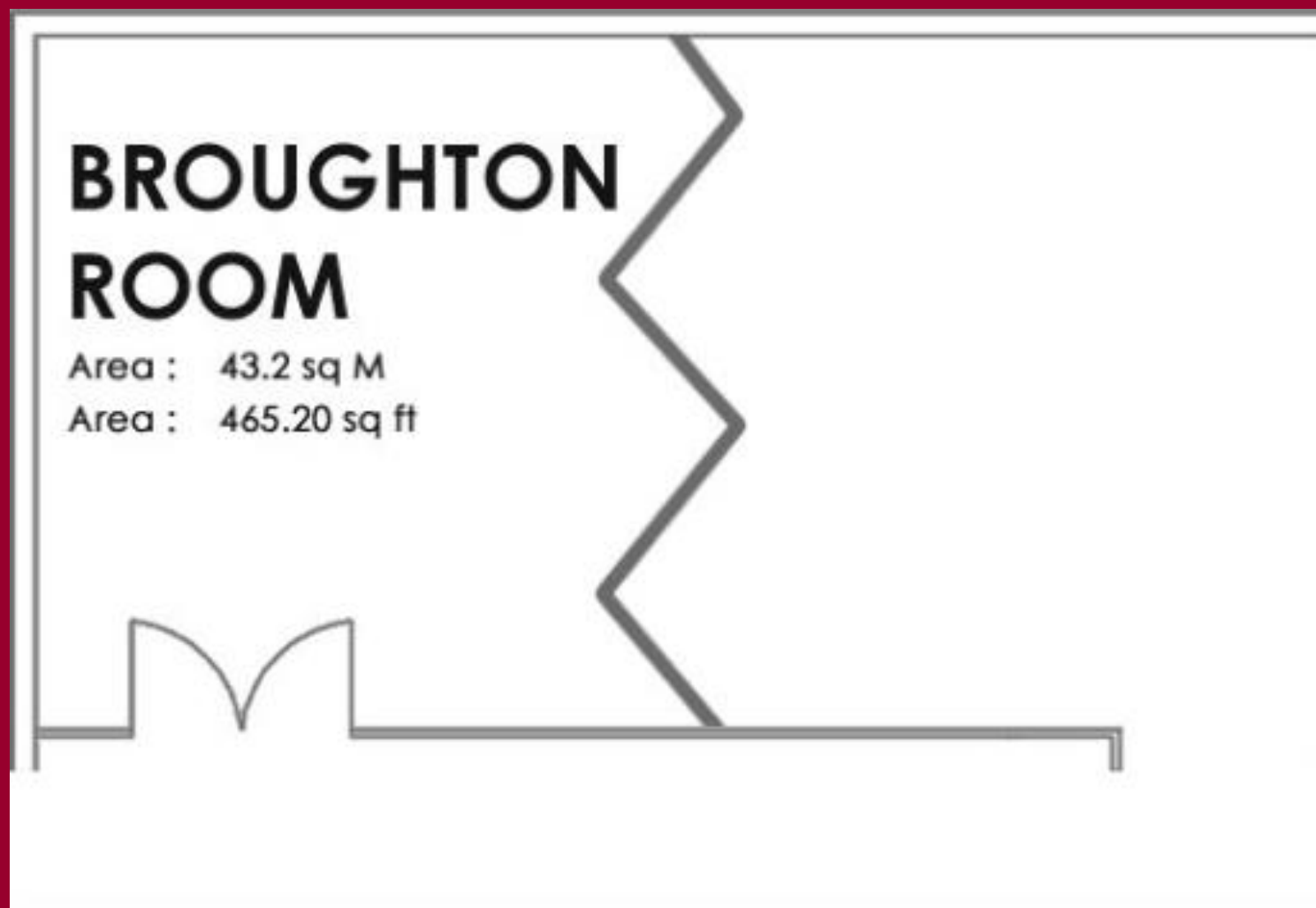

<u>Room Style</u>	<u>Max. Capacity</u>
<u>Theatre</u>	<u>n/a</u>
<u>Boardroom</u>	<u>20</u>
<u>Cabaret</u>	<u>n/a</u>
<u>Classroom</u>	<u>n/a</u>
<u>Dining</u>	<u>n/a</u>
<u>Receptions</u>	<u>n/a</u>
<u>Wedding Receptions</u>	<u>n/a</u>
<u>Wedding Ceremony</u>	<u>n/a</u>

No.4

Hamilton
Place

Toulouse Room

Located in the Airbus Suite on the lower ground floor, the Toulouse Room is ideal as a Mayfair meeting room. The Suite has useful breakout rooms including the Airbus Lounge and the education room, with casual seating and contemporary lighting.

Max. Capacity: 8



CONTACT US

Our venue team will work with you every step of the way.

☎ 0207 670 4314

✉ Hello@4hp.org.uk

Or have a look at our website and social media channels for further details.

- Website: www.4hp.org.uk
- Instagram: @4hamiltonplace
- Pinterest: @4hamiltonplace