

ONEALDWYCH

*One Great Event*  
*Meetings & Events*



## *Contents*

<i>Introduction</i>	<i>3</i>
<i>Private Room Capacities</i>	<i>4</i>
<i>Private Rooms 1&amp;2</i>	<i>5</i>
<i>Private Room 3</i>	<i>7</i>
<i>Screening Room</i>	<i>9</i>
<i>Daily Delegate Rates</i>	<i>13</i>
<i>Bedrooms &amp; Suites</i>	<i>16</i>



One Aldwych: an independent hotel with an individual mind, original in shape, style and story. In dynamic Covent Garden, enjoy craft cocktails and pioneering cuisine, an in-house health club and pool. Admire iconic architecture and spirited British design. Savour personalised service with personality. Experience One Aldwych, an original London hotel.

Its location in the cultural centre of London is unbeatable, with the Royal Opera House and over 25 major theatres within a ten-minute walk, as well as restaurants and stylish shopping on its doorstep.

With six versatile spaces for meetings and private dining, there are endless possibilities to host a memorable event at One Aldwych.





## Private Room Capacities

*Whether hosting a private film screening, a business event, a cocktail party or intimate sit-down dinner, or taking over the entire hotel for a wedding, let our dedicated events team help make One Aldwych your own.*

### Capacities

Room	U-shape	Boardroom	Theatre	Dinner	Reception
Private Room 1	-	18	24	20	30
Private Room 2	-	16	18	20	25
Private Rooms 1&2	30	35	60	50	80
Private Room 3	-	20	24	30	40
Screening Room	-	-	30	-	-
Lounge at One	-	-	-	-	50
Eneko Basque Kitchen & Bar	-	-	-	110	150

Capacities may alter depending on any audio-visual equipment in the room or catering requirements.



## *Private Rooms 1&2*

Private Rooms 1 and 2 are located next door to each other on the mezzanine level and can be used separately or combined together. From boardroom style meetings to elegant cocktail receptions, these versatile rooms are ideal for both private celebrations and business events.

The beautiful private rooms have large windows which provide natural daylight and an inspiring backdrop of busy London life. The room also offers state-of-the-art technology including the latest audio-visual equipment and complimentary WiFi.

## Private Rooms 1&2 Combined

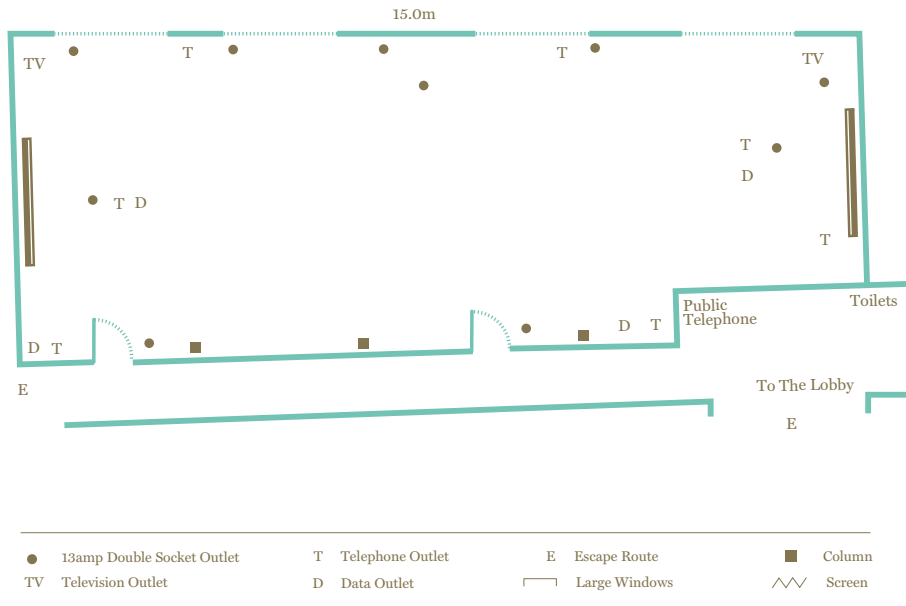

### Capacities

	Private Room 1	Private Room 2	Combined
Boardroom with screen	15	13	30
Boardroom without screen	18	16	35
Theatre	24	18	60
Round tables	20	20	50
Oval table	18	16	35
Reception	30	25	80
U-shape	-	-	30
Cabaret	-	-	28

### Room Size

Private Rooms 1&2 Combined	
15 x 5.75	86 sq m
Ceiling height	2.4 metres
49.2 x 18.9 ft	926 sq ft
Ceiling height	7.5 ft





## *Private Room 3*

A beautiful contemporary space with wooden flooring and calm, inspiring art on each wall, Private Room 3 is opposite the Screening Room and the ideal space for dinner with friends, business meetings and cocktail receptions, before or after a screening.

## Private Room 3

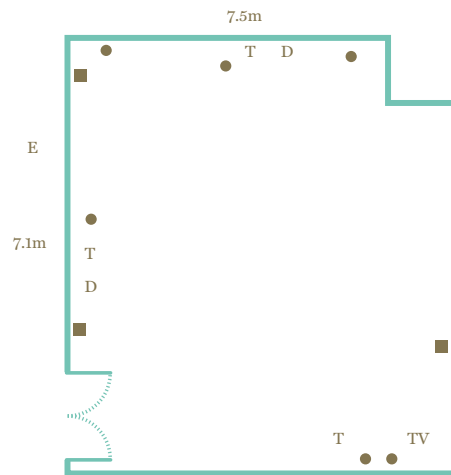

- 13amp Double Socket Outlet
- Telephone Outlet (T)
- Escape Route (E)
- Column
- TV Television Outlet
- D Data Outlet
- Large Windows
- ∩∩∩ Screen

### Capacities

Boardroom with screen	18
Boardroom without screen	20
Theatre	24
Dinner	30
Reception	40
Cabaret	14

### Room Size

7.5 x 7.1 metres 53 sq m  
 Ceiling height: 2.4 metres  
 24.6 x 23 ft 571 sq ft  
 Ceiling height: 7.9 ft







## *Screening Room*

With graduated leather seating, an experienced technician and plenty of popcorn, our private cinema is set up with everything you need for the perfect presentation or a private film screening.

The Screening Room is situated opposite Private Room 3, which works well for combining a drinks reception or dinner with your screening or presentation.



## Private Room 3 and Screening Room

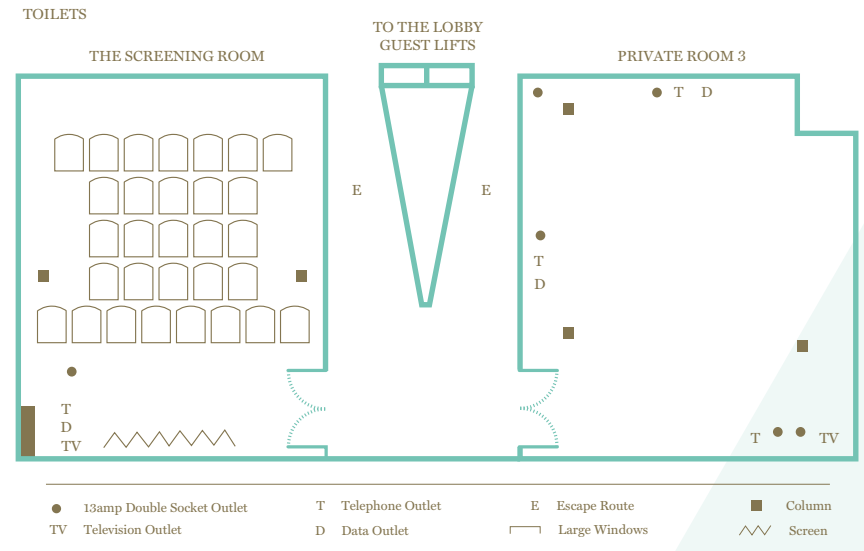

### Room Information

- 30 graduated Italian leather seats with drink rests
- A lectern for presentations
- 7.1 Dolby Surround Sound
- Full digital HD 1080p Blu-ray playback, Region 2
- Resolution - 2048 x 1080 pixels
- DCI Compliant NEC 2K Digital Projector, DCP Compatible, HFR Capable
- Full compatibility with PowerPoint
- TV broadcasts from BBC 1 HD, BBC 2 HD, ITV HD, Channel 4 and 5 HD
- Capability to play from multi-region DVD Player and DVD upscaling
- Capability for HD video player (advance notice required)
- Capability for HD Cam, HD Cam SR and DVC Pro HD (additional cost and a minimum of three working days' notice required)
- Connection for video game consoles

### Capacities

Theatre	30
---------	----

### Room Size

8.4 x 7.4 metres	62 sq m
Ceiling height:	2.4 metres
27.6 x 24.3 ft	667sq ft
Ceiling height:	7.4 ft

# Lounge at One



An elegant, stylish area located on the ground floor, the Lounge at One is the perfect place to host an intimate drinks reception for up to 50 guests. Enjoy sumptuous sofas, stunning floral arrangements and natural daylight.

The lounge also boasts a collection of beautiful books on fashion, design, architecture and travel, as well as a selection of contemporary art pieces.

## Capacities

Reception	50
-----------	----



# *Eneko Basque Kitchen & Bar*

Eneko Basque Kitchen & Bar is the stylish and informal restaurant from the acclaimed three Michelin-starred chef, Eneko Atxa.

Showcasing a modern take on traditional Basque food, Eneko Basque Kitchen & Bar offers playful dishes and decadent desserts in a relaxed setting. The food celebrates the flavours of northern Spain and ranges from delicate canapés to family style sharing dishes perfect for any party. The restaurant has a touch of the beautiful Basque region, with many materials sourced from local craftsmen and given a distinct London edge.

With its own private entrance, guests will arrive down the grand copper staircase into the bar to enjoy wine from the carefully crafted all-Spanish wine list, including a selection from Eneko's family winery, Gorka Izagirre.

## *Capacities*

Lunch or Dinner	110
-----------------	-----

Reception	150
-----------	-----



# Daily Delegate Rates

The stunning private rooms at One Aldwych offer a bright and inspiring backdrop for your meeting. Well located for both the City and the West End, the hotel offers daily delegate rates that are excellent value for meetings of ten or more people.

## *£110 per person, including:*

- Room hire from 7am to 5pm
- Pads, pencils and mints
- 75" HD screen
- One flip chart
- Complimentary WiFi
- Water throughout the day
- Home-baked Danish pastries, croissants and mini muffins on arrival
- Two servings of coffee, tea or herbal tea and a snack during the day
- Working buffet lunch served in the meeting room
- Bookings must be for a minimum of ten people for the Private Room 3 and for a minimum of twenty people for Private Rooms 1 and 2 combined.

*All prices are inclusive of VAT at the current rate. All food and beverage rates exclude an optional service charge of 12.5%.*



## *Private Movie Party*



From birthdays to hen parties and baby showers, celebrate a special occasion with a private movie party in our luxurious private cinema in the heart of London. Bring a film of your choice or choose from Curzon's selection of new releases or much-loved classics to watch in our 30-seat private Screening Room with plenty of popcorn, followed by a two or three-course dinner in one of our contemporary private dining rooms.

- Room hire & two-course dinner - £95 per person
- Room hire & three-course dinner - £105 per person
- Room hire & popcorn - £400 per hour (minimum two hours)

### *What's included*

- Hire of our luxurious Screening Room to watch your choice of film
- Sweet or Salted Popcorn
- An optional two or three-course dinner in the adjacent Private Room 3

*Minimum spend on catering is £1,900. All prices are inclusive of VAT at the current rate. There is an additional optional service charge of 12.5% for food and beverage.*

# Menus

Whether it is an energy boosting breakfast, an afternoon tea with a difference, original canapés for a fun party or a decadent dinner, Executive Chef Dominic Teague's carefully crafted menus, incorporating fresh, seasonal and responsibly sourced ingredients are sure to delight.

Breakfast	From £26
Breakfast canapés	£30
Tea, coffee and pastries	£12
Working lunch buffet	£45
One signature buffet	£55
Three-course lunch or dinner	From £65
Canapés (6 items)	£20
Afternoon tea	£62 <i>with a glass of Champagne</i>

*All costs per person.*

Mineral water	£5.50	a bottle
Orange juice	£5.50	a glass
Soft drinks	From £4.00	a bottle
Wine	From £30.00	a bottle
Prosecco	£39.00	a bottle
Champagne	From £84.00	a bottle

*All prices are inclusive of VAT at the current rate. All food and beverage rates exclude an optional service charge of 12.5%.*



## *The Chef's Dining Experience*

To make your event even more spectacular, wow your guests with our tailored and interactive dining experience.

Start the event with a personal introduction from Chef Dominic Teague, with the option of a private tour of the hotel's state-of-the-art kitchen, before learning more about the ingredients used in Dominic's signature dishes. Take a seat in one of our stunning private rooms for a five-course Signature Menu, crafted by Chef Dominic.

*£130 per person, minimum of ten guests.*

*Enjoy the following group benefits:*

- An exclusive arrival experience for the group, with complimentary coffee, tea and pastries, and a spa therapist on hand to provide head, neck and shoulder massages\*
- 15% discount off treatments in the Health Club from Sunday to Friday
- Complimentary cocktail demonstration when booking a private room for dinner\*
- Complimentary pressing on arrival (two items per person)

\*Subject to group number and availability. Bookings of 8 rooms or more shall be considered a group booking.

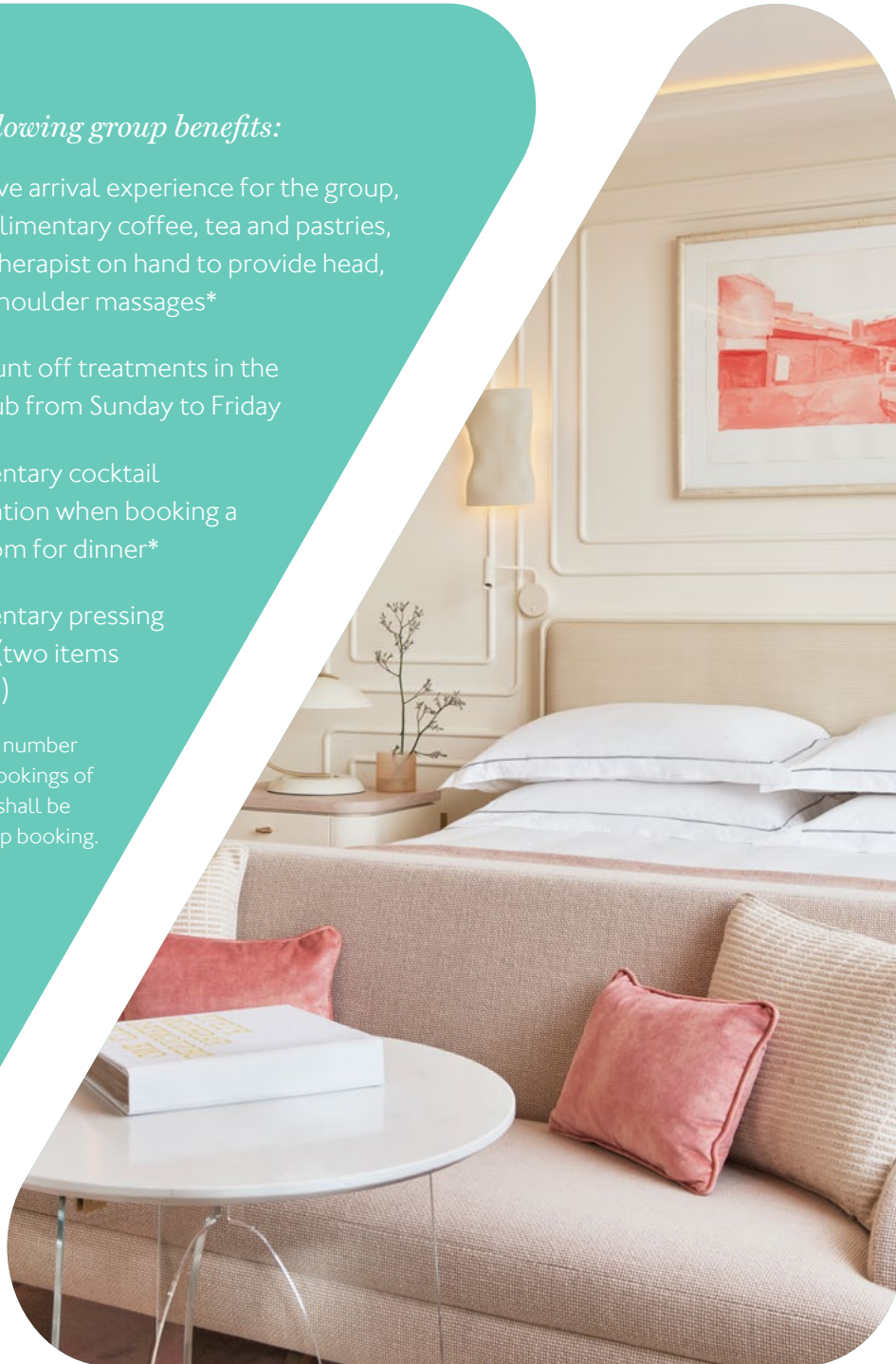

## *Bedrooms & Suites*

In cool, calm pastel hues, contemporary curves and elegant art deco details, each well-appointed room and suite at One Aldwych promises peace, quiet and complete comfort mere metres above the hustle and bustle of town. Recently redesigned, each light-filled space is unique in design, alike in exceptional quality. Expect luxurious finishings, from rainforest showers to Bang & Olufsen speakers.

### *Thoughtful Little Touches*

- Unlimited WiFi
- Fresh flowers delivered daily
- Use of the Health Club with chlorine-free pool, sauna, steam room and 24-hour gym
- Use of Lounge at One, the private guest lounge
- Access to unlimited online magazines and newspapers
- A selection of tea and coffee in each room
- A shoe shine service and newspapers available



## *Social Events*

In the heart of London, One Aldwych is the perfect destination for hosting an exciting experience for any occasion.

From a traditional Champagne breakfast, to a private afternoon tea, we can make your event happen.



## *Flowers at One*

For eye-catching displays, Mark Siredzuk of Flowers at One, our in-house florist, is on hand to create magnificent arrangements and installations to add the wow factor to your event. To discuss your floral requirements, please contact our Events Team.



# Weddings



One Aldwych is also the perfect place for organising your special day.

For an intimate and romantic wedding breakfast with up to 110 guests, we offer a beautiful venue for a day to remember.

We are also licensed to hold your civil ceremony at One Aldwych for up to 70 guests. For more information please contact our Events Team.

# ONEALDWYCH

For further details or to arrange a visit to the hotel,  
please contact the Events Team at One Aldwych.

Tel: 020 7300 0700 Email: [events@onealdwych.com](mailto:events@onealdwych.com)  
One Aldwych, London WC2B 4BZ

[onealdwych.com/events](https://onealdwych.com/events)



onealdwych



onealdwych



onealdwychhotel