



# Events Tailored to You No Matter the Occasion



# Welcome

With views over the City, Hyatt Regency London Stratford offers a modern, versatile dedicated event's floor located right in the heart of East London. Whether you require a brainstorming boardroom, or a glamorous banquet, with 295 sqm of meetings and events spaces, you'll find exactly what you're looking for.







# What We Offer

Flexible meeting spaces to suit every type of occasion, from small meetings to larger conferences.

- Complimentary WiFi access
- Convenient London location easily accessible by air, road and rail
- New meeting rooms with advanced technology and natural daylight
- Flexible meeting spaces to suit every type of occasion, from small meetings to larger conferences
- A creative and passionate in-house banqueting team offering delicious seasonal dishes
- Premium rooms and suites





# Stratford Suite

 **195** sqm

 14.1 x 16.4 x 2.8m

 **90** Banquet

 **50** Boardroom

 **90** Reception

 **50** U-Shape

 **80** Theatre

 **40** Hollow Square

 **72** Cabaret

 **10** Exhibit

 **60** Classroom

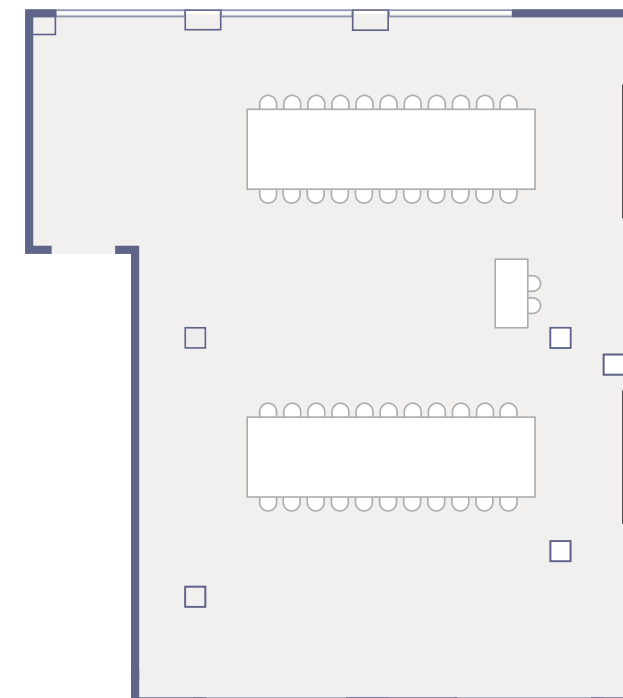



# Bow Suite

 **60** sqm

 **11.5 x 5.5 x 2.8m**

 **40** Banquet

 **20** Boardroom

 **50** Reception

 **20** U-Shape

 **50** Theatre

 **20** Hollow Square

 **40** Cabaret

**5** Exhibit

 **25** Classroom

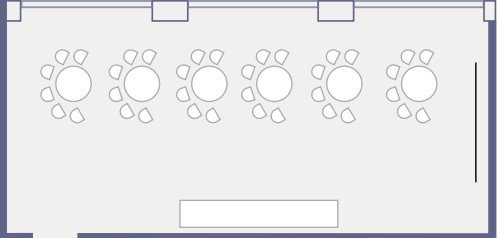





# Poplar Suite

 **40** sqm

 **7.7 x 5.5 x 2.8m**

 **12** Banquet

 **12** Boardroom

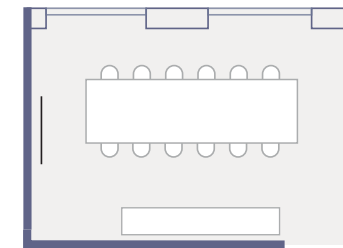



# Lea Suite 1+2

 **130** sqm

 21.9 x 5.8 x 2.8m

 **64** Banquet

 **60** Classroom

 **120** Reception

 **42** Boardroom

 **90** Theatre

 **46** Hollow Square

 **64** Cabaret

 **10** Exhibit

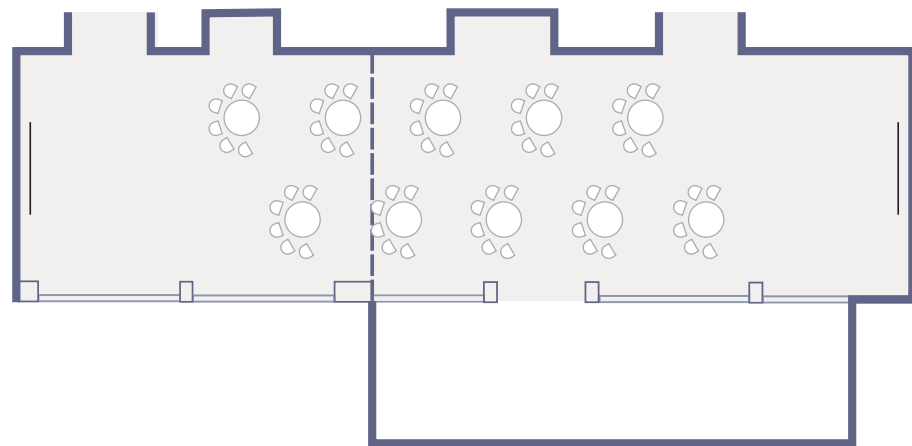





# Kingsland Suite 1

 **80** sqm

 **13.8 x 6.8 x 2.8m**

 **40** Banquet

 **28** Boardroom

 **90** Reception

 **24** U-Shape

 **42** Theatre

 **28** Hollow Square

 **24** Classroom

 **3** Exhibit

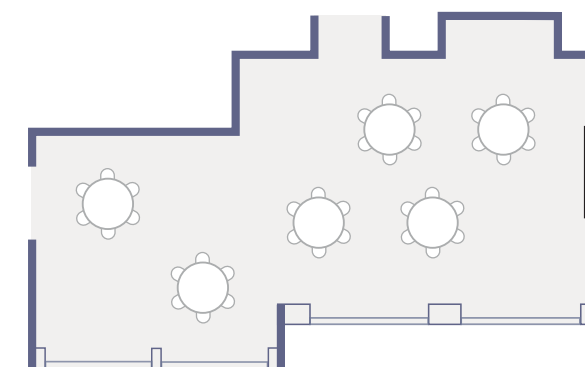



# Kingsland Suite 2+3

 **85** sqm

 15.8 x 5.8 x 2.8m

 **40** Banquet

 **30** Boardroom

 **50** Reception

 **30** U-Shape

 **75** Theatre

 **30** Hollow Square

 **40** Cabaret

 **6** Exhibit

 **36** Classroom

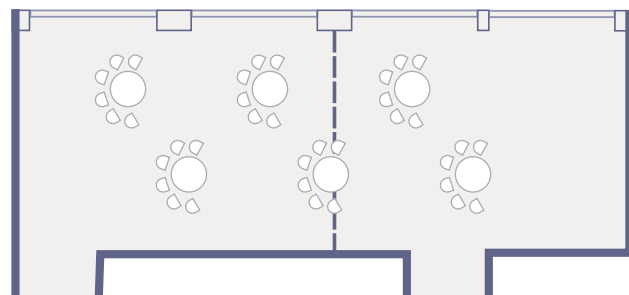



# Dalston Suite 1

 **64** sqm

 10.0 x 5.8 x 2.8m

 **24** Banquet

 **28** Boardroom

 **40** Reception

 **24** U-Shape

 **40** Theatre

 **28** Hollow Square

 **24** Cabaret

 **4** Exhibit

 **24** Classroom

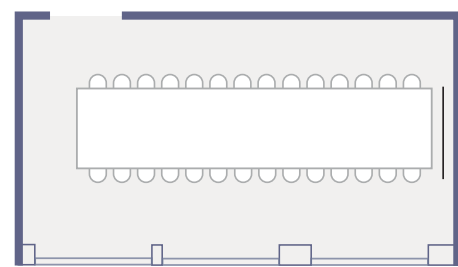

# Dalston Suite 2

 **49** sqm

 8.6 x 5.8 x 2.8m

 **16** Banquet

 **14** Boardroom

 **25** Reception

 **14** U-Shape

 **30** Theatre

 **14** Hollow Square

 **16** Cabaret

 **3** Exhibit

 **16** Classroom

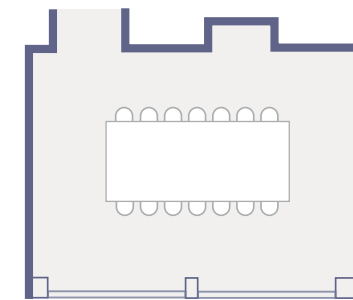



# Capacities & Floor Plan

## CAPACITY CHART



Room Name	Room Dimensions L x W x H	Room Size Sq. M. / Sq. Ft.	Banquet	Cabaret	Reception	Theatre	Classroom	Boardroom	U-Shape	Hollow Square	Exhibit
Level 3											
STRATFORD SUITE	14.1m x 16.4m x 2.8m 46' 3" x 53' 10" x 9' 2"	195 2,100	90	90	90	80	60	50	50	40	15
BOW SUITE	11.5m x 5.5m x 2.8m 37' 9" x 18' 1" x 9' 2"	60 646	40	40	50	50	25	20	20	20	5
POPLAR SUITE	7.7m x 5.5m x 2.8m 25' 3" x 18' 1" x 9' 2"	40 431	12	-	-	-	-	12	-	-	-
PRE-FUNCTION	8.1m x 7.5m x 2.8m 26' 7" x 24' 7" x 9' 2"	54 581	12	-	30	-	-	-	-	-	2
Level 12											
LEA SUITE 1+2	21.9m x 5.8m x 2.8m 71' 10" x 19' 0" x 9' 2"	130 1,400	64	64	120	90	60	42	-	46	10
Lea Suite 1	8.7m x 5.8m x 2.8m 28' 7" x 19' 0" x 9' 2"	51 549	16	16	40	36	24	16	24	26	3
Lea Suite 2	13.2m x 5.8m x 2.8m 43' 4" x 19' 0" x 9' 2"	79 850	40	40	80	75	36	36	40	30	5
KINGSLAND SUITE 1	13.8m x 6.8m x 2.8m 45' 3" x 22' 7" x 9' 2"	80 861	40	-	90	42	24	28	24	28	3
KINGSLAND SUITE 2+3	15.8m x 5.8m x 2.8m 45' 3" x 19' 0" x 9' 2"	85 915	40	40	50	75	36	30	30	30	6
Kingsland Suite 2	7.7m x 5.8m x 2.8m 25' 3" x 19' 0" x 9' 2"	44 474	-	16	20	35	18	15	12	12	3
Kingsland Suite 3	7.2m x 5.8m x 2.8m 23' 7" x 19' 0" x 9' 2"	41 441	-	-	20	35	18	15	12	12	3
DALSTON SUITE 1	10.0m x 5.8m x 2.8m 32' 10" x 19' 0" x 9' 2"	64 689	24	24	40	40	24	28	24	28	4
DALSTON SUITE 2	8.6m x 5.8m x 2.8m 28' 3" x 19' 0" x 9' 2"	49 527	16	16	25	30	16	14	14	14	3

FLOOR PLAN  
Level 3

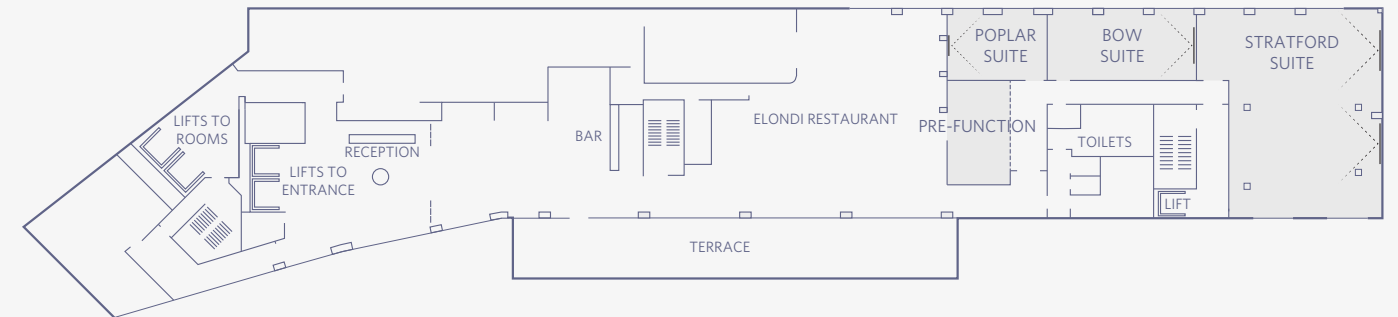

Level 12

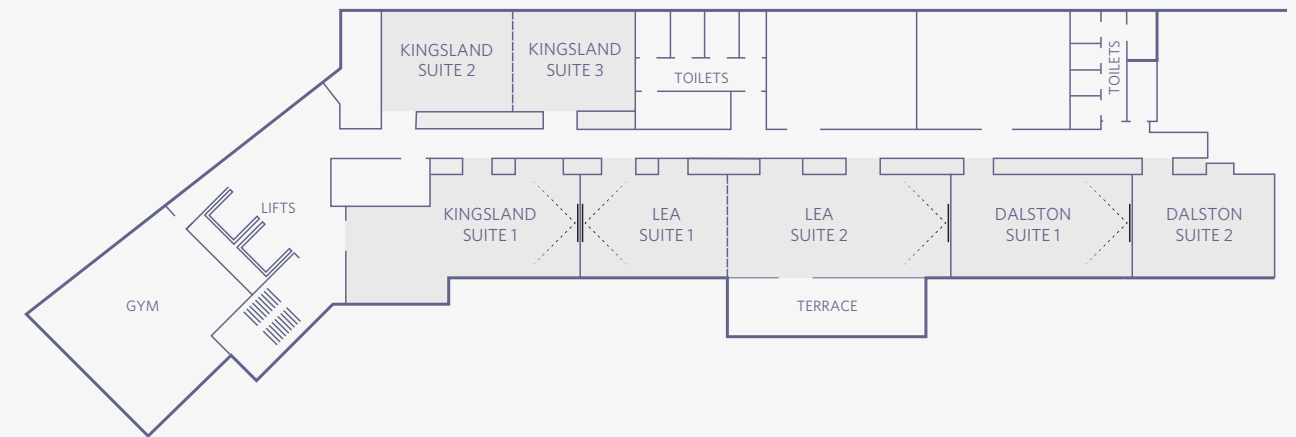





# Guestrooms

Hyatt Regency London Stratford offers a refined stay in the fashionable neighbourhood of Stratford, London. Relax and recharge in one of our sophisticated rooms or suites featuring modern décor, luxe amenities and premium bathrooms with marble vanities and walk-in showers. Work comfortably at the large desk, connect to the Smart TV and sleep deeply in the plush bed.

 **225** Rooms

 **10** Suites

 **22-38** sqm

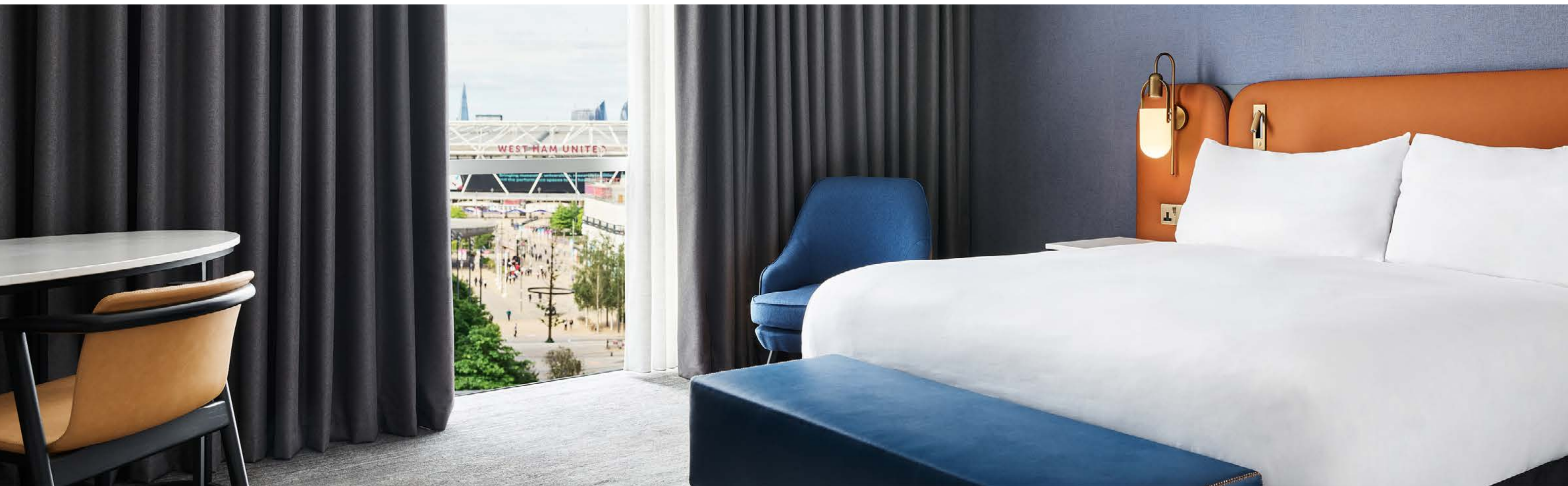





# Elondi Restaurant & Bar

Hyatt Regency London Stratford's all day dining restaurant Elondi serves delicious cuisine inspired by East London dining. The opulent surroundings make it the perfect place to relax, recharge and dine. The sophisticated Elondi Bar and Terrace features bespoke and classic perfectly executed cocktails, along with local and international wines, craft beers and delicious bar snacks.







**HYATT**  
REGENCY™  
LONDON STRATFORD

**Get in touch to book an  
appointment or to find  
out more about our  
bespoke event packages.**

**Hyatt Regency London Stratford**

10A Chestnut Plaza Westfield,  
London, United Kingdom, E20 1GL

+44 (0)20 3814 1234

[Reception.hrlondonstratford@hyatt.com](mailto:Reception.hrlondonstratford@hyatt.com)