

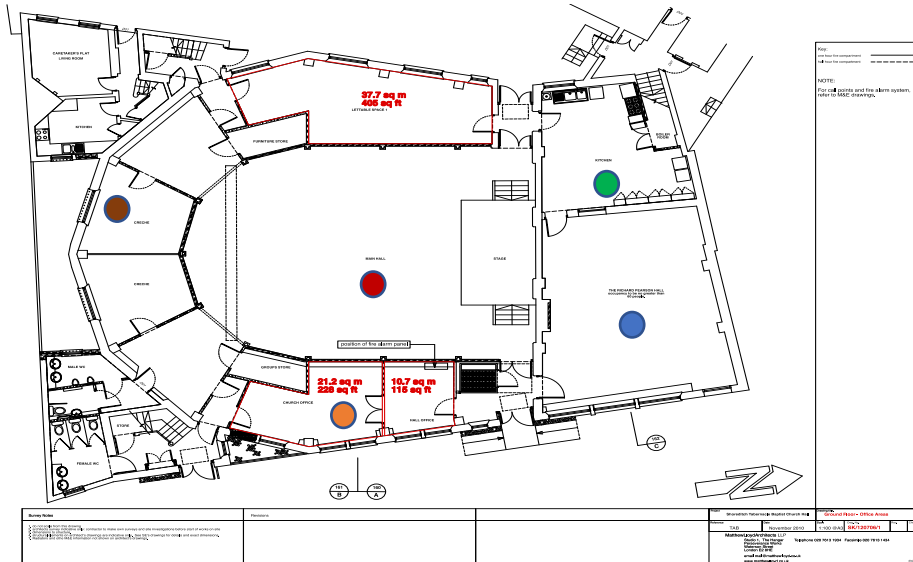

## Tab Centre Measurements

Space	Measurements*	Description/Capacity
● Tab Centre Main Hall (G)	15.7m x 11m (173m <sup>2</sup> )	Shows/Launches/shoots (200)
● Richard Pearson Room (G)	9.9m x 7.9m (78m <sup>2</sup> )	Overflow/Meet up space (60)
● Gallery (1 <sup>st</sup> )	16.7m x 4.4m (73m <sup>2</sup> )	Exhibitions/Audience viewing (40)
● Kitchen (G)	6.35m x 4.4m (28m <sup>2</sup> )	Commercial catering space (6)
● Tank room (1 <sup>st</sup> )	13.3m x 4.4m (47m <sup>2</sup> )	Workshop/office/meetings (20)
● Martin Luther room (1 <sup>st</sup> )	9.9m x 4.3m (33m <sup>2</sup> )	Cosy space with kitchenette (30)
● Recording Studio (G)	4m x 3.6m (15m <sup>2</sup> )	Professional recording studio (5)
● Front Offices (G)	3.5x3.1m + 8.3x4m (32m <sup>2</sup> )	2 adjoining office spaces (6 desks)

### Tab Ground Floor



### Tab First Floor

