



KING'S  
HOUSE

A home for events in the heart of King's Cross.



# Our Story

King's House is a centre of community, justice & entrepreneurship; a home in the heart of King's Cross.

As part of King's Cross Church's vision (KXC), our hope is that this building will create an accessible community hub, housing local group activities and specialised services that support people from all walks of life to thrive. The event spaces for hire will fund and fuel these groups, and the ongoing story of new life.

The building has recently undergone a full refurbishment, led by Stirling Prize-winning architects Haworth Tompkins, and is a beautiful and flexible space to hold any event.

Whether you want to participate in our venture by hiring the space, or would like to seek support for challenging circumstances, our door is open to you.

For any more information about King's House please email [info@kingshouse.org.uk](mailto:info@kingshouse.org.uk).





Approx. 10 minute walking distance

☰ ☯ King's Cross Station

King's House

☰ ☯ St. Pancras Station

Pentonville Rd.

☰ ☯ Euston Station

☰ ☯ Angel Station

# The Building

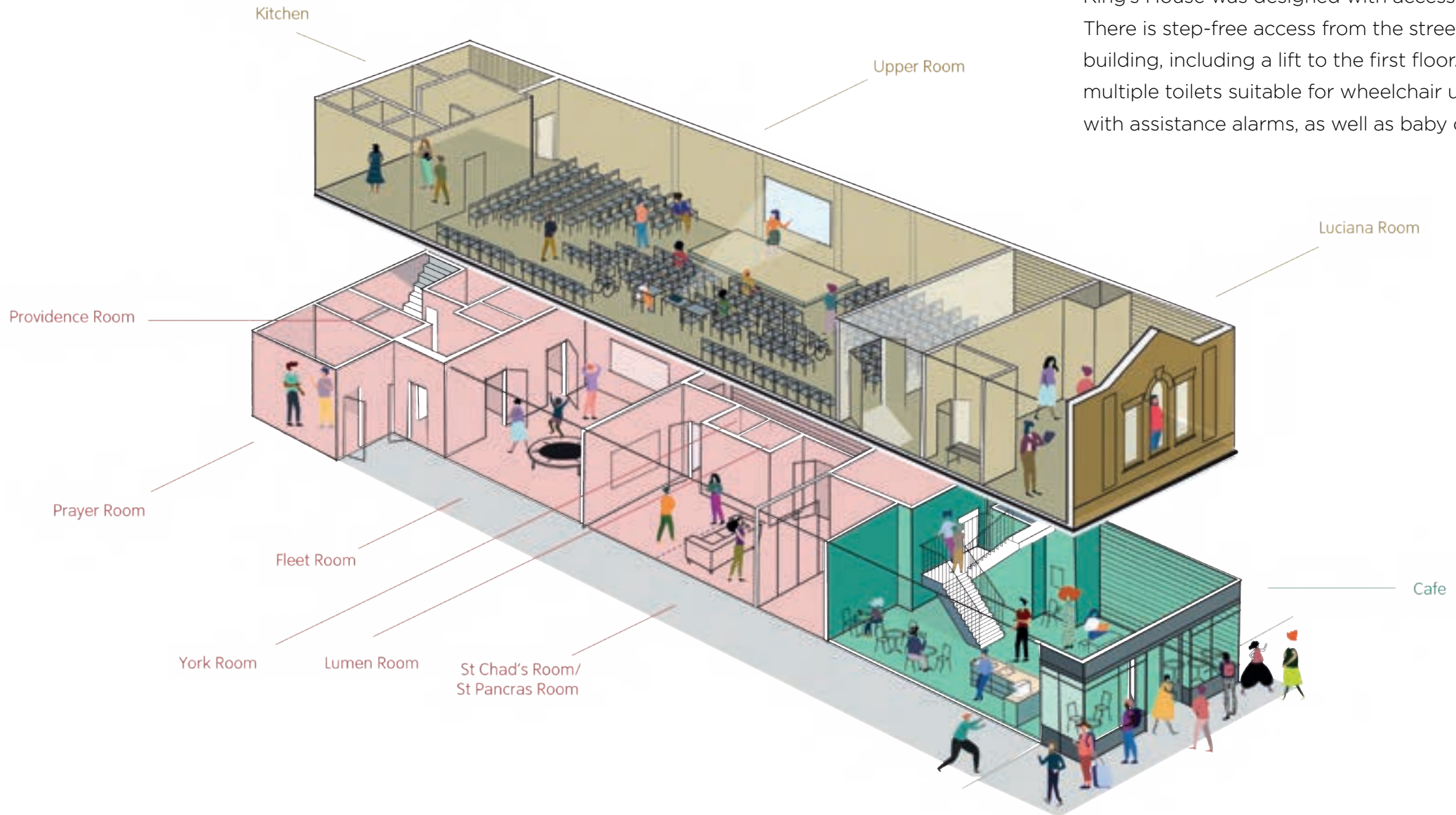

King's House was designed with accessibility in mind. There is step-free access from the street right through the building, including a lift to the first floor. There are also multiple toilets suitable for wheelchair users and fitted with assistance alarms, as well as baby changing units.

# The Rooms

## Luciana

242 Pentonville Road was first built in 1923 as the Luciana Temperance Billiard Hall. Luciana means 'light' and we believe that King's House has been established to be a beacon of light and hope to the people of King's Cross and beyond.

## St. Pancras

In 597 AD a mission of Roman monks arrived here carrying the relics of the martyr St Pancras. The monks built a church in King's Cross (St Pancras Old Church) making it one of the oldest sites of Christian worship in Europe.

## York

Over a period of three years, KXC were given 15,000 square feet of empty space at York House on Pentonville Road. It became home to the church offices, local charities, community projects and coworking spaces. This became a significant part of the church's story, particularly in the area of creativity and cultural renewal.

## Providence

Primarily used as a room by our partners Crux as a conflict Mediation room, the word itself means 'divine guidance or care'.

## St. Chad's

Just a stone's throw away from here was the historic St Chad's Well: an ancient well of purification which, during the 18th century, received over a 1000 visitors each week in search of healing. Physicians at the time described the well as "the best purging waters in England".

## Lumen

On 14th February 2010, KXC held its first ever service. Without a permanent place to call home, the church began renting space for Sunday gatherings, and it all started at the Lumen United Reform Church on Tavistock Place. The Lumen room is often used by CAP (Christians Against Poverty) to provide a safe, private a pace to offer debt advice.

## Fleet

The River Fleet is the largest subterranean river in London and runs directly beneath King's Cross Station. The area was originally named Battlebridge after Queen Boudica's army fought the Romans in AD61 at the bridge crossing over the River Fleet. This room is used as a base by Growing Hope, providing free therapy sessions for children with additional needs.

# The Upper Room

The main event space.

Situated on the first floor, this 2000sq ft former Billiards Hall has been newly-refurbished, containing exposed brick walls, industrial windows & high ceilings. With a 200-seat flexible auditorium and full PA/AV system, the space is fully equipped for live streaming and hybrid events.

Hirers can expect an adaptable space that includes the use of a kitchenette, in a central location with fantastic transport links, not only within London, but across the UK and beyond.



Available Thursday-Saturday  
Pricing from £300/hour  
[kingshouse.org.uk/hire](https://kingshouse.org.uk/hire)

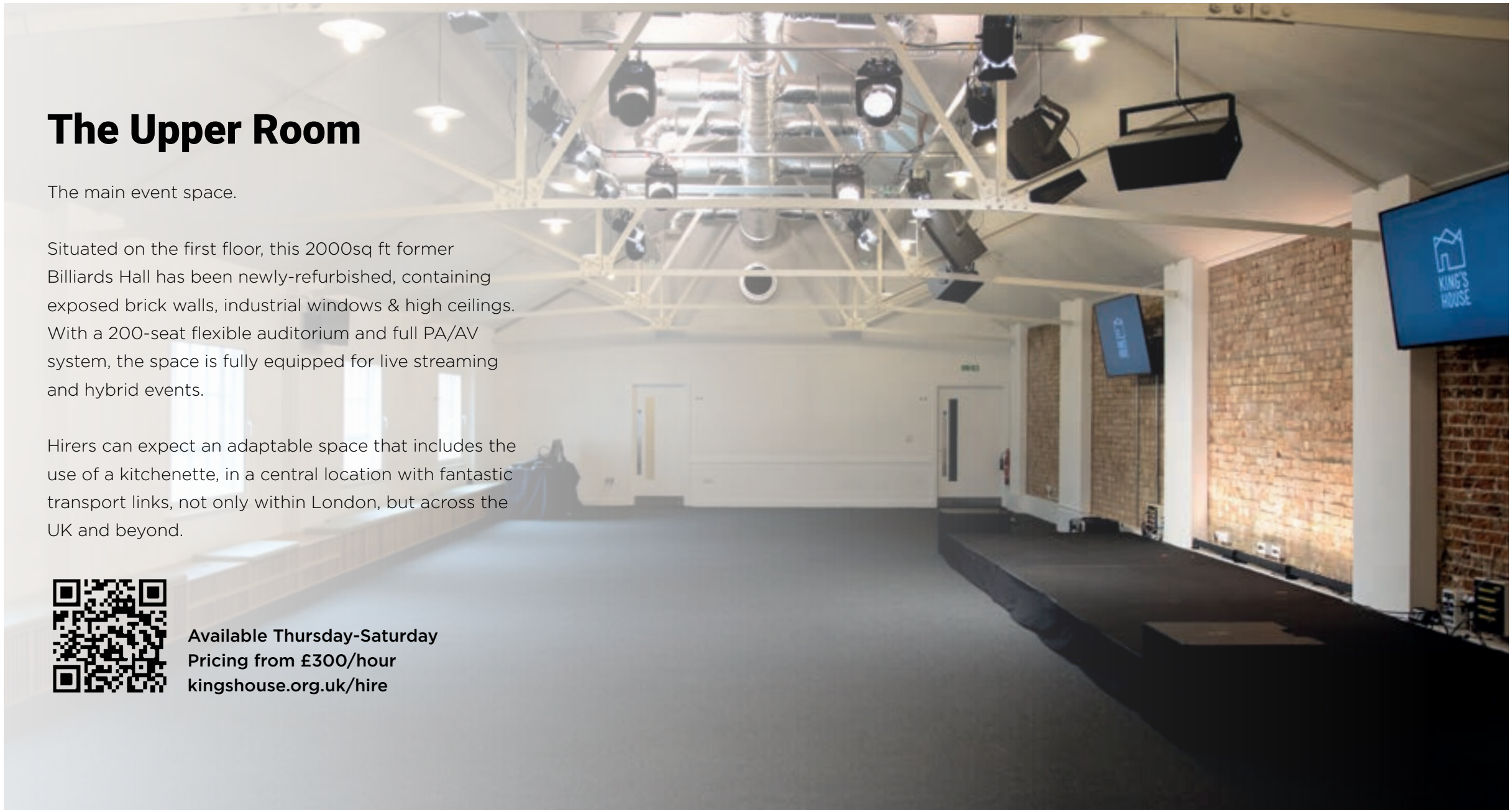





**Music & Live Performances**



**Studio Hire & Workshops**



**Corporate Events & Conferences**



**Charity Events & Celebrations**



# The Luciana Room

As the main office of King's Cross Church, the Luciana Room is the working centre of the building. In the evenings, and on Saturdays, it transforms into an intimate 30-person event space.

Fully air-conditioned, with full AV functionality, and bursting with light, the Luciana Room is perfect for meals, breakout sessions and smaller events.



Available Thu & Fri Evenings, & Sat  
Pricing from £75/hour  
[kingshouse.org.uk/hire](https://kingshouse.org.uk/hire)

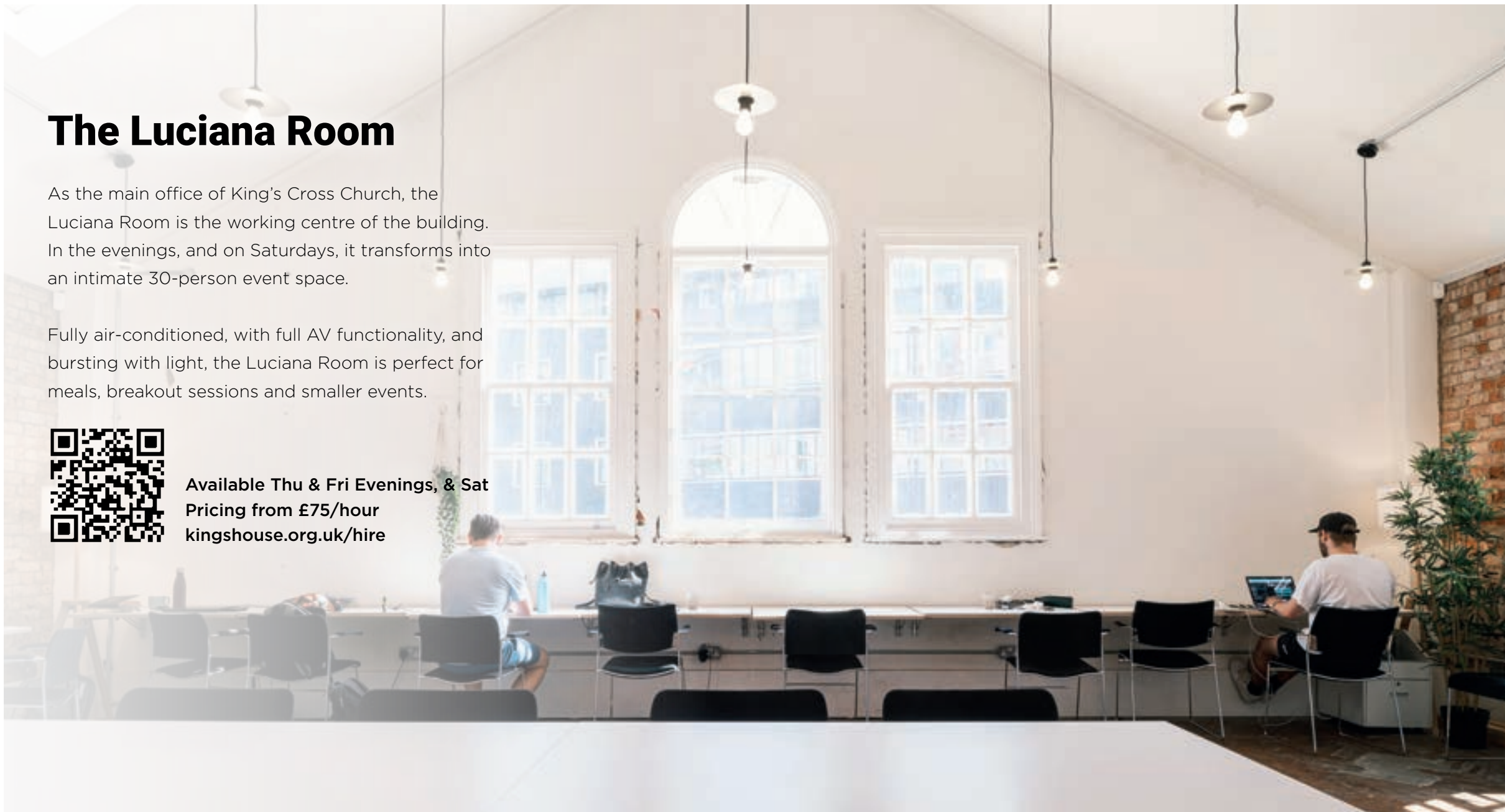

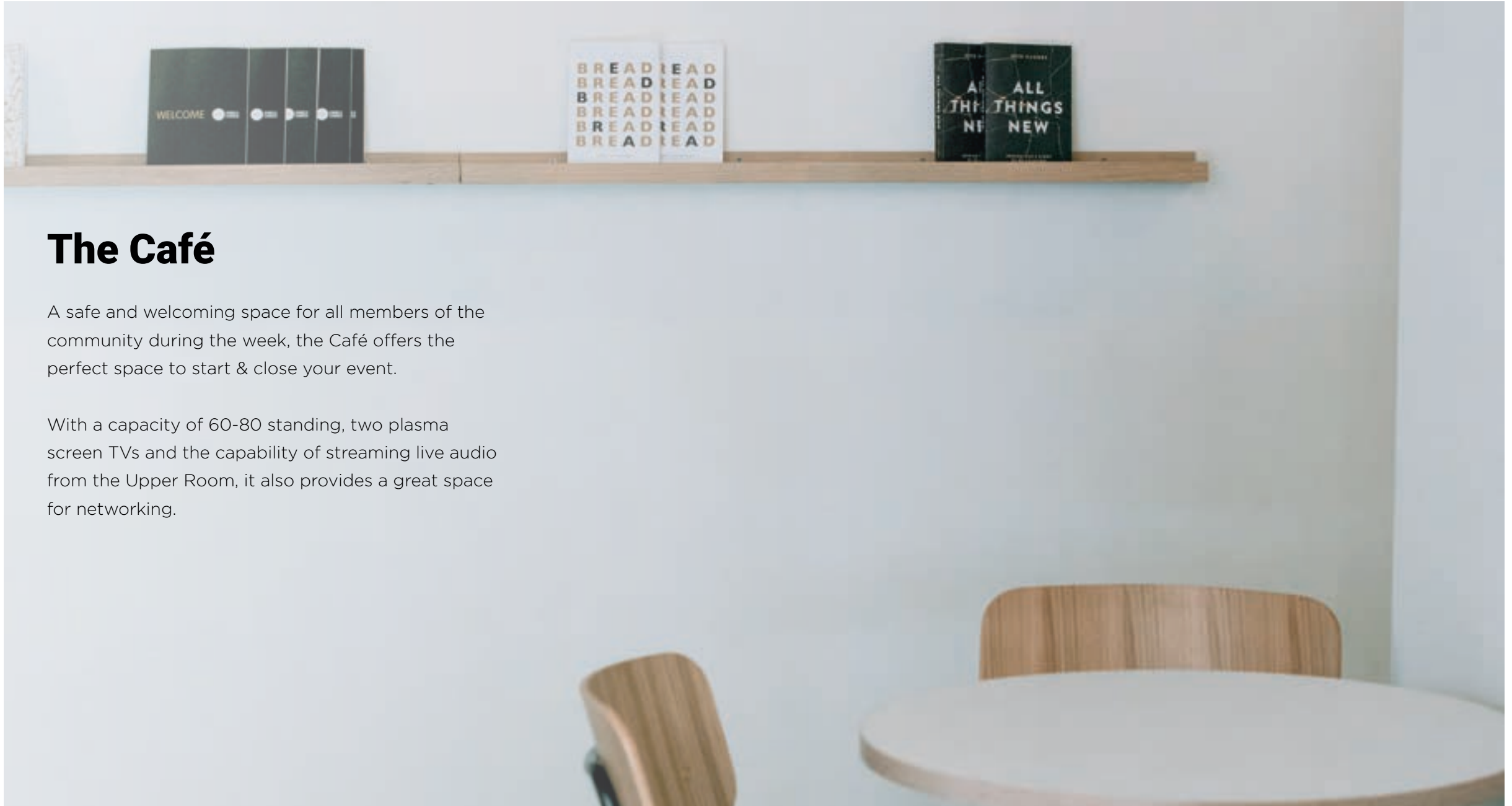

## The Café

A safe and welcoming space for all members of the community during the week, the Café offers the perfect space to start & close your event.

With a capacity of 60-80 standing, two plasma screen TVs and the capability of streaming live audio from the Upper Room, it also provides a great space for networking.



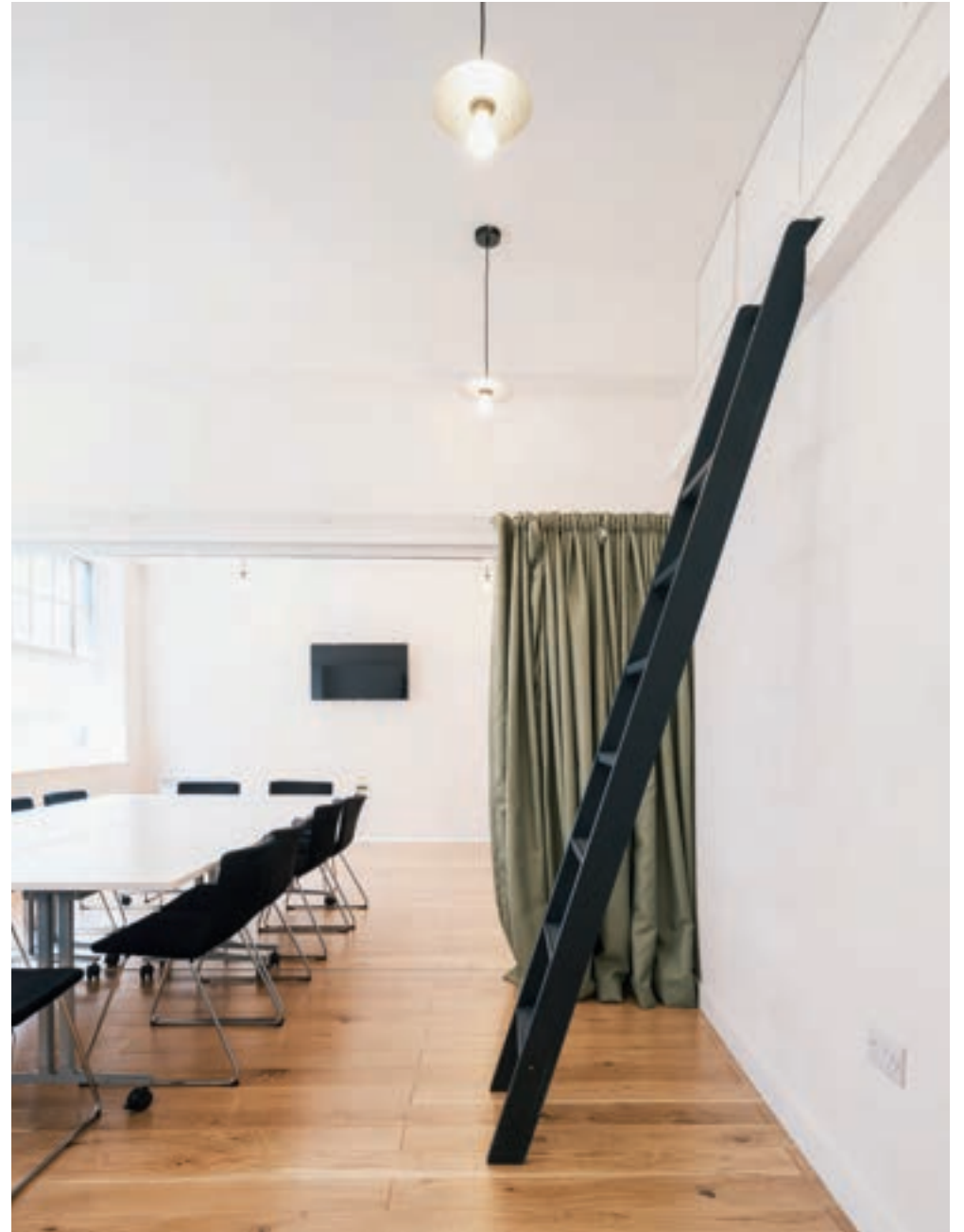

# Technical Specifications & Live Streaming

King's House was a runner-up for Best Venue for Hybrid Events at the London Venue & Catering Awards 2022.

The Upper Room is fitted with a high-class Audio & Visual system capable of hosting a wide range of events. Our in-house technicians can stream your event via any streaming platform, as well as integrating Zoom, in high definition.

## Audio

- Allen and Heath SQ7 mixing desk (front of house) & a SQ6 mixer for broadcast audio
- DANTE distribution including 2x 16x8 stage boxes
- 32 channel digital multicore
- 4x D&B YP10 front of house
- 2x D&B Y series subwoofers
- D&B 20D & 10D amplifiers
- Sennheiser EW100 wireless microphones
- Various wired microphones (including Neumann, AKG, Shure)

## Lighting

- Chamsys QuickQ 20 lighting desk
- 6x Chauvet Freedom Hex battery Uplights
- 6x RGBAWUV Moving Head Lights
- 10x Chauvet EVE140 PAR variable white lights

## Visuals

- BlackMagic ATEM 4 M/E Constellation HD
- Mac Mini M1 with ProPresenter 7
- 2x 65" LED TV's
- Relay screens in other rooms
- Dedicated Zoom computer
- Apple TV
- On-stage HDMI input

## Live Streaming

- 4x Blackmagic pocket 6k cinema cameras
- Blackmagic WebPresenter HD
- Dedicated 100MB up/down leased-line internet

Extra technical support, or heavy use of the equipment, may incur an extra cost. Please discuss this with a member of the team.

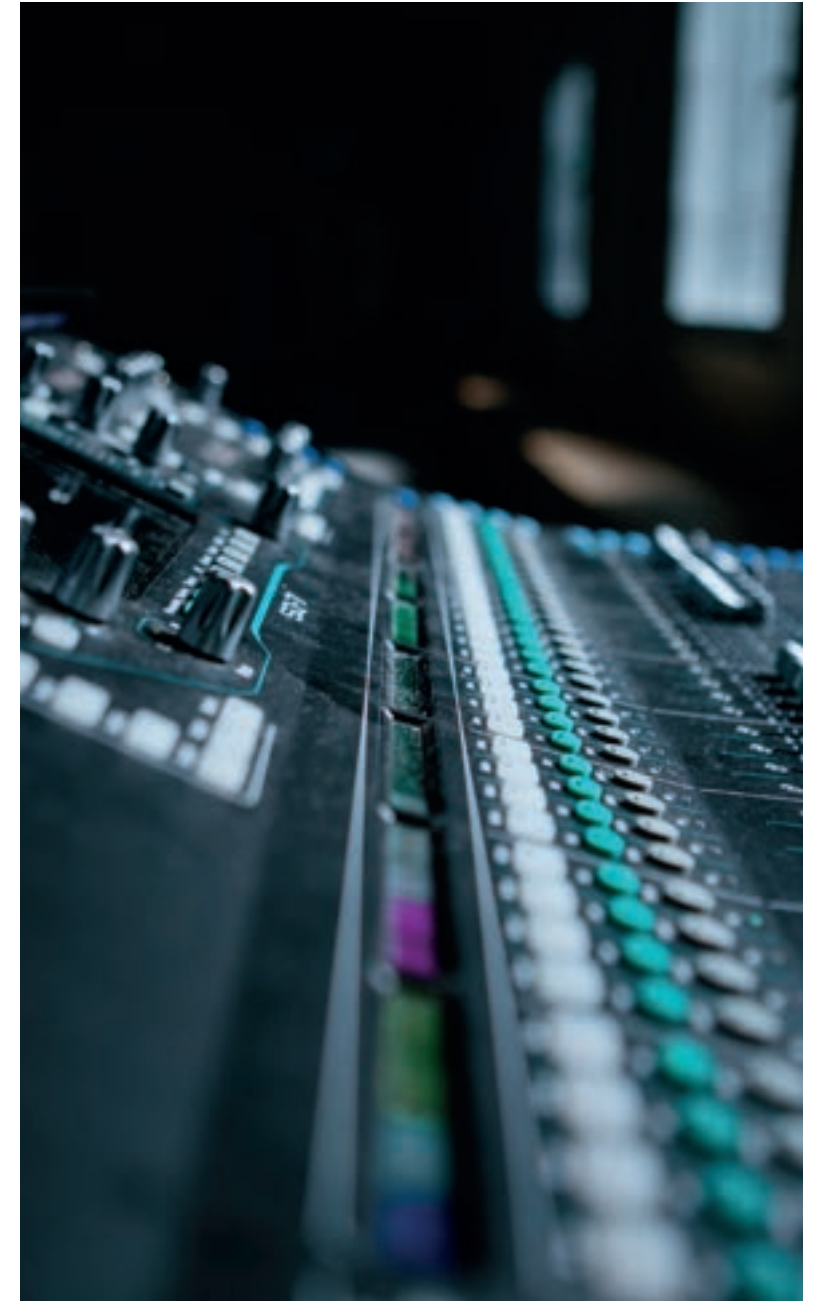



## Your Impact

All profits from King's House help to support our charity partners who operate from the space during the week.

A 1-hour booking of the Upper Room will help:

- 1 family get a 30-minute therapy session with Growing Hope
- 2 parents gain access to the Choices clothing boutique
- Give people 4 mediation & conflict training sessions with Crux
- Someone access a 20-minute debt counselling session with CAP



CAP offers free debt to help to anyone experiencing debt - no matter how big or small. CAP can support individuals in debt or struggling with financial hardship through 1-on-1 or group support sessions.



Choices provides emotional and practical support to women through a pregnancy crisis and beyond. The Choices Boutique supports parents by providing free pre-loved baby and toddler clothing and equipment, and offers other services such as befriending and counselling.

## crux

Crux help people hold better conversations so they can lead less stressful, more peaceful lives. They do this through training, facilitation, mediation and coaching for individuals, organisations, businesses and communities.



Free occupational therapy, speech and language therapy, counselling, music therapy, and more, for children with additional needs in Camden and Islington. Growing Hope support all families, whether they have a diagnosis or not, also offering groups for parents and siblings.

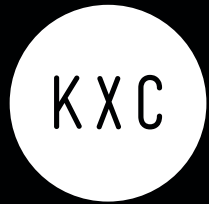

[kingshouse.org.uk/hire](https://kingshouse.org.uk/hire)  
[hire@kingshouse.org.uk](mailto:hire@kingshouse.org.uk)

Photos: Fred Howarth [fredhowarth.com](https://fredhowarth.com)  
Design: Union Studio [unionstudio.co.uk](https://unionstudio.co.uk)

