

| SOHO |

| MARYLEBONE |

| MIAMI |

EVENTS

CHOTTO MATTE

BROCHURE

| TORONTO |

| SAN FRANCISCO |

| DOHA |

C

O

T

E

N

Introduction

Nikkei Cuisine

Menu Highlight

Event Spaces

The Lava Lounge

Bar And Lounge

Main Floor

Itamae

First Floor

Claude's

Exclusive Hire

Bespoke

Contact

N

T

EVENTS

AND



PRIVATE

HIRE

INTRODUCTION

Nestled within the heart of London's eclectic Soho district, Chotto Matte stands as an unrivalled icon of culinary innovation and cosmopolitan allure.

Revered for its groundbreaking Japanese Peruvian Cuisine, meticulously curated cocktails and an ambiance that sparks with magnetic energy, this is no ordinary dining destination - It's an immersive journey for the senses.



Step into the dynamic world of Chotto Matte, where our versatile event spaces stand ready to put on the perfect backdrop for your occasion. Whether it's a power lunch, an intimate dinner, or an exclusive celebration, our two-floor restaurant offers a tailored experience like no other.

Marvel at our chic contemporary interior, from the bold graffiti adorning our walls to the captivating theatrics of our Open Sushi Counter and the Robata grill, every corner tells a story.

NIKKEI



CUISINE

Nikkei Cuisine is a unique culinary fusion that blends Japanese cooking techniques together with traditional Peruvian ingredients.

At Chotto Matte you can expect a showcase of elevated Japanese Peruvian cuisine, artfully plated to perfection.

Combining these culinary traditions with locally sourced ingredients, internationally renowned Executive Chef Jordan Sclare takes an artistic approach, always keeping excellence at the forefront.

A celebration of fresh, local, high-quality ingredients, Chotto Matte is dedicated to providing an authentic, eco-conscious experience – working with producers who prioritise ethical farming practices.

MENU



HIGHLIGHT

Miso Soup ^{GF}

Tofu, spring onion, wakame, bonito

Padrón Peppers ^{VG GF}

Spanish sweet peppers, den miso

Yellowtail "Nikkei Sashimi" ^{GF}

Cherry tomatoes, jalapeño, coriander, yuzu truffle soy

Nikkei Gyoza

Pork & prawn dumplings, yuzu sweet potato purée, red pepper ponzu

Sato Maki

Sea bass, salmon tartare, romano pepper, Chotto soy

Nobashi Ebi Tempura

Prawn tempura, red onion, coriander, ama su ponzu

Asado De Tira ^{GF}

Slow-cooked braised beef short rib, purple potato purée, teriyaki jus, chives

Pollo Anticucho ^{GF}

Coriander causa, chives, aji amarillo

Sesame Soy Broccoli ^{VG GF}

Red chilli, coriander

Arroz Blanco ^{VG GF}

Steamed white rice

Kuro Goma Ice Cream

Black sesame ice cream, toasted almond, chocolate sauce



EVENT



SPACES

THE LAVA

LOUNGE



Situated on the ground floor, the Lava Lounge offers refined exclusivity, with a semi-private enclave that is perfect for those more intimate gatherings.

This area seamlessly integrates with the dynamic ambiance of the wider restaurant and bar. Whether hosting a sophisticated dinner or an elevated drinks affair, the Lava Lounge provides an ideal setting for refined social occasions.

Capacity
Seated: 60
Standing: 80

BAR AND LOUNGE

For those seeking a vibrant setting with drinks and Nikkei style bites, the Front Lounge at Chotto Matte provides a perfect choice.

Situated on the main level floor, guests can immerse themselves in the ambiance of the restaurant while enjoying their exclusive space.

In the summertime, we encourage guests to expand their event onto our outdoor terrace, providing the ultimate environment for an al fresco dining or drinking experience on Soho's lively Frith Street.

From Thursday to Saturday Chotto Matte offers the added allure of captivating beats from underground DJs, providing a dynamic soundtrack to elevate each experience.



Capacity
Standing: 70

MAIN



Capacity
Standing: 150

FLOOR

Celebrate in style with full access to Chotto Matte's main level floor, available for exclusive hire.

Dive into the complete Nikkei experience within a diverse space, adaptable to any occasion. A coveted choice for both larger corporate or social gatherings, Chotto Matte's main level floor transitions between both standing and seated events.

Comprising an expansive dining and lounge area and a cutting-edge DJ booth system, this space ensures an unforgettable experience for all.

ITAMAE

Ascend to the Itamae dining area, a semi-private space nestled on the first floor, designed to accommodate up to 40 seated guests.

Guests dining in the Itamae are surrounded by the captivating theatrics of the Open Sushi Counter. For those seeking a more secluded experience, an optional partition can be arranged, transforming the space into an exclusive segment.

Live Chef and Open Sushi Counter demonstrations are available upon request, offering an elevated dining experience.



Capacity
Seated: 40

FIRST



FLOOR

Available for exclusive hire, the first floor of Chotto Matte is perfectly suited for hosting special occasions, business networking events and corporate dinners.

Take in the theatrics of the Open Sushi Counter and watch the flames on the Robata grill flicker with fervour. With a dedicated team of staff on hand ready to assist, each detail of your event is expertly managed and a range of bespoke personalised touches can be arranged.

Capacity
Seated: 140
Standing: 200

CLAUDE'S

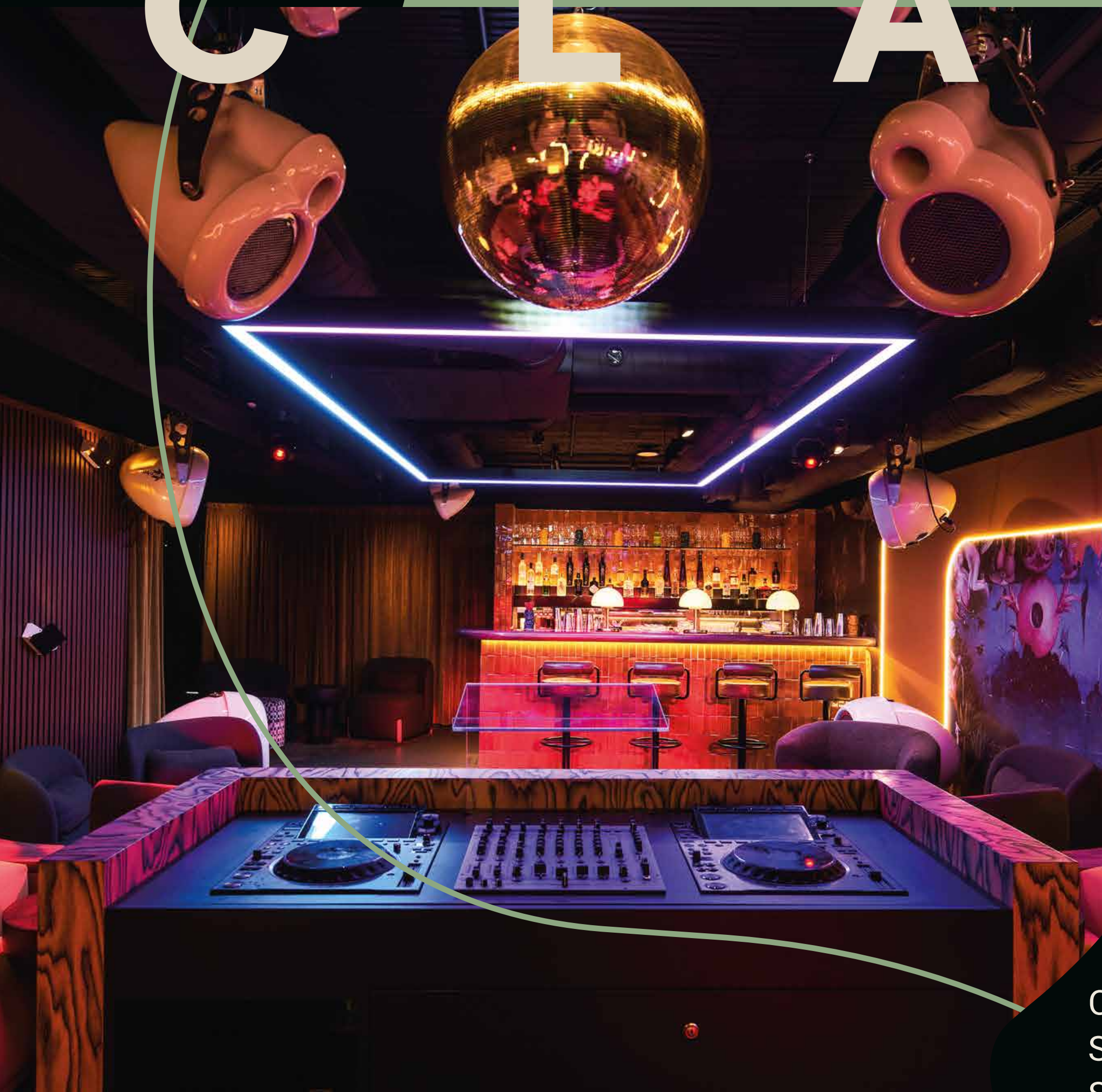

Capacity
Seated: 20
Standing: 50



Situated in the heart of Soho and tucked away below Chotto Matte, Claude's commands attention with its striking aesthetics and provides an enclave of edgy sophistication hidden from the crowd.

Whether you're hosting a high-energy party, a networking event or an intimate private dinner, Claude's provide the ideal setting.

Available for exclusive hire, the elusive space at Claude's features a cutting edge DJ booth and speaker system. Featuring a private, fully stocked bar and ambient-adjustable LED lighting, Claude's makes the perfect event space for those seeking an intimate party experience like no other.

EXCLUSIVE

Chotto Matte is a multisensory experience – delighting diners with a thrilling visual journey that unfolds through the space. Available for full exclusive hire, unleash the full potential of the space when hosting with us.

Accommodating up to 140 seated or 400 standing guests, Chotto Matte offers diners an electrifying experience, from the masterful precision of the chefs to live entertainment and curated beats from leading underground DJs.



Capacity
Seated: 140
Standing: 400

HIRE



FLOOR PLAN

THE LAVA LOUNGE

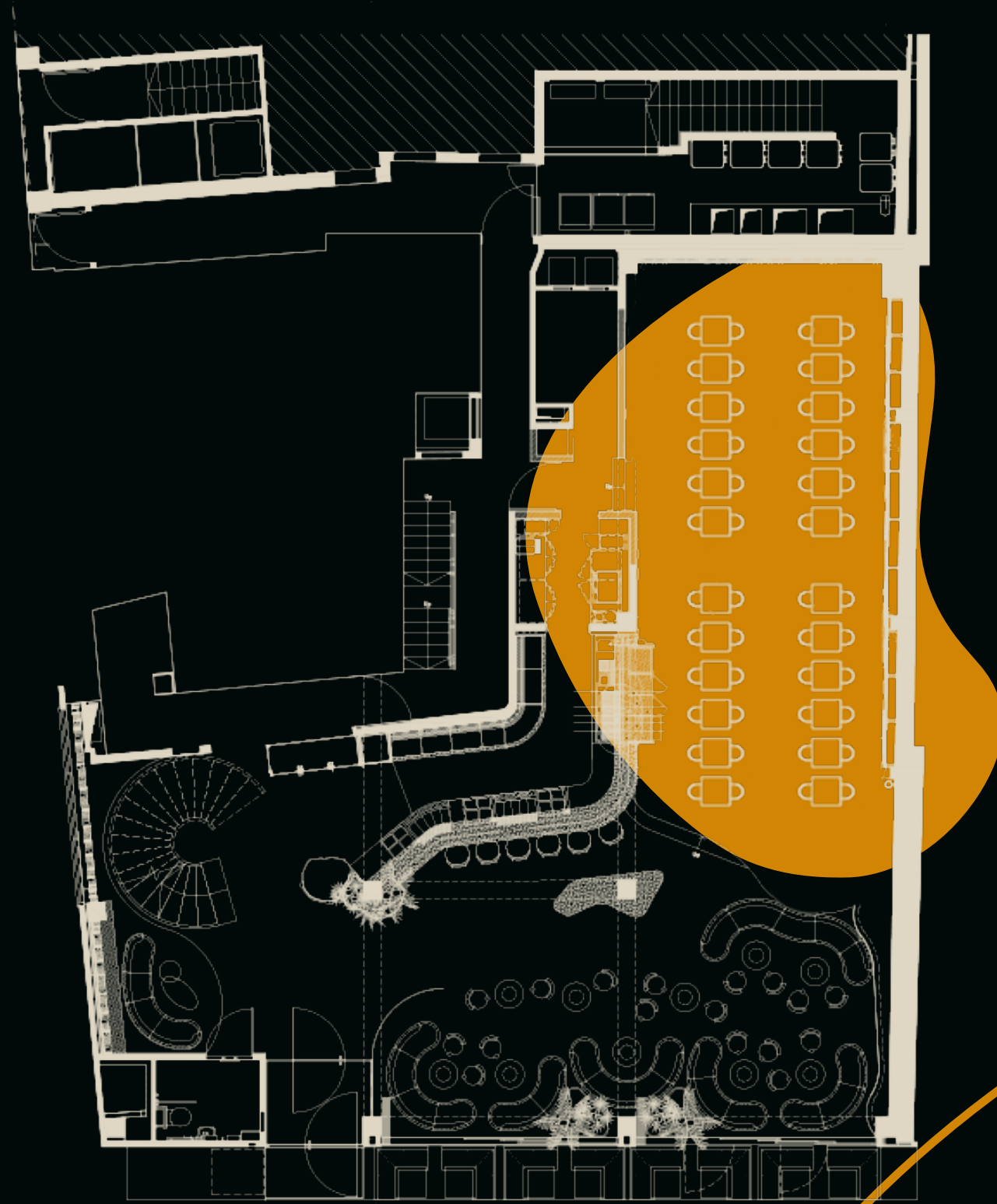

Capacity : Seated: 40 / Standing: 60

BAR AND LOUNGE

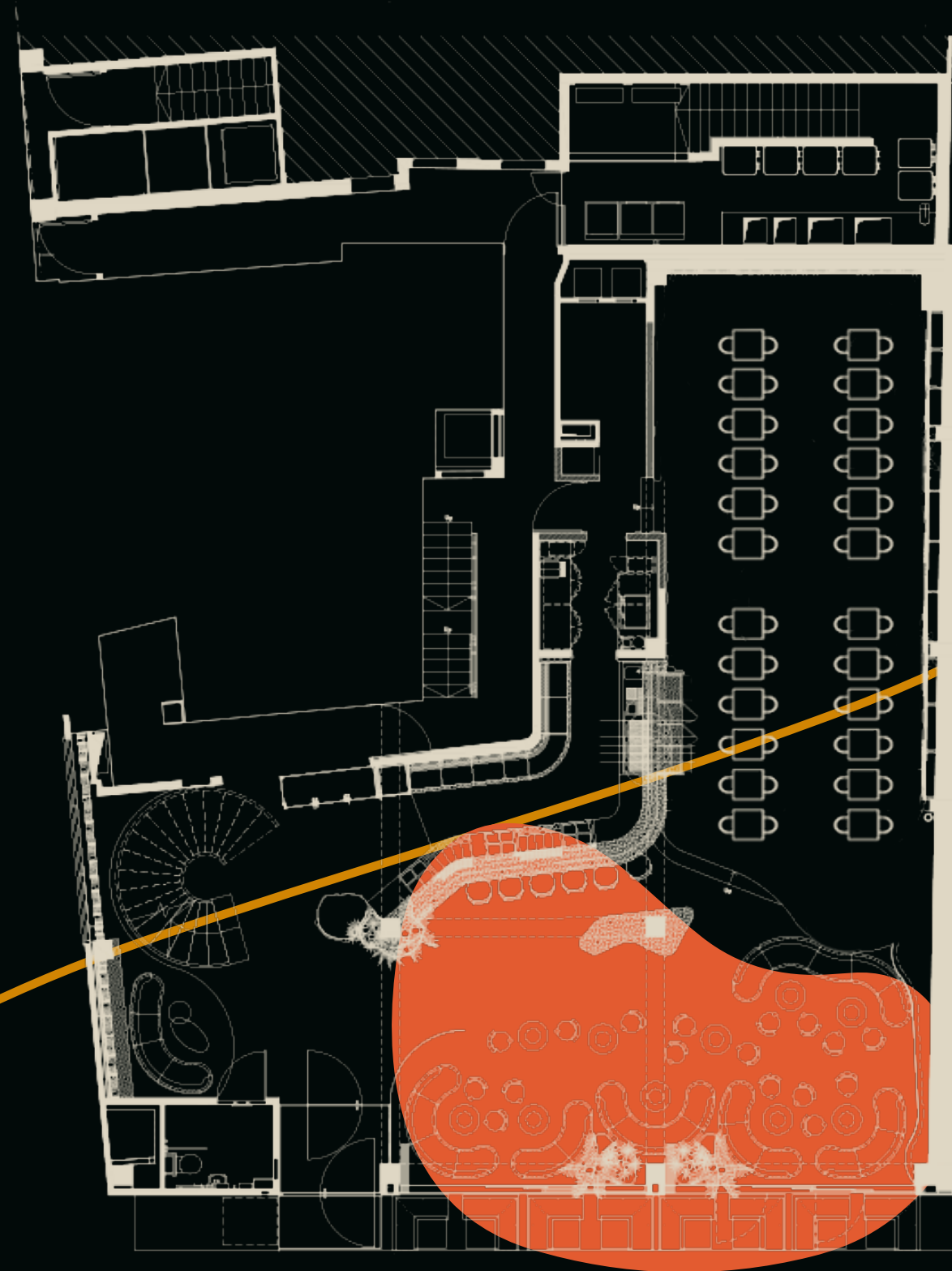

Capacity: Standing: 60

MAIN FLOOR

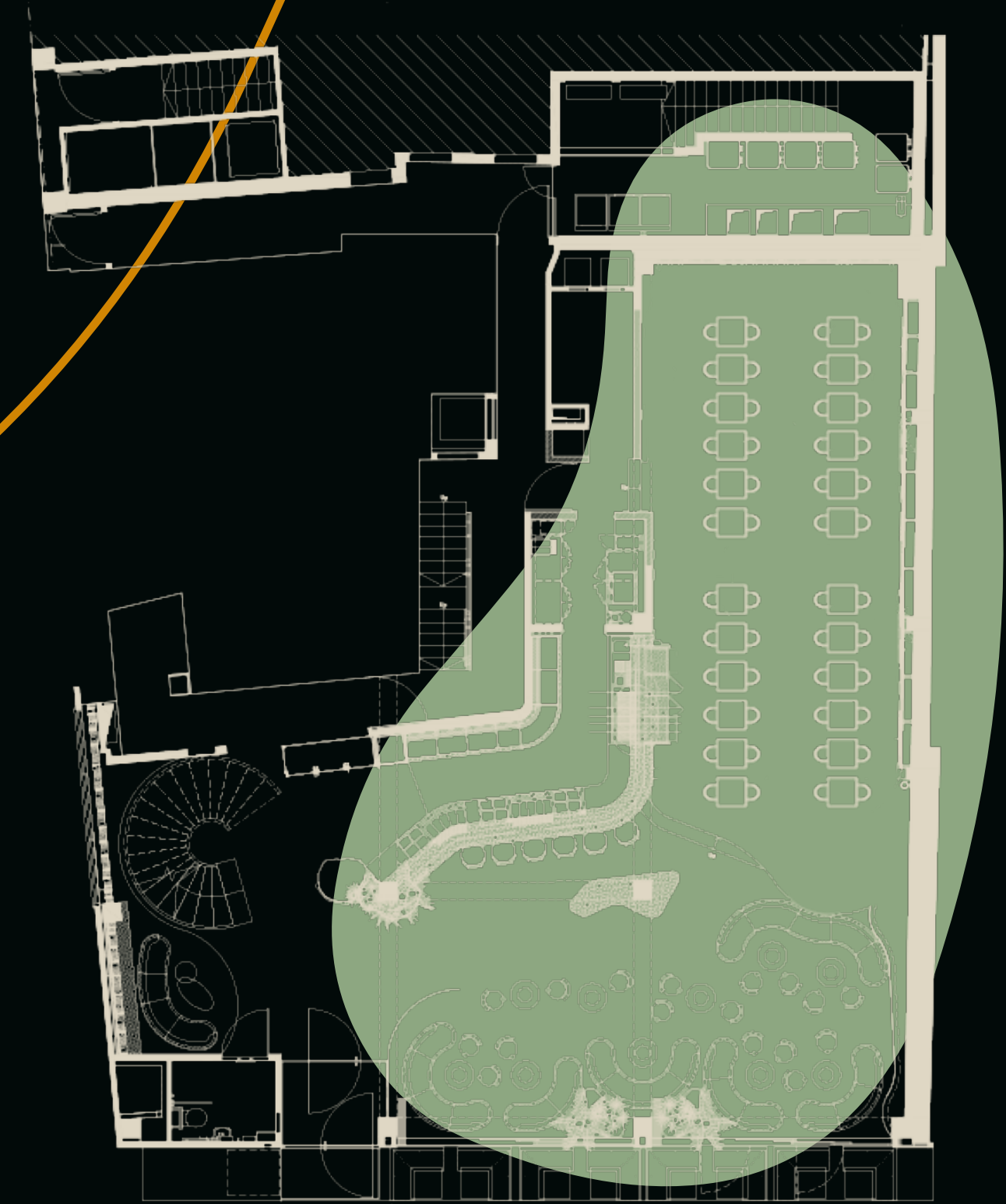

Capacity: Standing: 120

FLOOR PLAN

I T A M A E

FIRST

FLOOR

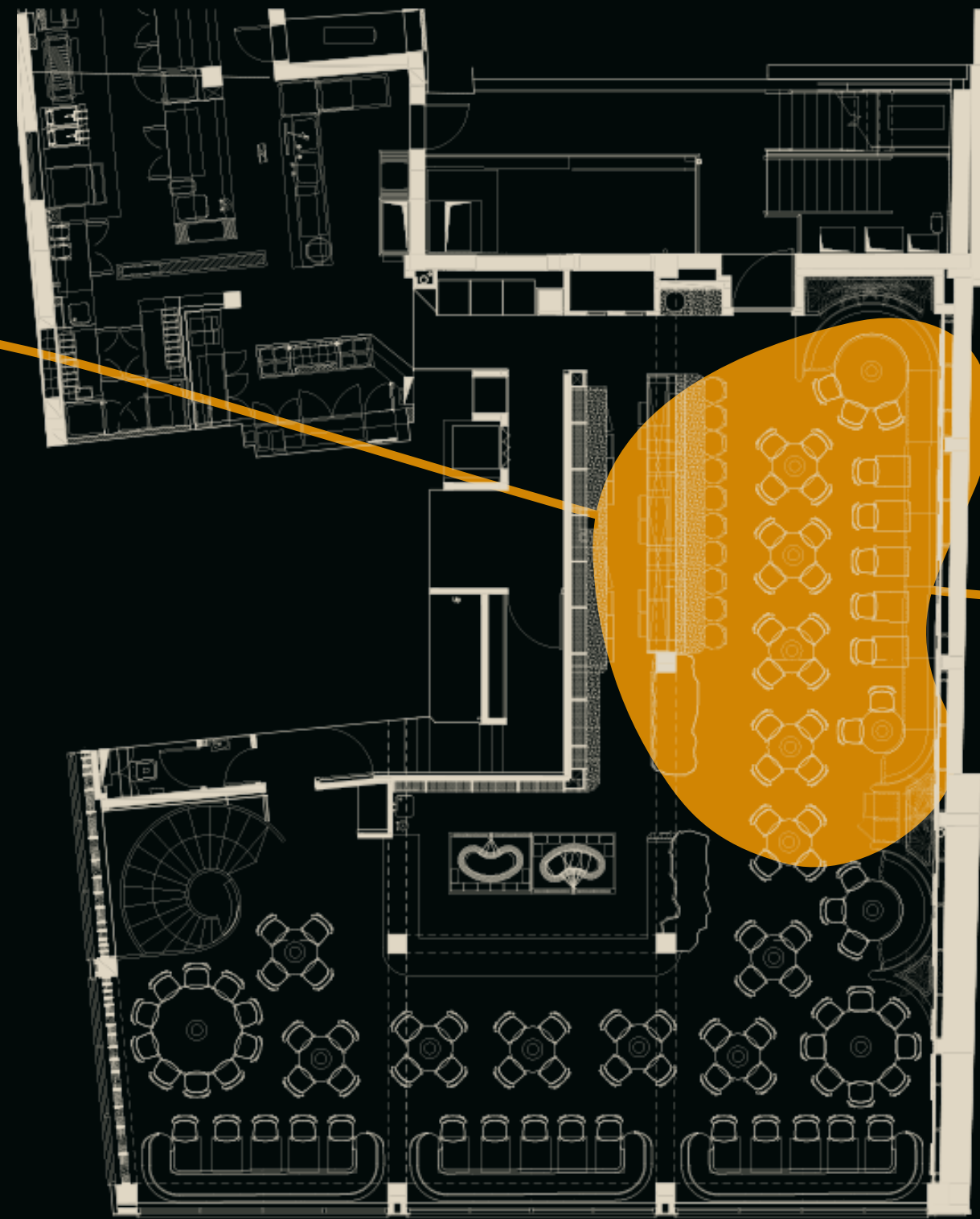

Capacity : Seated: 40

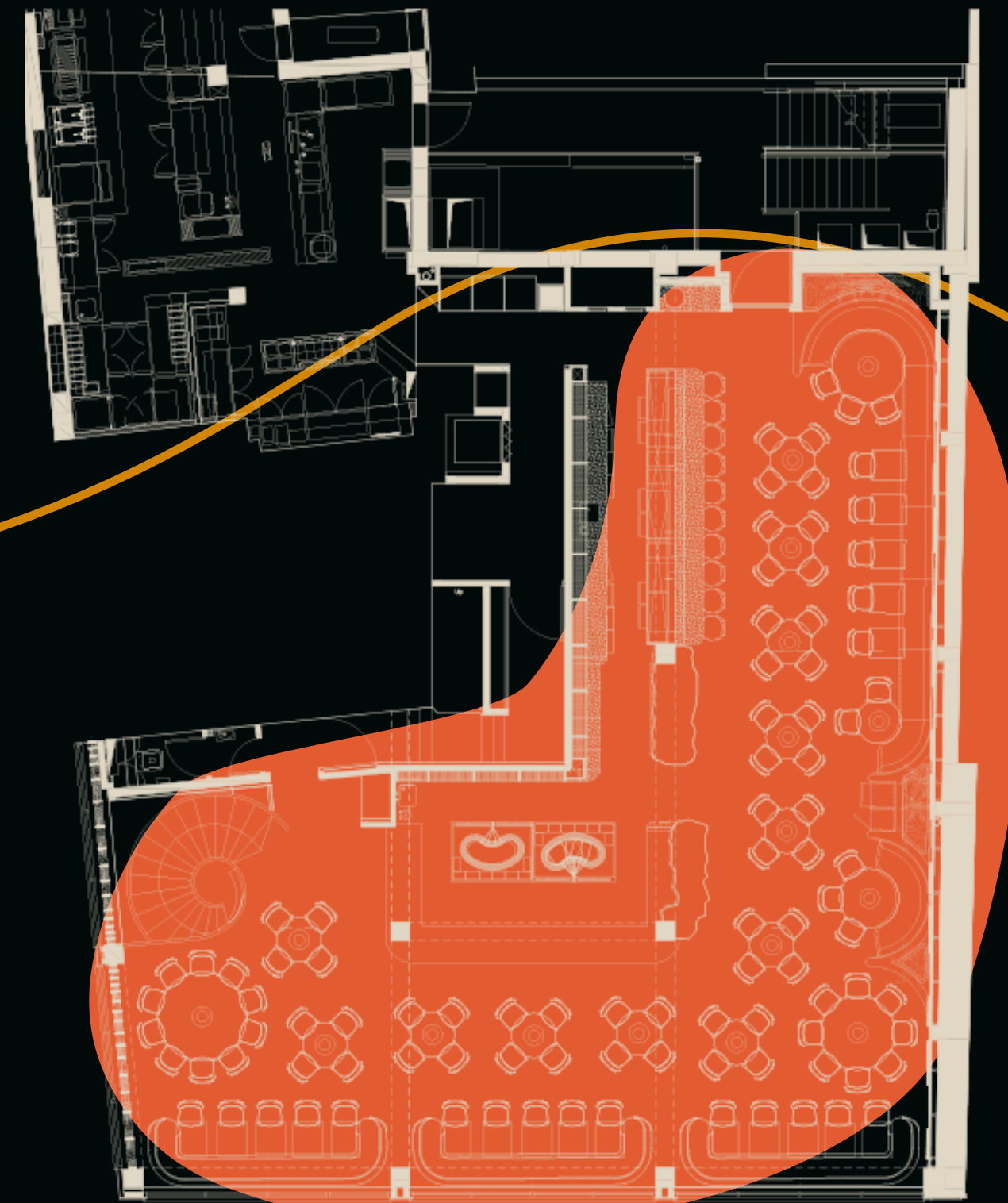

Capacity : Seated: 140 / Standing: 200

B E S P O K E



Our dedicated team are on hand to elevate your event with customisable menus, personalised soundtracks, floral arrangements and bespoke table design to create a truly memorable experience.

Should you require specific production or extras please share these details with our seasoned event team who will be happy to discuss your options and coordinate accordingly.

For all event enquiries, please contact our dedicated events team on

E: jane@chotto-matte.com

T: 020 3146 7844



Chotto Matte:
11-13 Frith Street, Soho W1D 4RB