

MEETINGS & EVENTS  
SPACES TO SUIT

MERCURE  
HOTEL

LONDON EARL'S COURT

---

# A REMARKABLE LANDMARK VENUE

For events that really stand out.

The London Suite is the most flexible large conference and event space in west London. Here you really can think big - conference, expo, awards ceremony, AGM, party or rally. The ultimate 'machine for meeting in'.

Our purpose-built landmark events space, with modular and mood technology, connected breakout rooms, branded hospitality and two hotels plugged directly into the building London Suite is ready to serve any eventuality.

London Suite can adapt to any event. It can be ingeniously divided to create a tailored conference or meeting space layout that perfectly fits your venue wants and needs. Let your imagination and creativity turn your event from a blank canvas into an unforgettable experience.



*Open up a world of possibilities to any event and experience one of the most versatile ballrooms in London.*



---

## SCALE-UP YOUR AMBITIONS

It's showtime.

Our London Suite is the most versatile ballroom and can be cleverly partitioned to form a range of different room sizes. It boasts over 1,200m<sup>2</sup> of space and is the most ideal choice, whether you are looking for an exhibition space, a meeting, an award ceremony, Christmas party or a conference venue in London.

In addition to our landmark ground floor space, we also have 5 further newly refurbished Mercure meeting rooms on the 2nd floor of the hotel. The largest of these accommodates up to 50 guests in theatre style. There are 3 well-appointed 'Park' rooms that can be configured for up to 12 people in boardroom style (one with an attached lounge area) and a further room suitable for up to 8 guests.

*Modular spaces to host plenary conference sessions or set an amazing décor for an evening dinner.*

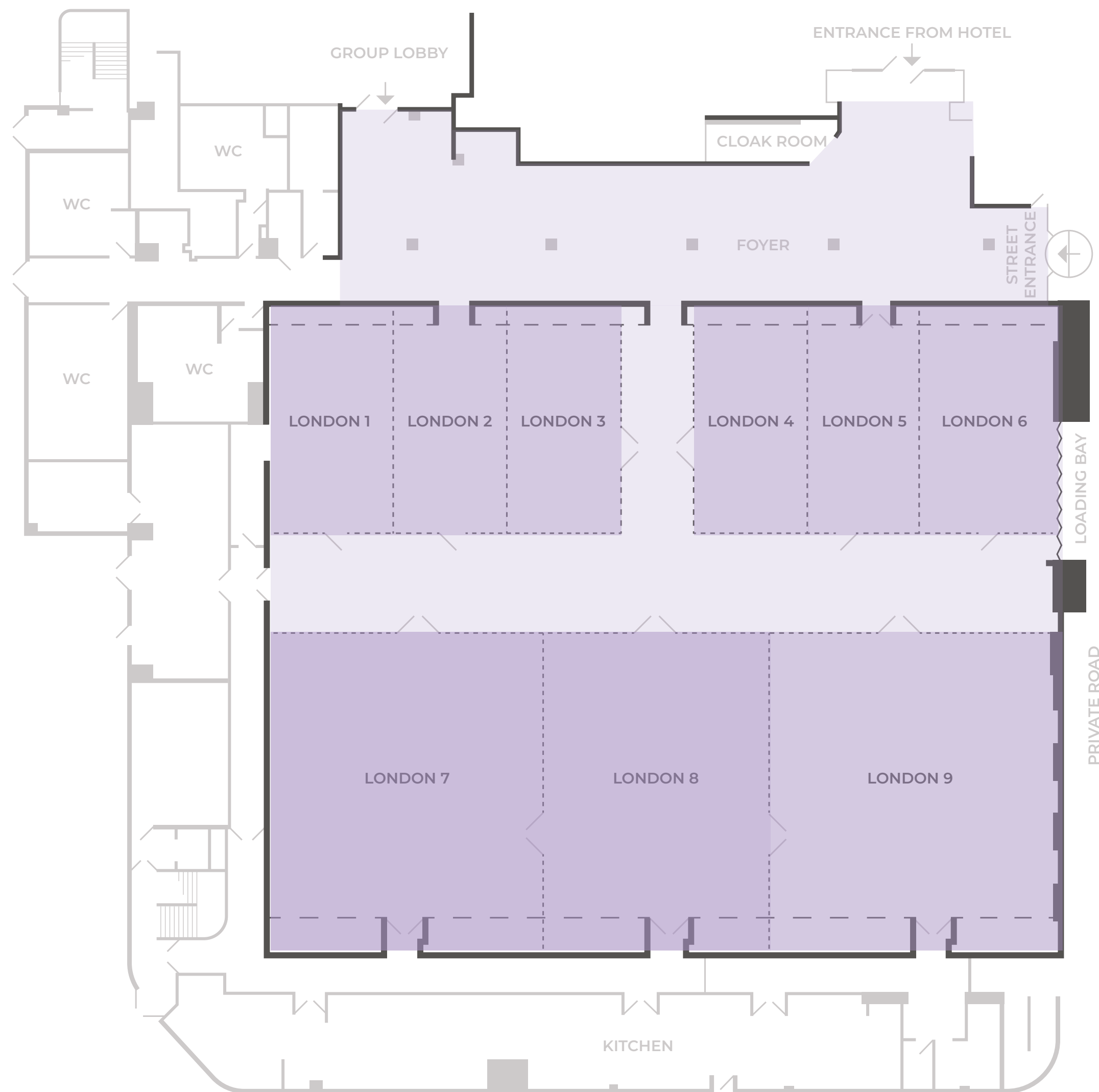

  
**1,260**  
 Sqm of space

  
**1,200**  
 Guest capacity

## MODULAR SPACE

### Capacity

ROOM NAME	THEATRE	CABERET	CLASSROOM	ROUND DINNER	ROUND DINNER DANCE	RECEPTION
London Suite	1,200	640	750	800	800	1,200
London Foyer	-	-	-	-	-	250
London 1/2/3/4/5/6	60	32	24	40	-	60
London 7	200	96	80	140	100	200
London 8	160	80	60	100	70	160
London 9	200	96	80	140	100	200
London 1+2+3 / 4+5+6	140	104	70	130	80	150
London 7+8	400	180	150	220	180	400
London 7+8+9	550	384	250	400	300	550

Click Room to view more



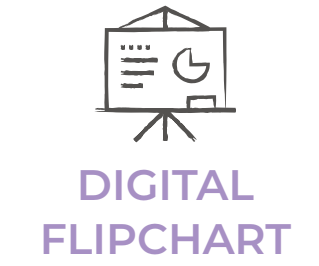
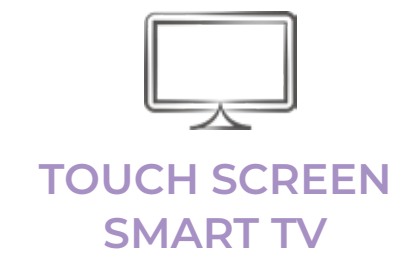

## SPACES TO MEET

On our 2nd floor, newly refurbished Ibis guestrooms and Mercure meeting rooms meet. This is great for breakout sessions from events on the ground floor and gives smaller residential groups the opportunity to book the meeting rooms and the 2nd floor guestrooms - providing exclusivity, privacy and security for high-profile sports teams, entertainment tours or VIP clients.

The diverse portfolio of London Suite meeting and breakout spaces along with the hotel bedrooms on the 2nd floor provides an ideal self-contained solution for residential seminars for 30 to 50 people. Walking to a meeting room after waking up has never been so efficient!



### Capacity

ROOM NAME	THEATRE	CABERET	CLASSROOM	ROUND DINNER	BOARDROOM	ROUND DINNER DANCE	RECEPTION
Hyde Park	50	40	25	40	35	80	80
Regents Park	12	-	-	-	10	15	12
Victoria Park	12	-	-	-	10	15	12
St James' Park	-	-	-	-	8	-	8
Greenwich Park	-	-	-	-	10	-	12

[Click Room to view more](#)

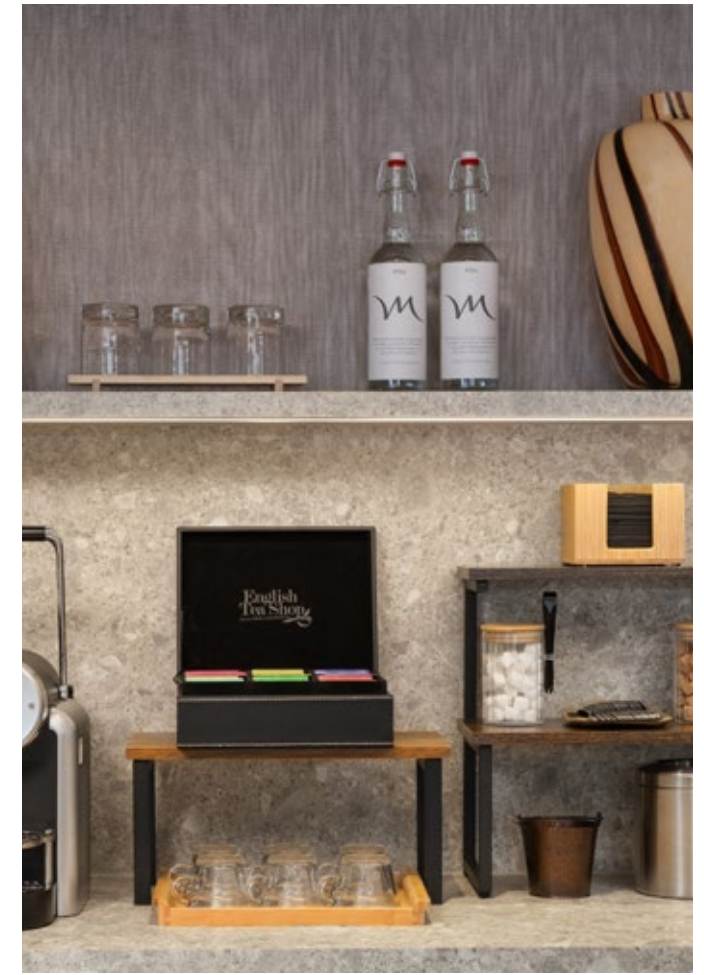



---

## EVENT PLANNING FOR SUCCESS



---

## TURN YOUR EVENT INTO AN OCCASION

Making it all happen.

We understand that two events or two clients are never the same and that always includes their taste in hospitality. Our experienced head chef will apply his passion for food into a uniquely themed cuisine for any event. Sample menus are tailored to the client request and personal preferences.

From a private birthday to a larger banquet, the London Suite has a range of spaces to suit your social event. Whether it's a birthday dinner or a contemporary anniversary, we can offer private rooms or a semi-private area in Barnaby's Lounge & Bar. Our pillar-free ballroom and is ideal for hosting gala dinners or wedding receptions for up to 800 guests while the high ceiling will allow the most ambitious staging set-up.

As an award-winning team, we pride ourselves in delivering a unique, supportive, collaborative and competitive event experience right in the heart of west London. What's not to like, why not discuss your next event with us.



---

# DELIVERING EVENTS

## Conferences

The London Suite is the most flexible large conference and event space in west London. The main event hall can be partitioned to form a range of different room sizes, and the in-built creative lighting produces a dazzling night ambiance. All divisions have a building management system equipped with sensors to allow pre-programmed air conditioning, sound levels, lighting to create a perfect ambiance.

The venue is also fitted with 1GB fibre optic line dedicated to the events space which allows capturing a high number of cyber security events and IT sector. For corporate hospitality events, we can accommodate parties of 20 to 800 for sit down events. The venue also hosts a dedicated banqueting kitchen to answer the requirement of any hospitality event. Additionally, the kitchen can be hired-out for self-catering events.

Being an open space, anything can be built-up from mobile bar, dance floor, any entertainment features while our pre-function room can host any welcome drink for up to 250 guests.

Whether you are looking for an exhibition space, a meeting, an award ceremony, a corporate summer, Christmas party or a conference venue in London, our award-winning team will be certain to deliver the event you need and want.

## Exhibitions

Whatever your exhibition requirements are, our London Suite can accommodate them. Our spacious flexible exhibition hall offers lofty ceilings and an uninterrupted area to display your exhibits. Set-up and other logistical matters are simple, with 24-hour access to our generous ground-floor loading bay, which has previously welcomed double-decker buses, cars, and even a tank (without a cannon)! The London Suite can also stage a TV event or become a sporting venue.

## Galas & Weddings

For galas and weddings, London Suite offers a capacious pillar-free ballroom and is ideal for hosting award ceremonies, gala dinners or wedding receptions. Spacious enough the ballroom caters for up to 800 guests while the high ceiling will permit the most ambitious set-up.

## Business meetings venue

On our second floor, the smaller syndicate meeting rooms can accommodate from 2 people to 50 and are ideal for board meeting, training, hospitality lounges or break-out rooms.

## Social Events & Celebrations

From a private birthday to a larger banquet, the London Suite has a range of spaces to suit your social event. Whether it is a birthday dinner or a contemporary anniversary, we can offer private rooms or a semi-private area in Barnaby's Lounge & Bar.

## Product Launches

At Mercure Earl's Court we have a very useful loading bay which easily facilitates vehicles and large props access to the venue for large scale product launch type events.



---

## ACCESS ALL AREAS

Purpose built, efficient logistics.

Many clients love how easy loading and unloading is made with our ground floor loading bay and direct easy access into the London Suite foyer. We have had a red double decker bus, a black cab, a tank and fancy cars drive into our venue through the ground floor loading bay. Being a pillar free venue with 5-metre-high ceilings, the venue has been used as a blank canvas for showcase dinners with a jungle theme (rolling out their own carpet!), a dinner with a beach theme (with their own beach bar and palm trees), for international concerts and for a boxing event.

When it comes to combined conferences and exhibitions the adaptability of London Suite encourages clients to book way in advance. Regardless of which side sells better or if breakouts are needed, the space can be redesigned and constantly adapted to the ever-changing clients' briefs as the event dates approaches.





## LONDON SUITE PACKAGES

### Full Day Delegate Rate

Prices start from £79/person inc VAT

- Room Hire
- 3 servings of Tea & Coffee with Snacks  
*(Arrival, mid-morning and mid-afternoon)*
- Three Course Fork Buffet Lunch
- Still & Sparkling water
- Paper, Pens and Stationary box
- LED Lighting System with AV  
*(Projector, Screen, Microphone and Flipchart)*
- WI-FI
- Cloakroom
- Private Entry
- Vehicle access to the room
- Dedicated event Co-ordinator
- Car Park *(Residential rates)*
- 1x security Officer

### Half Day Delegate Rate

Prices from £74/person inc VAT

- Room Hire
- 2 servings of Tea & Coffee with  
Pastries & Fruits *(Arrival & Mid Morning)*
- 2 Course Lunch – Chef Choice
- Still and Sparkling water
- Pads & Pens
- WIFI internet for all delegates
- Car Parking *(Residential rates)*
- Dedicated Event Coordinator

Lunch can either be served in London Suite or on 1st floor in Barnaby's.

# 2ND FLOOR MEETING ROOMS DAY DELEGATE RATE PACKAGES

## Full Day Delegate Rates

Prices start from £59/person inc VAT

- Room Hire
- 3 servings of Tea & Coffee with Snacks  
*(Arrival, mid-morning and mid-afternoon)*
- Three Course Fork Buffet Lunch
- Still & Sparkling water
- Paper, Pens and Stationary box
- In built AV included
- WI-FI
- Dedicated event Co-ordinator
- Car Park *(Residential rates)*

## Half Day Delegate Rate

Prices start from £54/person inc VAT

- Room Hire
- 2 servings of Tea & Coffee with Snacks  
*(Arrival and mid-morning)*
- 2 Course Fork Buffet Lunch
- Still & Sparkling water
- Paper, Pens and Stationary box
- In built AV included
- WI-FI
- Dedicated event Co-ordinator
- Car Park *(Residential rates)*

Lunch will be served on 1st floor in Barnaby's for both these DDR packages



---

# ADDITIONAL CATERING OPTIONS

## Unlimited Tea & Coffee Break

£14.00/person inc VAT

*(available for both London Suite & 2nd floor)*

## Sandwich Lunch

Price from £20.00/person inc VAT

*(available for both London Suite & 2nd floor)*

*Inclusion: Choice of meat/fish/vegetarian, crisps and fruit (we cater to vegan and halal requests)*

## Buffet Lunch

Price from £39/person inc VAT

*(available for both London Suite & 2nd floor)*

*Daily and seasonal menu available*

This can be served either in London Suite or Barnaby's





# DINNER AND DRINKS PACKAGE

## London Suite

### 1 Hour Drinks Reception

(selection of beer/wine/soft drinks)  
Starting from £29.00 per person

### 2 Hours Drinks Reception

(selection of wine/beer/soft drinks)  
Starting from £45.00 per person

### Canapes

6 items @ £32.00 per person

### Bowl Food

4 items @ £40.00 per person  
(hot only or with salad) £50.00 per person

### Buffet Dinner

2-course Buffet dinner  
Starting from £79.00 per person (inc VAT)

### 3-course Buffet dinner

Starting from £83.00 per person (inc VAT)

### Only Plated Dinner

2-course Dinner  
Starting from £89.00 per person (inc VAT)

### 3-course Dinner

Starting from £93.00 per person (inc VAT)

- Room Hire
- 1/2 bottle wine and 1/2 bottle water per person
- Dance floor
- Cloakroom  
(to be manned by the organizer)
- Petit Fours, Tea & Coffee

For a more tailor-made dinner package, please contact our meetings and events team.

Contact [h5623-sb@accor.com](mailto:h5623-sb@accor.com) for menus and further questions

*Barnaby's*  
kitchen & lounge

---

**DISCOVER  
THE TASTE**

*Introducing  
Barnaby's*



*Barnaby's*  
kitchen & lounge



---

## BARNABY'S LOUNGE BAR



---

## BARNABY'S KITCHEN

# GROUP DINING

*Group dining reservations available for parties of 10 to 180 guests*

Select from Barnaby's Kitchen or Barnaby's Lounge Bar.

Ideal for client lunches & dinners, after work get togethers, personal celebrations and social events of all kinds. Offering à la carte and a tailored menus to suit clients choice for any type of event.

## Barnaby's Kitchen

- Capacities: 150 Seated Lunch / Dinner. 180 Standing Reception
- Ideal for both corporate events and private celebrations in an upscale setting.

## Barnaby's Lounge Bar

- Capacities: 90 Seated Lunch / Dinner. 120 Standing Reception
- Ideal for after work drinks reservations & get togethers, smaller drinks & canape events

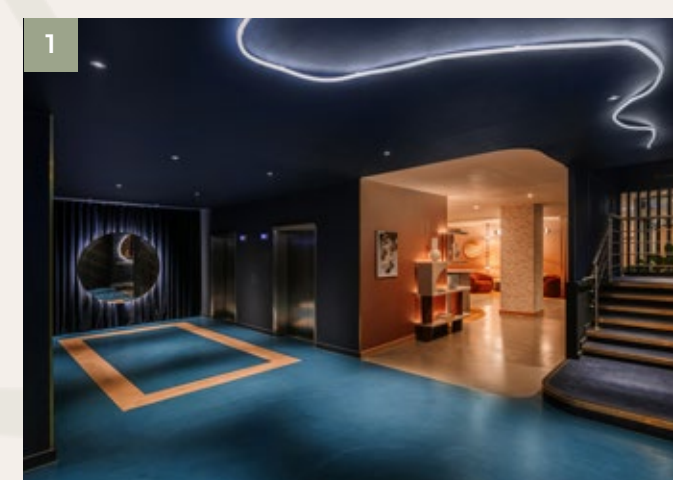

RESTAURANT & BAR ENTRANCE



WELCOME AREA



RESTAURANT AREA



BAR AREA



BUILT IN  
SCREENS AND  
PROJECTORS



UPTO 300  
GUESTS ACROSS  
BOTH OUTLETS



À LA CARTE  
& TAILORED  
MENUS



DISPENSE BAR  
FOR PRIVATE  
EVENTS



## GROUP DINING DINNER & DRINKS PACKAGES

### Drinks

1 hour drinks reception  
(selection of beer/wine/soft drinks)  
Starting from £29.00 per person

2 hours drinks reception  
(selection of wine/beer/soft drinks)  
Starting from £45.00 per person

### Canapes

6 items @ £32.00 per person

### Bowl Food

4 items @ £40.00 per person  
(hot only or with salad) £50.00 per person

### Dinner

2-course Dinner  
Starting from £45.00 per person  
(excluding drinks)

3-course Dinner  
Starting from £59 per person  
(excluding drinks)

Minimum spend for privatised events  
encompassing displayed packages  
or bespoke client packages.

For a more tailor-made dinner package, please contact our meetings and events team.  
Contact [h5623-sb@accor.com](mailto:h5623-sb@accor.com) for menus and further questions

*Barnaby's*  
kitchen & lounge



---

**COMFORT & JOY**

## CHRISTMAS AT LONDON SUITE

### *A new festive tradition*

Hosting a Christmas party at London Suite means experiencing the warmth and generosity of a great host. Our staff will ensure every guest feels special, offering comforting food and good wine in a relaxed, friendly setting.

Blending traditional British food with a modern twist and offering a unique culinary experience reflecting both London's rich heritage and its cosmopolitan flair. With a mix of small plates, mains, and sharing dishes, our menu is designed to cater to a wide variety of tastes for Christmas.

London Suite offers a cozy, welcoming environment that feels like a home away from home, ideal for a seasonal gathering where guests can feel relaxed and cherished. Not just a place to eat - it's a space to create memories. The comfortable 'home for the holidays' ambience your guests will enjoy here ensures that your Christmas party will be a memorable event.



# BUFFET CHRISTMAS

£55.00 PER PERSON (EXCLUDING DRINKS)

## Starter

Winter Spiced Parsnip Soup 🌱 🌾

Artisan Bread & Butter

Festive Charcuterie Board with Pickles & Focaccia Breads

Smoked Trout and Potato Salad

Roast Sweet Potato & Spanish Peppers & Walnut Salad 🌱 🌾

## Main

Roast Turkey with Sage & Onion Stuffing and Cranberry Jus Gravy

Truffle Gnocchi with Wild Mushrooms Sauce

Scottish Roast Salmon with Butternut Squash Pure & Aged Parmesan

Brussels Sprouts with Toasted Almonds

Carrots & Cauliflower Cheese Gratin 🌱

Roasted Rosemary & Thyme Potato

Pig in Blanket

## Dessert

Christmas Chocolate Gateaux with Spice Cream & Gingerbread

Malted Cappuccino Cheesecake

Mince Pie

Fruits Salad

🌱 vegetarian 🌱 vegan 🌾 gluten-free



# PLATED CHRISTMAS

£59.00 PER PERSON 3 COURSES (EXCLUDING DRINKS)

## Starter

Smoked Salmon and Beetroot

Gravadlax Parfait with a Watercress Soft Centre

Winter warm Quiche

Beetroot Carpaccio Vegan Cheese, Rocket & Crunchy Hazelnuts 🌱 🌾

## Main

Tenderloin Beef with Red Wine Pan Jus

Turkey Roulande Stuffed with Sage & Onion and Cranberry Jus Gravy

Christmas Vegetarian Wellington

(Vegan on request)

## Dessert

Chocolate & Gingerbread Tart topped with Gingerbread star

Winter Tiramisu Spiced Mandarin & Candied Orange

Truffle Chocolate Cake 🌱 🌾

🌱 vegetarian 🌱 vegan 🌾 gluten-free

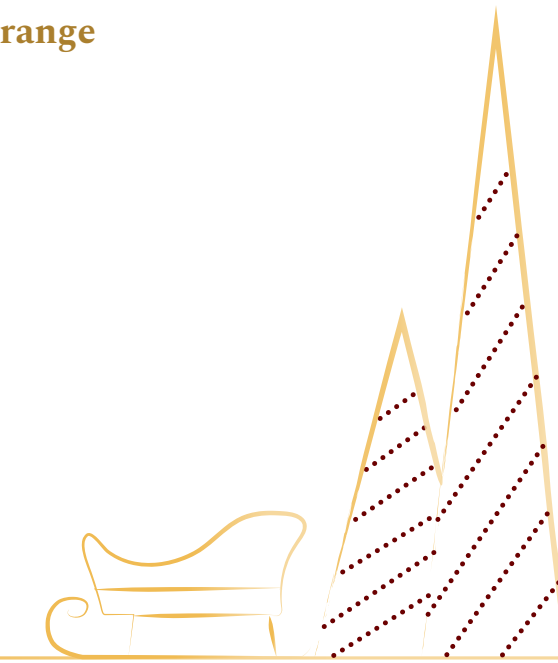



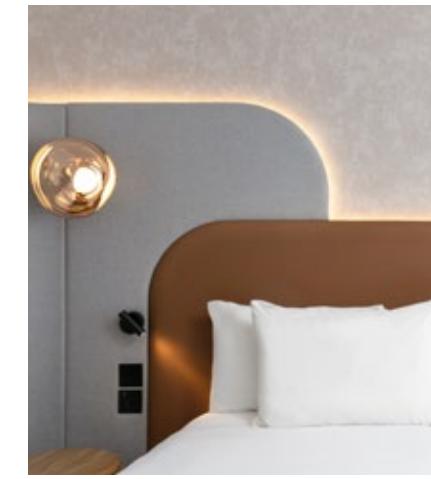

# STAYING WITH US AFTER AN EVENT?

Plan your event. Enjoy your evening.  
Rest in comfort.

Make the most of your celebration or gathering by staying just steps away at Mercure London Earl's Court. After a memorable event at Barnaby's Kitchen & Lounge Bar, enjoy the comfort, convenience, and charm of our on-site hybrid hotel. Select from 4-Star Mercure or 3-Star Ibis rooms.

## Why Stay with Us?

- Stylish, Comfortable Rooms – Unwind in modern, spacious rooms designed for a restful night's sleep.
- Ultimate Convenience – No need to travel—just head upstairs and relax.
- Delicious Breakfast Options – Start the next day right with our freshly prepared breakfast.
- Great Location – Close to Earl's Court, Kensington, and excellent transport links.
- Sustainable Stays – Stay with a hotel that proudly holds the Green Key Certification.
- Free Wi-Fi – Stay connected during your visit.
- Perfect for Groups – Special rates and packages available for event guests.
- Preferential Rates for accommodation when guests book event with us  
prices from £139.00 ibis (per night inc VAT & breakfast)  
prices from £159.00 Mercure (per night inc VAT and Breakfast)

Whether you are hosting a corporate dinner, private party, or celebratory drinks, rest easy knowing your room is just moments away.

## Get in touch

Phone +44 20 3988 8300

Contact [h5623-sb@accor.com](mailto:h5623-sb@accor.com)



Green Key



# THE FOUR-STAR DIFFERENCE

Mercure now open at Earl's Court.

With the newly regenerated 'Layers of Time' themed rooms inspired by the iconic Tardis from the long-running BBC TV series Doctor Who, the refurbished and rebranded 4-Star Mercure hotel rooms, including Tom Dixon mood lighting, cater for travellers looking for a local and authentic experience. We offer room types that cater to all guests, with amenities including refreshments, Chromecast TVs, and Nespresso machines.

Grab a bite at Barnaby's, where you'll find home dining with a twist, using overseas cooking methods and spices.

You can always take advantage of Mercure's 24-hour room service. The knowledgeable Guest relations team can help you 'discover local' with sightseeing advice and are on hand assist guests with travel arrangements. The hotel reception can also arrange car rental and dry-cleaning services for you.



  
282 ROOMS

  
CAR PARK

  
RESTAURANT AND BAR

  
ROOM SERVICE

# A NEW STANDARD FOR 3-STAR

Ibis Earl's Court refurbishment.

Ibis London Earl's Court provides guests with a warm welcome, spacious, and comfortable accommodation and convenient amenities. This three-star hotel features 226 guestrooms, including a mix of double, twin, and accessible rooms, a conference centre, use of Barnaby's Kitchen & Lounge and on-site parking, it offers an ideal base for both business and leisure travellers.

We offer a 24-hour reception and information desk as well as a 24 hour snack service. All our spacious and comfortable bedrooms are en-suite and equipped with environmentally friendly air-cooling, tea and coffee facilities, hairdryer, direct line telephone, WI-FI access, TV and radio channels.

  
226 ROOMS

  
CAR PARK

  
RESTAURANT AND BAR

  
24-HOUR RECEPTION



*Open your wings and you'll discover vibrant high streets, good pubs, trendy boutiques and epicurean restaurants.*

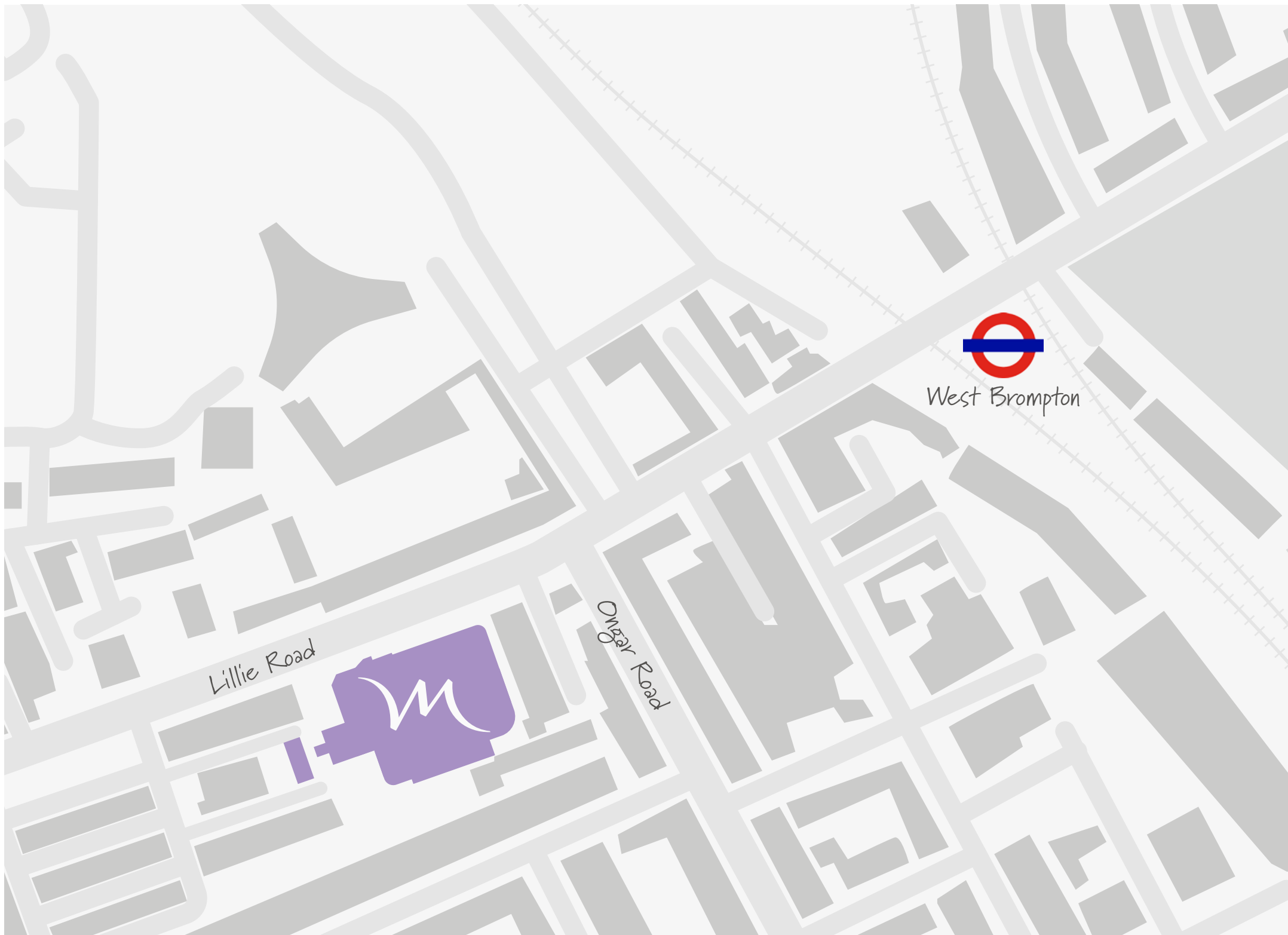

# GETTING HERE

Stay well connected.

Whether you are here for business or leisure, getting around couldn't be easier. Mercure Earl's Court is conveniently located near the M4 for access to Heathrow Airport and the motorway network. West Brompton Station provides Underground/Overground public transit to the rest of London. The hotel is only a short ride from London's greatest landmarks. As a result, it is the ideal location for UK and overseas visitors.

## London Underground

Sitting at the edge of zone 1, West Brompton (3 mins walk) and Earl's Court (7 mins walk) stations are both within easy walking distance.

## Driving

Mercure London Earl's Court is a quarter of a mile (400m) from the A4, providing easy access to the M4, M5 and M40.

## Parking

There is a car park adjacent to London Suite with 140 parking bays. Mercure London Earl's Court does not manage the parking so spaces cannot be reserved and may become full during busy events. Guests and delegates can benefit from preferential parking rates as follows:

Up to 2 hours £7	Up to 9 hours £16 (£21 for non-residents)
Up to 4 hours £11	Up to 12 hours £20 (£26 for non-residents)
Up to 6 hours £14	Up to 24 hours (overnight) £26

## Walking around the local area

Earls Court, with its long association with landmark exhibitions and events, has some great neighbours. Nearby you'll explore fashionable Notting Hill, home to the famous Caribbean carnival and the vintage or antique markets of Portobello Road, the interiors and boutiques of Fulham and Chelsea, Harrods of Knightsbridge and the Palace, museums and galleries of Kensington. Of course, The City and West End shops, theatres and architecturally iconic Westminster skyline are also within easy reach. A short ride on the handy District Line will take you to Wimbledon for the tennis, Putney, Chiswick or Richmond for the river, Ealing for the Blues Festival or Kew for the World Heritage Site gardens.



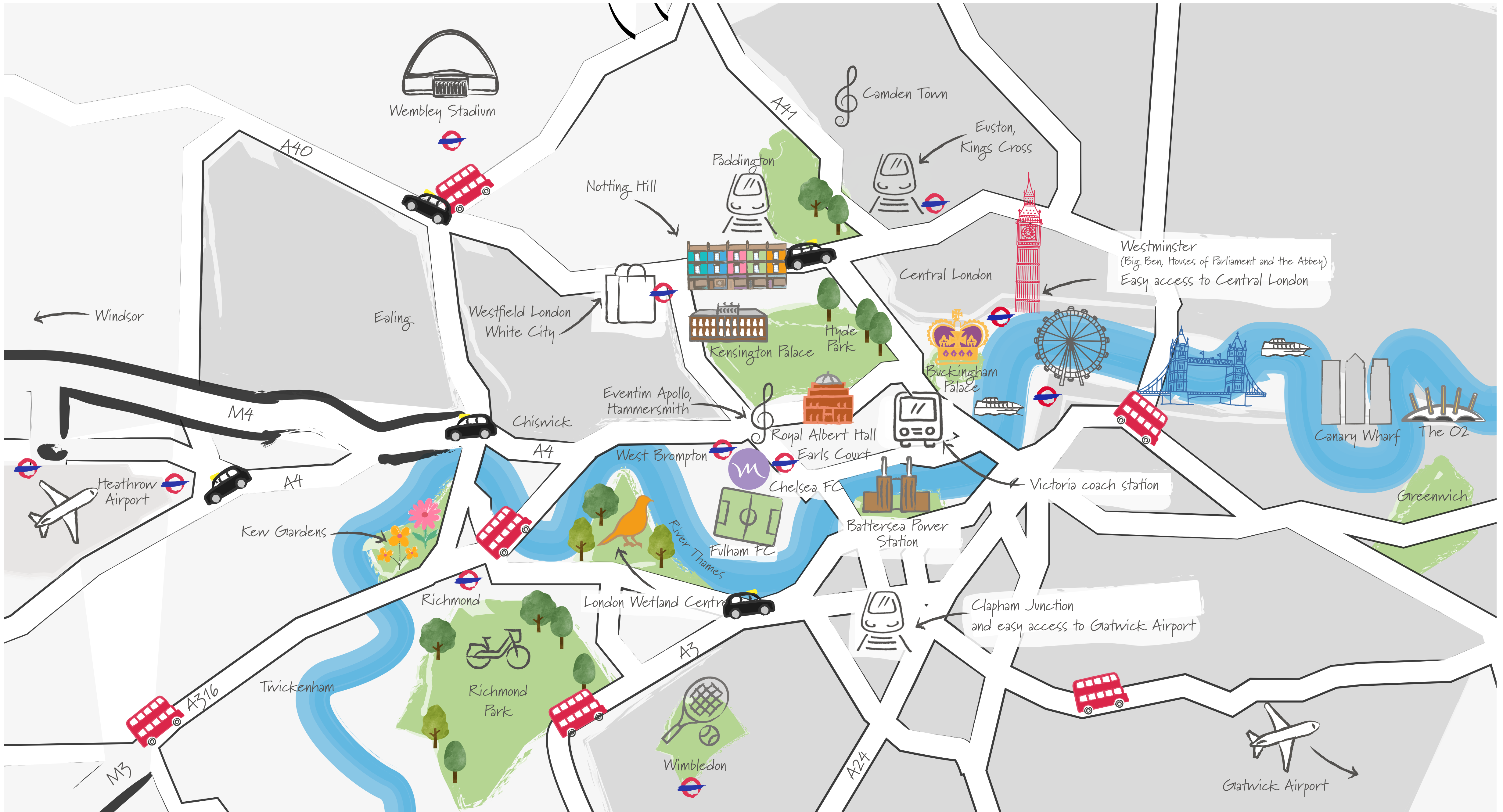

# YOUR EVENTS, YOUR REWARDS

Earn loyalty points with our ALL Meeting Planner programme.

**2 euros spent = 1 Reward point + 1 Status point**

- Get rewarded whenever you plan a professional event with the ALL Meeting Planner.
- Join the ALL Meeting Planner and earn points every time you organise an event.
- Book workspaces wherever you need, whenever you want. 2,400 hotels across the world, from luxury to budget-friendly.
- For all your events and in all our hotel ranges, spend 2 euros and get 1 Reward point and 1 Status point.

## **Flex to fit**

Finance future events using your points. Or use them for your next trip, for concert tickets, or a match. Your points, your choice. You can also share your points with other members of ALL.

## **Points, whenever**

There are no blackout dates on Reward points. Use them whenever you choose. There are no expiry dates on your points. No rush, no fuss. Plan more, earn more Earn even more Reward points whenever you plan an event.

## **Free membership**

It's quick and easy to join the ALL Meeting Planner.

[all.accor.com](https://all.accor.com)



MERCURE

HOTEL

LONDON EARL'S COURT

CALL +44 (0)203 988 8300  
OR EMAIL [H5623-SB@ACCOR.COM](mailto:H5623-SB@ACCOR.COM)  
TO DISCUSS YOUR EVENT REQUIREMENTS.

MERCURE LONDON EARL'S COURT,  
47 LILLIE ROAD, LONDON, SW6 1UD