



CLARIDGE'S

---

STEP INTO CLARIDGE'S IN MAYFAIR,  
LONDON'S ART DECO JEWEL,  
AND EXPERIENCE A WORLD OF  
STUNNING DESIGN AND FLAWLESS  
SERVICE UNMATCHED ANYWHERE  
ELSE IN LONDON.

AN INVITATION TO CLARIDGE'S  
IS UNSURPASSED IN TERMS OF  
ELEGANCE AND PRESTIGE, WITH ITS  
BREATHTAKING SERIES OF ROOMS  
FOR BANQUETS, PARTIES AND  
PRIVATE DINING.

---



# THE PERFECT SETTING

---

LONDON'S FAVOURITE FOR ALL  
MANNER OF CELEBRATIONS

---

Since the late nineteenth century, Claridge's has been one of London's favourite places for grand celebrations and private dining. This legendary hotel offers true distinction and style for all occasions. Its private events spaces include the 1930s Ballroom, the scene of many a state banquet and society ball. The Ballroom connects through to the Mirror Room, with the elegant French Salon and Drawing Room beyond. There is also a select suite of private dining rooms on the sixth floor.

Claridge's boasts 190 individually designed guest rooms and suites, including two magnificent penthouse apartments. The Foyer and Reading Room serve an ever-changing menu for delicious all-day dining, and an award-winning afternoon tea. Claridge's Bar provides a convivial meeting place, the Fumoir serves classic cocktails in Lalique crystal, whilst the fashion houses of Bond Street and Regent Street are within easy walking distance.





---

"LONDON'S TOP ADDRESS.  
I HAVE HELD FASHION SHOWS IN THE  
BALLROOM AND HAVE A PARTICULAR  
AFFECTION FOR THE HOTEL."

PAUL SMITH  
*Designer*

---

"I AM SO TERRIFICALLY, PROFOUNDLY,  
AWESOMELY GRATEFUL FOR EVERYTHING  
YOU DID TO MAKE LAST NIGHT SO  
WONDERFUL. YOU WERE SO ASTOUNDINGLY  
PROFESSIONAL AND GRACEFUL FROM START  
TO FINISH THAT FOR US IT WAS A SHEER,  
UNADULTERATED JOY."

KATE REARDON  
*Editor, Tatler*

---





The Ballroom Reception







---

"IT'S A GRANDE DAME OF THE LONDON HOTEL SCENE AND IT'S HARD NOT TO BE CHARMED BY CLARIDGE'S ART DECO GLAMOUR. MODEL LARA STONE MARRIED DAVID WALLIAMS HERE IN MAY AND KATE MOSS HELD HER 30TH BIRTHDAY PARTY IN A SUITE."

VOTED NUMBER 1 LONDON WEDDING VENUE  
*Condé Nast Brides*

---

"STAYING HERE IS LIKE BEING IN A MAGICAL MUSIC HALL. IT'S PERFECTLY STAGED. EVERYTHING LOOKS FANTASTIC. EVERYONE WELCOMES YOU."

CHRISTIAN LOUBOUTIN  
*Designer*

---







# THE BALLROOM

Approached through Claridge’s prestigious Brook Street banqueting entrance, a gentle flight of stairs, sporting a faithfully crafted replica of the original Marion Dorn Art Deco carpet, leads expectant guests into the imposing Ballroom Reception area, scene of many a delighted gathering of acquaintances both old and new, the gentle murmur of anticipation rising as the assembled party prepares to enter the glamorous and English Heritage listed Ballroom.

Fully restored by leading interiors guru Guy Oliver, the Ballroom, and neighbouring Mirror Room, have been designed to echo the original décor first introduced to the hotel by Oswald Milne and Basil Ionides in the late 1920s. Using colours reminiscent of that era, eau de Nil, sable, chocolate, olive and silver, the subtle detailing extends to platinum leaf covered pillars, hand-engraved mirrors and contemporary Art Deco fan design carpet.

### The Ballroom Reception

The Ballroom Reception area is a fine, well-proportioned room that can be used in its own right for receptions and informal meetings. It has the benefit of the Ballroom’s own entrance and cloakroom and is adjoined by the smaller Painted Room in classic Art Deco style.

### The Ballroom

The setting of many a society wedding, ball and state banquet, Claridge’s Ballroom is also a prestigious venue for cocktail receptions on a grand scale. It accommodates 400 for receptions or 250 for dining – and up to 650 guests in combination with the Mirror Room, French Salon or Drawing Room. It has its own entrance, reception area, marble Rotunda and cloakroom.

### The Mirror Room

This striking room with its magnificent mirrors and large windows is perfect for lunches and dinners, cocktail receptions and weddings. Linked by double doors to the adjoining Ballroom, it is perfectly suited for combining with functions in the Ballroom as a reception or refreshment room. It has room for 96 guests for breakfast, lunch or dinner or 120 for a reception.

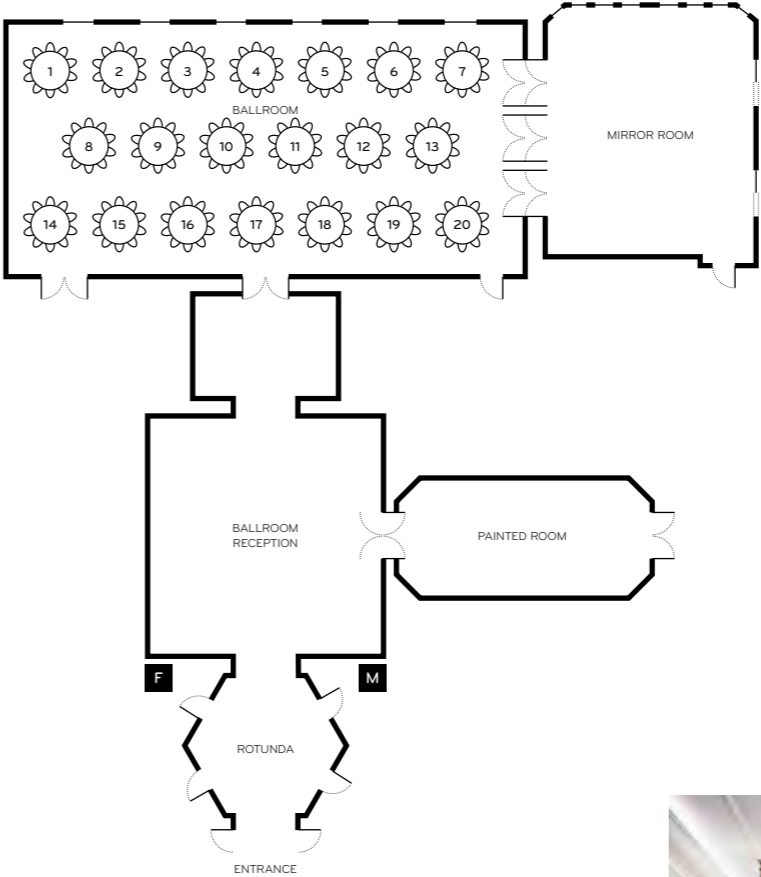

### CAPACITY

The Ballroom Reception	
Reception	250
Dimensions	9.75 x 9.75m / 95m <sup>2</sup> 32 x 32ft / 1024ft <sup>2</sup>

The Ballroom	
Breakfast, Lunch or Dinner	250
Reception	400
Dinner dance	220
Dimensions	24.1 x 11.9m / 286m <sup>2</sup> 87 x 43ft / 3706ft <sup>2</sup>

The Mirror Room	
Breakfast, Lunch or Dinner	20-96*
Reception	120
Dimensions	11 x 10.4m / 114m <sup>2</sup> 40 x 38ft / 1499ft <sup>2</sup>

*\*When adjoining room is used for cocktails*



The Ballroom

# THE FRENCH SALON AND DRAWING ROOM

In contrast to the Art Deco Ballroom and Mirror Room, the Drawing Room and French Salon are resplendent in classical style, rejoicing in all the charms of a bygone era. Together they lend themselves perfectly to wedding ceremonies and breakfasts, cocktail parties, celebration dinners, dancing and evening entertainment. To host an event in such magnificent surroundings is to experience one’s own personal slice of Claridge’s rich history and just as importantly to treat your guests to their own special piece of Claridge’s heaven.

### The French Salon

The French Salon has an original marble mantelpiece, coving and friezes, fine Watteau-school portrait and Art Deco iron work tassels by Basil Ionides. It is suitable for breakfast, lunch or dinner for up to 100 and reception and cocktail parties for 120 guests.

### The Drawing Room

This light and well proportioned room is furnished and decorated in eighteenth century style and features two fine open fireplaces and the imposing portrait of the Lady in Blue. The Drawing Room accommodates 150 for cocktails and up to 100 for breakfast, lunch or dinner.

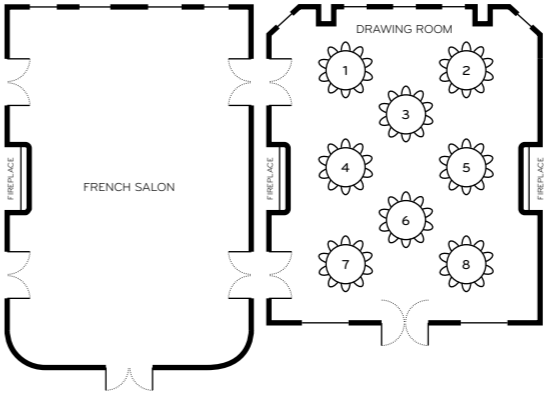

### CAPACITY

#### The French Salon

Breakfast, Lunch or Dinner	100*
Reception	120
Dimensions	12.19 x 8.23m / 100.32m <sup>2</sup> 40 x 27ft / 1080ft <sup>2</sup>

#### The Drawing Room

Breakfast, Lunch or Dinner	20-100*
Reception	150
Dimensions	12.2x 10m / 121m <sup>2</sup> 40 x 36ft / 1588ft <sup>2</sup>

*\*When adjoining room is used for cocktails*



*The French Salon*



*The Drawing Room*

# THE MEZZANINE EVENT ROOMS

Claridge's has been a favourite setting for private celebrations for over a century. Now a new suite of rooms on the Mezzanine level has been added to complement the existing event spaces. Situated just above the lobby, a private reception area leads to this self-contained collection of seven versatile event rooms. Each room features art deco design, complete with bespoke Linley furniture. Rooms can be used singly or in combination, to suit any event.

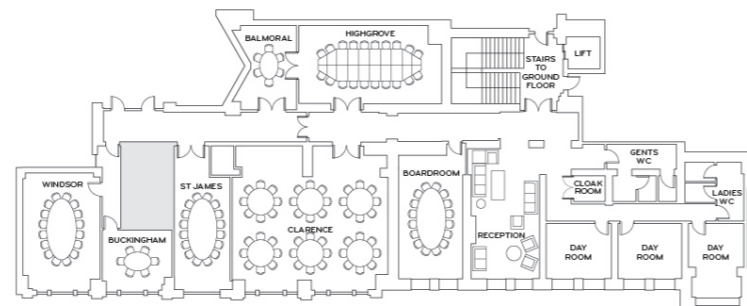

## The Clarence & St James Rooms

The most spacious, the Clarence Room can be used for weddings and cocktail parties. There is space for receptions for up to 100 guests or dinner for up to 85, when connected to the St James Room.

## The Highgrove & Balmoral Rooms

The more intimate Highgrove Room is perfect for buffet lunches or celebration dinners for up to 22 guests. The Highgrove Room connects with the Balmoral Room to add a smaller welcome area or bar for pre-dinner drinks.

## The Windsor Room & Boardroom

The Windsor Room is suited for up to 18 people or for intimate lunches, dinners or cocktail parties. A private hallway connects to the Buckingham Room, creating a perfect private area for smaller gatherings. In the Boardroom, floor-to-ceiling windows overlooking Brook Street create an elegant backdrop for private dinners for up to 22 guests.

## CAPACITY

### The Clarence & St. James Rooms

Breakfast, Lunch or Dinner	85
Reception	100
Dimensions	108 m <sup>2</sup> / 1162.5 ft <sup>2</sup>

### The Highgrove & Balmoral Rooms

Breakfast, Lunch or Dinner	22
Reception	40
Dimensions	38.510m <sup>2</sup> x 414.4ft <sup>2</sup>

### The Windsor Room

Breakfast, Lunch or Dinner	22
Reception	35
Dimensions	35.4m <sup>2</sup> 40 x 381ft <sup>2</sup>

### The Boardroom

Breakfast, Lunch or Dinner	16
Reception	35
Dimensions	31.2m <sup>2</sup> 40 x 335.8ft <sup>2</sup>



*The Highgrove & Balmoral Rooms*



Empress Eugenie Suite

## ACCOMMODATION

All 190 bedrooms and suites, many of which interconnect, are individually designed and supremely comfortable, assuring guests a truly memorable stay. Each has the latest in communications and entertainment systems with digital quality films, music and WiFi. With their bold tiling and grand chrome fittings, Claridge's bathrooms have a special reputation for their strikingly good design and generosity of space.

## WINING AND DINING

Claridge's Bar is one of Mayfair's most popular meeting places. The elegant bar plays host to some of the world's leading lights.

The Fumoir with a décor inspired by the original 1930s glass panel above its entrance, serves classic cocktails and champagne in Lalique crystal.

Dale Chihuly's magnificent silver-white 'light sculpture' graces the elegantly restored Foyer, perennially popular with Londoners and visitors alike. The Reading Room with its Art Deco cut marble fireplaces, rich leather columns, banquettes and suede walls, is the perfect choice for delicious and intimate dining throughout the day. Don't miss Claridge's award-winning afternoon tea which includes a huge choice of over 30 different teas from around the world and a delicious selection of sandwiches, French pastries and freshly baked raisin and apple scones served with clotted cream.

## CLARIDGE'S HEALTH CLUB AND SPA

Discover a sanctuary, a haven of tranquillity, where both mind and body can be soothed, recharged and re-energised. Featuring Sisley's Les Soins Essentiels, the latest treatments will transport you to a sensual world where body and mind are reunified.

The gym is light and spacious, with the latest Technogym fitness equipment and views across the rooftops of London. Programmes can be individually tailored and visiting specialists provide a range of alternative therapies.

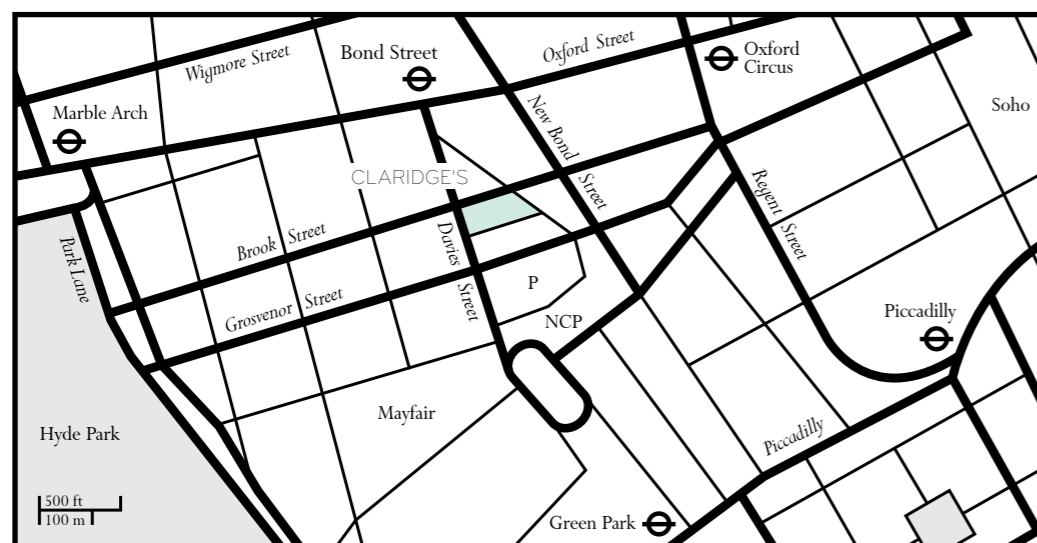

## HOW TO FIND US

Claridge's lies on the corner of Brook Street and Davies Street right in the heart of Mayfair, midway between Hyde Park and fashionable Bond Street. The nearest underground station is Bond Street, served by the Jubilee and Central lines. Victoria Station is 15 minutes by car and St Pancras International 20 minutes. London Heathrow and City Airports are approximately 45 minutes' drive, Gatwick one and a half hours. Claridge's is happy to arrange private car transfers in one of our fleet of luxurious Mercedes and Bentleys.

## RESERVATIONS

*For more information or to plan your special event at Claridge's, simply call us on +44 (0)20 7409 6500 or enquire by email at [socialoccasions@claridges.co.uk](mailto:socialoccasions@claridges.co.uk) web address: [claridges.co.uk](http://claridges.co.uk)*