

# Chapter.

KITCHEN | BAR | TERRACE

## GROUP BOOKINGS.

Chapter is the ideal spot for hosting your celebrations and networking events from breakfast through to drinks parties and lunch or dinner.

Our team is super organised and very flexible. Discuss what you have in mind and we'll create a package to suit.

Located on leafy Greenfield Crescent in the heart of Edgbaston Village, we have easy access to the city centre with good transport links such as train and tram, and ample pay and display parking behind the restaurant.

We will discuss the food options that will be suitable for your event -

- 3 course menus start from £31 per person
- Canapes start from £3 .50 each
- Bowl food is from £8 per bowl
- Full English Breakfast with orange juice and tea/ coffee is £25.00 per person (min. 20 people)
- Breakfast Buffet

For smaller groups up to 16 people we can offer our a la carte menu, with guests ordering on the day.

We are always delighted to look at something bespoke, ie Tasting Menu with wines to match.

While Chapter does not have a separate private dining room, our beautiful light-filled venue lends itself to a number of choices for group functions.



Ready to make it happen? Call Irene on 0121 200 3020 or email [irene@chapteredgbaston.co.uk](mailto:irene@chapteredgbaston.co.uk)

## Section 2 of the Dining Room.

This area is one half of the dining room, allowing you exclusive use of the area while being part of the restaurant buzz.

- Seating Capacity: up to 40 people on tables of 10

No minimum spend but minimum numbers 35.

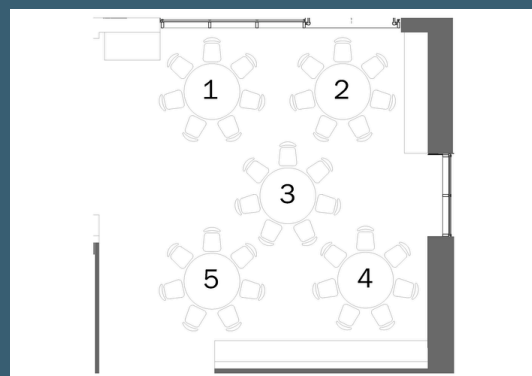
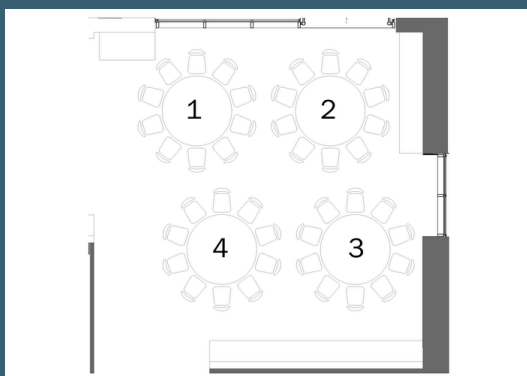

## Exclusive use of Full Venue.

Hire the entire venue and make it your own celebration. We have a PA system and you can organise a dance floor area, music, large screen televisions.

- Seating capacity: up to 90 people
- Standing capacity: up to 120

Note that space will reduce if there are requirements such as dance floor. Minimum spend: POA

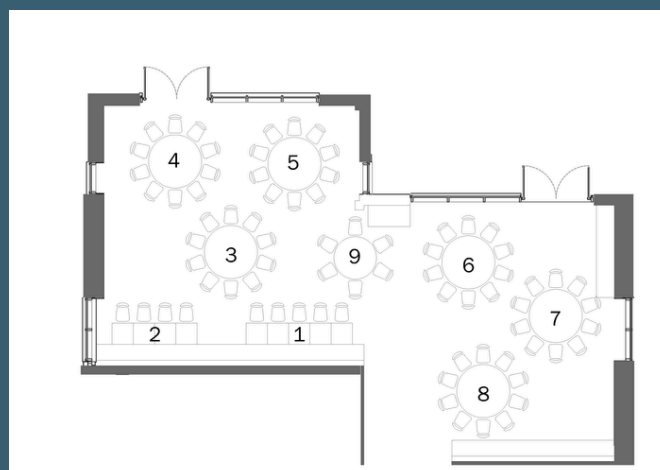



## Bar Lounge.

This area leads off the front terrace and is set slightly back from the rest of the bar, creating a great space for parties.

### Seated:

- 12 on a square table
- 18 on one long table
- 24 on 4 small round tables
- 30 on 3 large round tables

### Standing:

- Up to 50 people



Minimum spend: from £500 depending on the day of the week; please note bookings on Friday, Saturday, and Sunday incur an additional hire charge (POA).

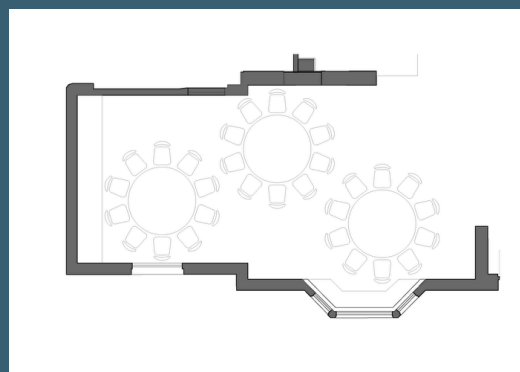
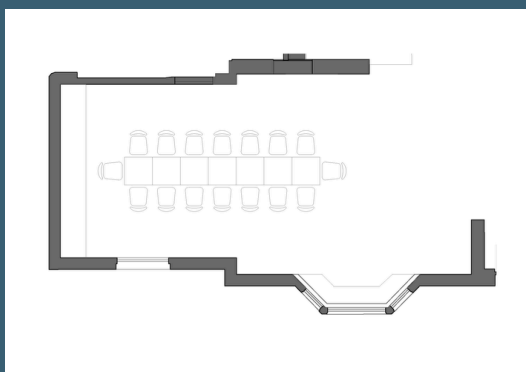

# Terrace.

In addition, our terrace area can also be booked for private gatherings in fine weather. These are lovely landscaped spaces.

## Lower Front Terrace

- Standing capacity: up to 16
- Minimum spend: £350

## Rear Patio

- Standing capacity: up to 50 people
- Minimum spend: £750



For more information or to book a viewing of the restaurant  
please email Irene | [Irene@chapteredgbaston.co.uk](mailto:Irene@chapteredgbaston.co.uk)



August 2024 - prices subject to change  
5-6 Greenfield Crescent | [chapteredgbaston.co.uk](http://chapteredgbaston.co.uk)  
0121 200 3020

Tuesday to Sunday from 9.30am

