

PRIVATE HIRE

# LADBROKE HALL

*Your stage for the Arts*



## YOUR STAGE FOR THE ARTS

Ladbroke Hall is an arts and events venue situated in Ladbroke Grove, West London.

Set in the historic, former Sunbeam Talbot factory, it offers 7 unique and versatile spaces.

- Overall building size: 3,900 m<sup>2</sup> / 42,000 sqft
- Garden size: 1,162 m<sup>2</sup> / 12,500 sqft

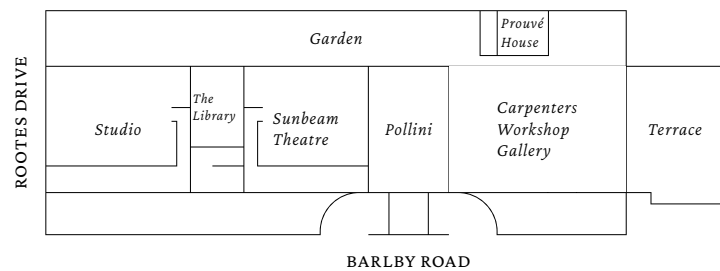

# SUNBEAM THEATRE





*The Sunbeam Theatre is the most iconic venue at Ladbroke Hall, featuring the original 1903 Sunbeam Talbot crest.*

*Catering provided by Pollini.*

---

#### KEY FEATURES

---

##### *Space:*

- Overall size: 278 m<sup>2</sup> | 3,000 sqft
- Height: 9.95 m
- Seated capacity: Banquet 190 | Cabaret 130 | Theatre 180
- Standing capacity: 400
- Soundproofed ceiling and walls
- Direct access to the kitchen and garden
- Abundant natural light from both sides
- Overhanging mezzanine with terrazzo floors
- Bar under mezzanine
- Car park space available

##### *Tech:*

- Motorised truss
- High speed WiFi 400 mbps
- Full black-out capabilities
- State-of-the-art acoustics
- Full AV and production capabilities
- L-Acoustics concert speakers
- Projection screen 5x5 m

##### *Music, Art and Design:*

- Features 'Beautiful Boy' sculpture by Thomas Houseago
- Steinway grand piano model D on request

➤ [DOWNLOAD FLOORPLAN](#)

➤ [VIEW MORE PHOTOS OF THE SUNBEAM THEATRE](#)

STUDIO





*The Studio is a versatile space, available for photoshoots, screenings, brand takeovers and private parties.*

*Catering provided by Pollini. External catering permitted on request.*

---

#### KEY FEATURES

---

*Space:*

- Overall size: 297 m<sup>2</sup> | 3,200 sqft
- Ground floor: 227 m<sup>2</sup> | 2,443 sqft
- Mezzanine floor: 55 m<sup>2</sup> | 592 sqft
- Height: 9.95 m
- Seated capacity: Banquet 220 | Theatre 200
- Standing capacity: 450
- Abundant natural light from both sides

*Tech:*

- Motorised truss
- High speed WiFi 400 mbps
- Soundproofed ceiling
- Full black-out capabilities
- Full AV and production capabilities

*Logistics:*

- Overhanging mezzanine with terrazzo floors
- Back-of-house space available for storage underneath the mezzanine
- Dedicated double door entrance and drive-in access for loading / unloading
- Direct access to garden
- Car park space available

➤ [DOWNLOAD FLOORPLAN](#)

➤ [VIEW MORE PHOTOS OF THE STUDIO](#)

# POLLINI AT LADBROKE HALL

*Head Chef Emanuele Pollini | Voted best Italian chef in the world by Gambero Rosso 2020*





*The Pollini dining room features a site-specific art collection by Nacho Carbonell, Christopher Le Brun and Vincenzo De Cotiis.*

---

#### AWARDS

---

- **21st Best Italian Restaurant in the World**  
(50 Top Italy 2025)
- **Best Italian Restaurant in the UK**  
(Gambero Rosso | 3 Forks 2024)
- **Best Restaurant**  
(Wallpaper\* Design Awards 2024)

---

#### KEY FEATURES

---

- Overall size: 123 m<sup>2</sup> / 1,324 sqft
- Height: 14 m
- Seated capacity: 85
- Standing capacity: 200
- High speed WiFi 400 mbps
- Modular seating

➤ [DOWNLOAD FLOORPLAN](#)

➤ [VIEW MORE PHOTOS OF POLLINI](#)

# THE LIBRARY

*Private Room*





*Designed by artist Ingrid Donat, with sculpted wood and bronze panelling, the Library is suited to private dinners and meetings.*

*Catering provided by Pollini.*

---

#### KEY FEATURES

---

- Overall size: 55.7 m<sup>2</sup> / 600 sqft
- Height: 4.1 m
- Seated capacity: 14
- Dolby Atmos 18 Focal speakers & Denon amp
- High speed WiFi 400 mbps

➤ [VIEW MORE PHOTOS OF THE LIBRARY](#)

# TERRACE

*Designed by Chelsea Flower Show winner Luciano Giubbilei*





*Shaded by a wisteria and hydrangea pergola, the terrace is available for functions and photoshoots.*

*Catering provided by Pollini.*

---

#### KEY FEATURES

---

- Overall size: 74 m<sup>2</sup> / 796 sqft
- Seated capacity: 30
- Standing capacity: 30
- Licensing: 9am – 9:30pm
- Outdoor furniture by Robert Stadler

[➤ VIEW MORE PHOTOS OF THE TERRACE](#)

# GARDEN

*Designed by Chelsea Flower Show winner Luciano Giubbilei*

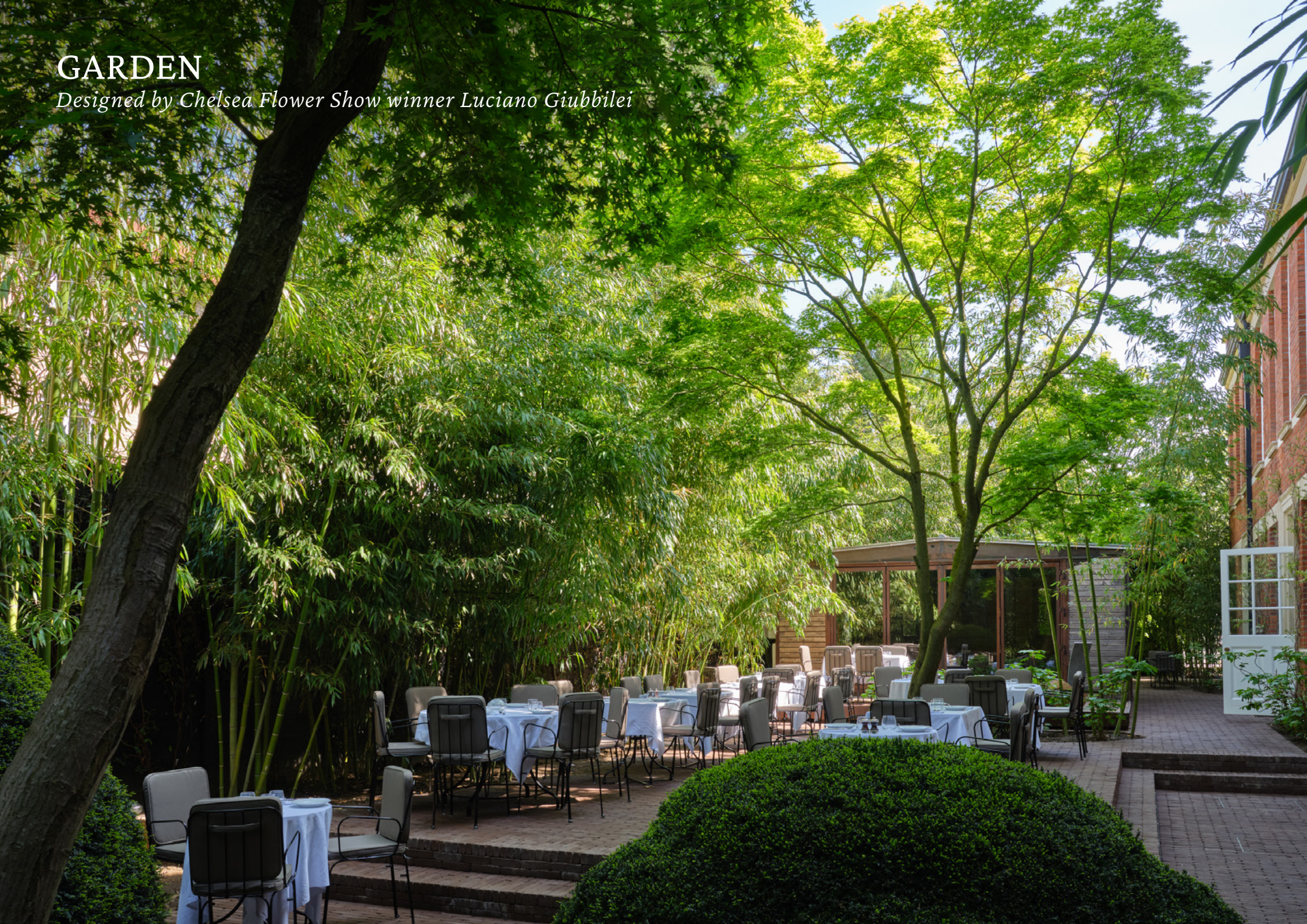



*Stretching the length of the building, the garden features Carpenters Workshop Gallery artworks as well as a Jean Prouvé house from 1944.*

*Catering provided by Pollini.*

---

#### KEY FEATURES

---

- Overall size: 1,162 m<sup>2</sup> / 12,500 sqft
- Seated capacity: 220
- Standing capacity: 650
- Licensing: 9am – 9:30pm

[> VIEW MORE PHOTOS OF THE GARDEN](#)

# JEAN PROUVÉ HOUSE

*Private Room*





*Overlooking the garden, the Maison Demontable is an original Jean Prouvé 6x6m house from 1944.*

*Catering provided by Pollini.*

---

#### KEY FEATURES

---

- Overall size: 36 m<sup>2</sup> / 388 sqft
- Seated capacity: 24
- Standing capacity: 30
- Licensing: 9am – 9:30pm
- High speed WiFi 400 mbps
- Underfloor heating

[➤ VIEW MORE PHOTOS OF THE PROUVÉ HOUSE](#)

## CATERING

*Outstanding in-house food and service*

Enjoy Chef Pollini's seasonal food – from canapés to tasting menus – with warm and professional service from our experienced team.

---

### RECENT AWARDS

---

- **21st Best Italian Restaurant in the World**  
(50 Top Italy 2025)
- **Best Italian Restaurant in the UK**  
(Gambero Rosso | 3 Forks 2024)
- **Best Restaurant**  
(Wallpaper\* Design Awards 2024)



[➤ VIEW SAMPLE MENUS](#)





020 8962 8690  
[events@ladbrokehall.com](mailto:events@ladbrokehall.com)

79 Barlby Road, London, W10 6AZ

