



## DRAWING ROOM

Constructed in 1894, the Drawing Room retains its original charm and elegance as a cosy dining room space. Traditional furniture and architectural features create a relaxing area with a classic College atmosphere.

The Drawing Room can seat 40 guests for lunch and dinner but is equally suitable for drinks receptions, refreshment breaks and buffets. The Drawing Room and Fellows' Dining Room are both licensed to hold civil wedding ceremonies.

### DIMENSIONS

7.5m x 10m  
75m<sup>2</sup>

### CAPACITIES

Dining 40  
Cabaret 36  
Boardroom 22  
Theatre 40

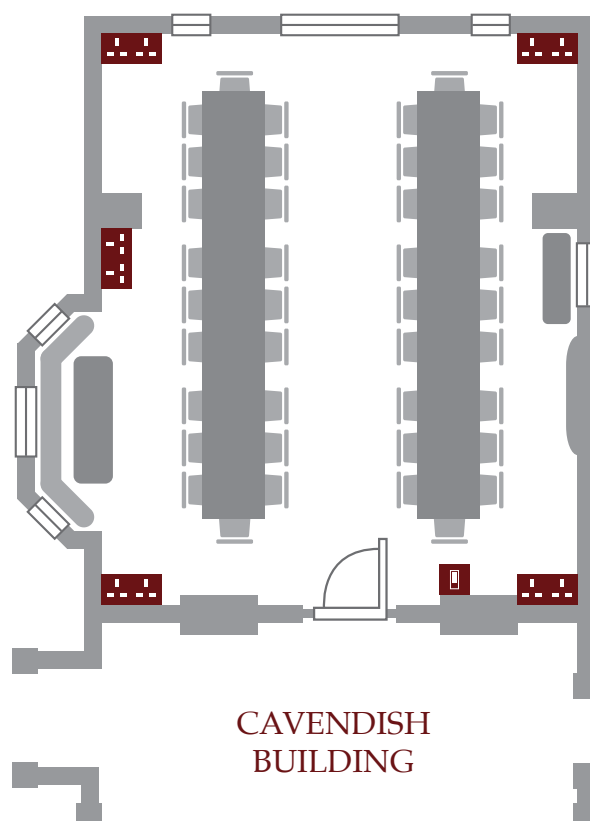

 Light switch

 Double plug socket

# DRAWING ROOM LAYOUTS

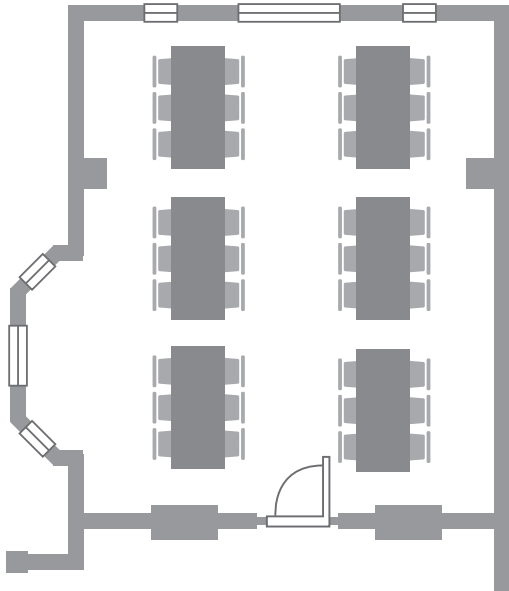

**CABARET 36**

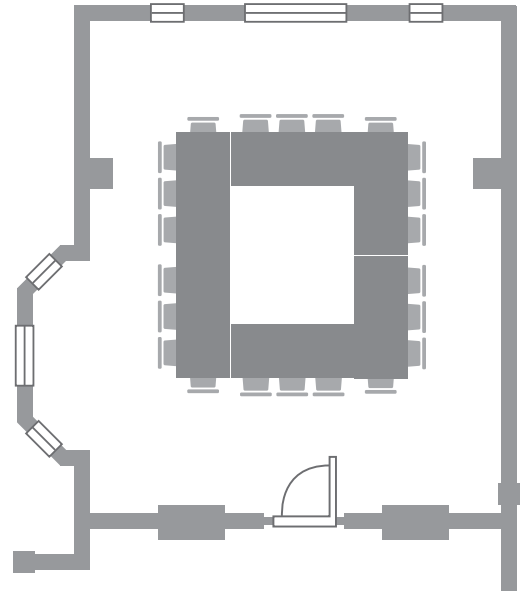

**BOARDROOM 22**

## LOCATION

Cavendish Building  
Ground floor (step-free access)  
Enter via the Cavendish or Griffin Doors

## EQUIPMENT

WiFi coverage

## OTHER FACILITIES

AV technician on request



Parking is available on a first come first serve basis.



In the event of a fire:  
Evacuate at the nearest exit and assemble on the D+E lawn.

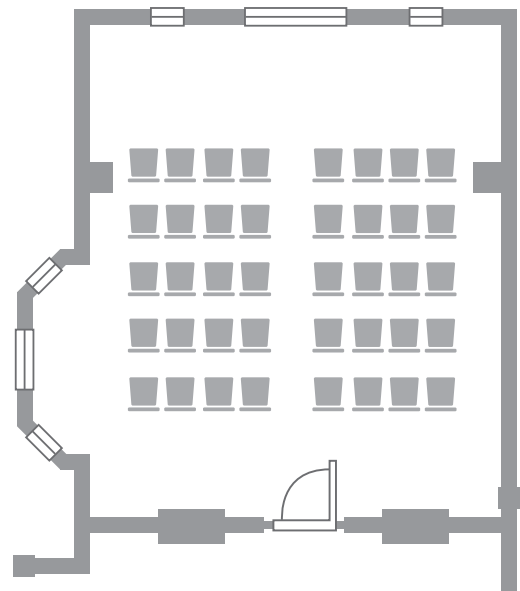

**THEATRE 40**