



BROWN'S HOTEL
LONDON

A ROCCO FORTE HOTEL

The St. George's Room



The most intimate event space at Brown's, The St George's Room commemorates a significant moment in 1889 when we merged The St George Hotel with Brown's Hotel, marking a crucial phase in the hotel's expansion.

- Located on the ground floor
- Private entrance from Dover Street
- Natural daylight



Boardroom

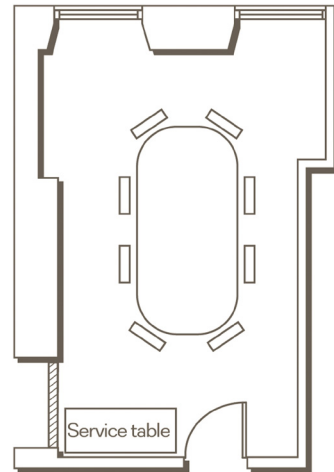

Size	Dimensions L x W x H	Boardroom	Hollow Square	Cabaret	Classroom	Banquet	Standing Reception	Theatre	U-Shape
20.8m ² 224ft ²	5.5 x 3.8m 18' x 12'4"	8	8	-	8	-	10	8	-