

116
PALL MALL

Events *at* 116 Pall Mall

BY SEARCYS

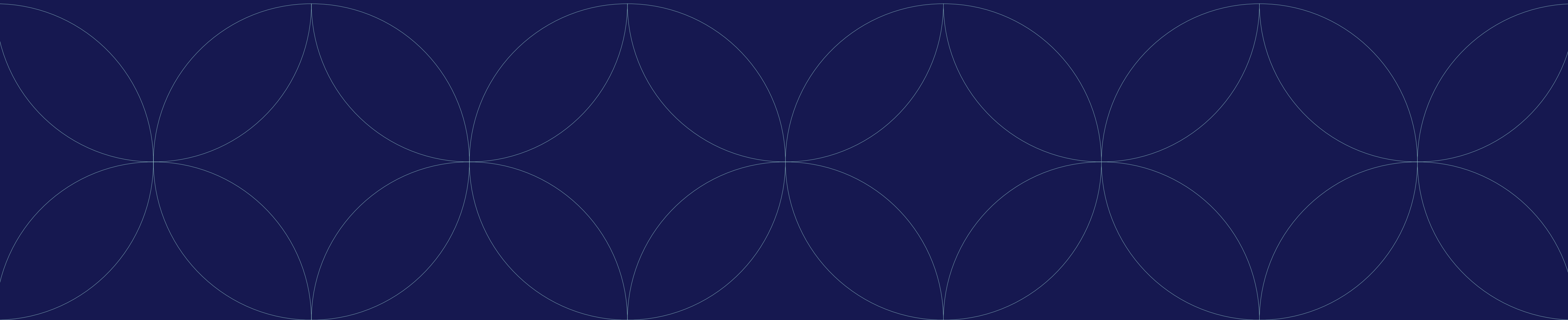



History of 116 Pall Mall

John Nash, the famous and fashionable 19th century architect, designed 116 Pall Mall in the early 1820s.

Its imposing Regency exterior is typical of Nash's distinct style which is visible in many other buildings in the vicinity including those on Regent Street and nearby Carlton House Terrace. Nash also famously designed the Brighton Pavillion, Marble Arch and many more of London's most popular attractions.

116 is built on the site of Carlton House, the one-time London residence of the Prince of Wales prior to his accession to the throne as George IV in 1820. Carlton House was subsequently demolished when the King moved his household to the newly renovated Buckingham Palace.

The site, in the heart of London's genteel and fashionable "clubland", was then chosen as appropriate for the United Service Club. Building work took two years and was completed in 1828, £7,000 over budget and at a total bill of £45,000 (a figure in today's economy approximating £7.7 million).

The next three decades saw substantial changes to the building both inside and out as fashions changed. In 1842, Decimus Burton was employed as architect to the club and instigated a complete redecoration and some structural alterations.

Burton was the designer of the Athenaeum which stands opposite 116 across Waterloo Place. The similarities between the two buildings are obvious and owe much to Burton's alterations. They

include a large external cornice with balustrade, the frieze on the northern façade, and the fluting of the Corinthian columns on the upper portico.

Perhaps most imposingly, Burton also added the 19 cast iron flambeaux, or lanterns, around the building which were lit for ceremonial occasions, state visits and for remembrance of significant battles in British military and naval history. The flambeaux are still fully operational and can be lit for evening functions in the building.

The United Service Club occupied 116 for most of the next century and during its tenancy expanded into the adjacent buildings to provide overnight accommodation for members. These bedrooms now form the Business Centre meeting facilities on the third and fourth floors.

Today, 116 Pall Mall is home to the Institute of Directors, a thriving membership community for directors in the UK and beyond, where you can connect with other leaders, develop your skills and be heard.

To find out more about the IoD and to join, please visit iod.com

Discover more at 116pallmall.com



Institute of Directors

116 Pall Mall is home to the Institute of Directors (IoD), a thriving membership community for directors in the UK and beyond, where you can connect with other leaders, develop your skills and be heard.

IoD membership

At a time when great directors have never been more important, the IoD offers professional development, valuable connections and influence.

With a wide range of benefits available to support you as a director, the IoD is a great place to connect and share knowledge.

Full membership:
£494 per year (£44.46 per month)

International membership:
£238 per year

iod.com/why-join-us

Professional development and training with the IoD

Whether you're starting or cementing your role as a company director the IoD can help you develop your existing business skills and broaden your knowledge with new ones.

Our world-class professional development is designed by directors for directors to help you and your senior leaders steer your organisation effectively and successfully supporting a shared commitment to lifelong learning.

We are the only institute to offer the internationally recognised Chartered Director Qualification.

With reduced rates for members on all our courses.

iod.com/professional-development



The Nash

Named in honour of the architect John Nash, who designed 116 Pall Mall in the 1820s, The Nash is one of London's most beautiful event rooms and our most popular choice for larger gatherings.

Luxurious in style and steeped in grandeur, this 3,000 sq ft space comfortably welcomes 350 standing guests and 250 dining on round tables. It can also be arranged with sets and stages to suit any presentation or performance.

This spectacular space also links to the Waterloo Room and both rooms are often hired together to allow for a separate space for a drinks reception or networking. The Nash adjoins a beautiful balcony overlooking the gardens below which can also be booked, providing a space for guests to get some fresh air and enjoy the views.

IDEAL FOR

Gala dinners, awards ceremonies, conferences, drinks receptions, exhibitions, meetings, press launches

CAPACITIES

350 theatre style,
180 classroom,
176 cabaret style,
250 dining,
350 standing,
90 u-shape





The Waterloo and St. James 1 & 2

This stunning double aspect room overlooks the iconic Pall Mall and Waterloo Place and is one of our most popular rooms.

This elegant double-aspect room is one of our most popular spaces. Flooded with natural light and period charm, it seats 120 theatre-style or 160 for a drinks reception.

Often hired alongside St James 1 & 2, The Waterloo works perfectly as a main event space, with extra room for reception drinks, refreshment stations or breakout spaces.

Ideal as a standalone conference room with stage and sets, or as a breakout and networking space, it also connects to the Nash Room - perfect for hosting separate receptions. As night falls, the Georgian architecture beyond the floor-to-ceiling windows creates a stunning backdrop.

The rooms can be used separately or combined for flexibility, and they can also be hired alongside other main function rooms around our balcony for larger events and exhibitions.

IDEAL FOR

Waterloo
Dinners, conferences, drinks receptions, meetings, wine tastings, Christmas parties

St. James 1 & 2
Break out rooms, breakfast meetings, board meetings, intimate dinners/lunches, drinks receptions

CAPACITIES

Waterloo	St James Room 1
120 theatre style	50 theatre style
70 classroom	30 classroom
56 cabaret style	24 cabaret style
80 dining	30 dining
150 standing	50 reception
36 u-shape	20 boardroom

St James Room 2
40 theatre style
30 classroom
24 cabaret style
40 dining
50 reception
28 boardroom



The Burton

Majestic yet welcoming, this classic Georgian room is one of our most sought after for daytime events and combines perfectly with two adjacent rooms as breakout or catering spaces.

Extremely popular for daytime functions and with the versatility of being offered in conjunction with Trafalgar 1 & 2, this classic setting is well suited to seminars, talks and networking events. A classically striking room that offers a blank canvas for entertaining and is licensed for wedding ceremonies.

IDEAL FOR

Conferences, seminars, meetings, drinks receptions, networking events, Christmas parties

CAPACITIES

140 theatre style
50 classroom
72 cabaret style
100 dining
160 standing
40 U-shape



The Trafalgar 1 & 2

Two adjoining rooms full of original features and charm, Trafalgar 1 and 2 offer natural light and an airy ambience.

Their subtle, neutral colours and welcoming elegance make them infinitely versatile, giving you the option to use both rooms together and create a completely different space for your event.

Located opposite the Burton Room, all three rooms are often hired together, allowing delegates and guests to move freely around, and providing the ideal solution to additional break-out space. They are also conveniently located next to a separate entrance, accessed by a beautiful antique lift.

IDEAL FOR

Break out room, breakfast meetings, board meetings, intimate dinners/lunches, drinks receptions

CAPACITIES

Trafalgar Room 1:
40 theatre style
30 classroom
24 cabaret style
30 dining
50 reception
16 boardroom

Trafalgar Room 2:
50 theatre style
30 classroom
26 cabaret style
40 dining
70 reception
20 boardroom





WEEKEND & EVENING HIRE ONLY

The Carlton

Once the Smoking Room of the United Service Club, The Carlton Room is a richly decorated space with dramatic Ionic columns finished in marble-esque scagliola.

The walls are lavishly covered in gold leaf on linen, adding a real sense of glamour and opulence to the room. A popular space for large-scale parties and celebrations, The Carlton provides a luxurious setting for any special event, with the option to add a DJ and dancefloor and round tables for dining.

The south facing doors open onto a beautiful private terrace with views across the garden and for this reason, the Carlton has become a popular space to hire for summer parties - providing the ideal shelter for unpredictable weather! Enjoy the sun in tranquil green surroundings - a rarity in central London, perfect for company events, drinks receptions, birthday celebrations or networking events.

IDEAL FOR

Drinks receptions,
gala dinners,
weddings,
exhibitions,
networking events,
Christmas parties

CAPACITIES

150 dining
300 standing





The Garden & Terrace

The south facing doors of The Carlton open onto our beautiful private terrace, with enchanting views across the garden.

Paired with The Carlton, the Garden & Terrace is a popular space for summer parties - providing the ideal shelter for unpredictable British weather! Enjoy the sun in tranquil green surroundings - a hidden oasis in central London.

IDEAL FOR

Company events, drinks receptions, birthday celebrations or networking events.

CAPACITIES

Garden
Standing: 200

Terrace
Standing: 100





WEEKEND & EVENING HIRE ONLY

Morning & Spears Room

The Morning & Spears has played host to a MasterChef semi-final, as well as a variety of brilliant business events and once-in-a-lifetime family celebrations.

Welcoming groups of four to 80 in a dining arrangement, this bright, airy space overlooking Waterloo Place is an inviting spot to dine and watch the world go by.

Located directly below the Grand Staircase with a glittering 15ft chandelier hanging highabove, this space is in a prime spot within 116 Pall Mall. With a neutral colour palette and bright, dual-aspect windows, the Morning Room is popular for private dining and celebrations.

The Spears Room adjoins the Morning and provides the ideal break-out or catering space or hire this separately for 24 seated guests.

IDEAL FOR

Drinks receptions, private dining, exhibitions, networking events, Christmas parties

CAPACITIES

Morning Room:
60 dining
120 standing

Spears Room:
24 boardroom



WEEKEND & EVENING HIRE ONLY

The Champagne Bar & Annexe

Join us and escape the everyday with regular, contemporary live music gigs and free events! Explore what's on in the Champagne Bar at 116 Pall Mall and discover endless possibilities for your event.

With vaulted ceilings and exposed brickwork, the space is full of unique original features and packed with character.

While this space operates as a Champagne Bar during the day and evenings, located at the side of the bar are two separate annexes which provide the ideal setting for drinks receptions, private dining, and networking events. These can be opened out into one space allowing for 48 seated guests or closed off to create two separate spaces for 24 seated guests.

The entire bar can also be hired privately on evenings and weekends for up to 160 standing and is always a popular choice for wedding after-parties or birthday celebration.

IDEAL FOR

Drinks receptions, gala dinners, weddings, exhibitions, networking events, Christmas parties

CAPACITIES

Champagne Bar:
160 standing

Annexe:
48 seated and
50 standing



WEEKEND & EVENING HIRE ONLY

Café Duke

Café Duke was created from the original washrooms for officers of the United Service Club.

Unique, quirky and filled with original features, it has served as a filming location for blockbuster Batman movie The Dark Knight and the award-winning TV drama Downton Abbey. With original tiled walls, floors and beautiful ceiling arches, the room has striking architecture to wow your guests.

If you are looking to hire an unusual venue to hold a dinner, networking event or drinks reception, Cafe Duke is the ideal setting. Often hired by clients as a space for drinks and socialising after a wedding or event upstairs, the room comes alive with a DJ and lighting, and also features it's own permanent bar and serving area.

IDEAL FOR

Drinks receptions, parties, private dining, networking events, wine tastings, Christmas parties

CAPACITIES

120 standing
60 dining



The Link & Business Centre

Our purpose built, state-of-the-art training facility.

Comprised of two floors with 25 various sized meeting rooms, including flexible training suites, coaching rooms, audio-visual equipment, a separate reception, breakout areas, private access via our stunning restored glass lift, alongside a self-serve catering point and barista bar.

These unique training facilities have been designed with a range of different spaces that are perfect for training courses, business meetings, seminars, team away days, webinars, filming, coaching and much, much more.

CAPACITY

From 2 to 40 guests

HIRE TYPE

By the day, half day or evening. Hourly rates are available for last minute bookings.

LAYOUTS

Theatre style, boardroom, cabaret style, U shape. There is also a private entrance and dedicated reception, with six high tech rooms, including breakout areas.

AV EQUIPMENT

Complimentary wi-fi, projector screens, plasma screens, video conferencing, recording facilities, click share, power docking.



Location

You will find our Grade I-listed building at 116 Pall Mall, in the heart of the West End and close to Trafalgar Square and St James's Park.



Transport links

Tube & train

Five minutes walking distance of Piccadilly Circus (Piccadilly & Bakerloo Lines),
Ten minutes from Charing Cross Station (Bakerloo & Northern Lines, National Rail links).

Buses

Numerous bus destinations from Trafalgar Square.

Parking

Pay and Display in Waterloo Place.
Q Park: 20% off parking when quoting "IOD" Qpark.

116 Pall Mall

Second floor overview

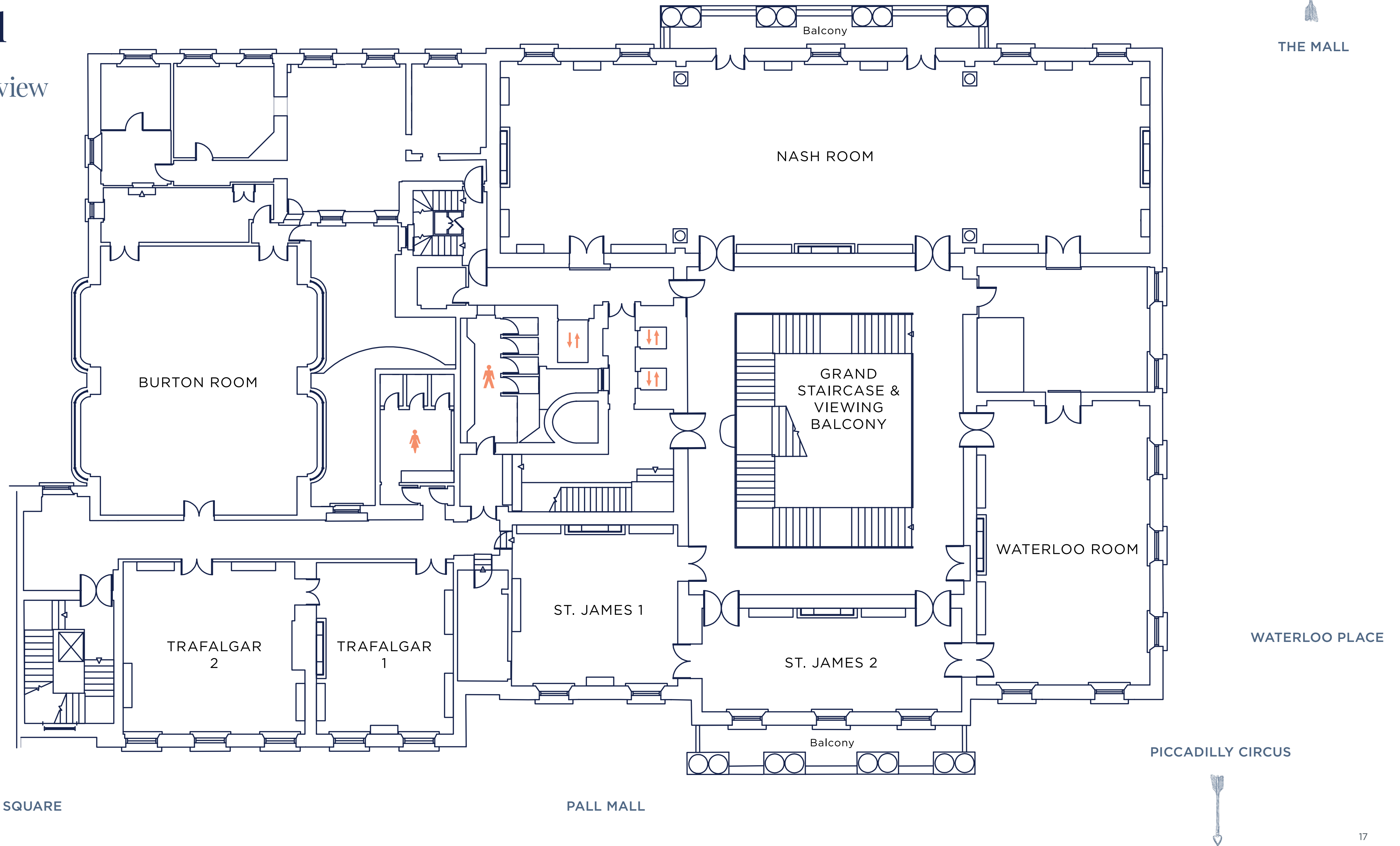

PALL MALL

PICCADILLY CIRCUS





116 Pall Mall, London SW1Y 5ED

T: 020 7451 3107

E: info@116pallmall.com

116pallmall.com

[sign up to our newsletter](#)



EST · 1847
SEARCYS
LONDON