

116  
PALL MALL

Events *at* 116 Pall Mall

BY SEARCYS

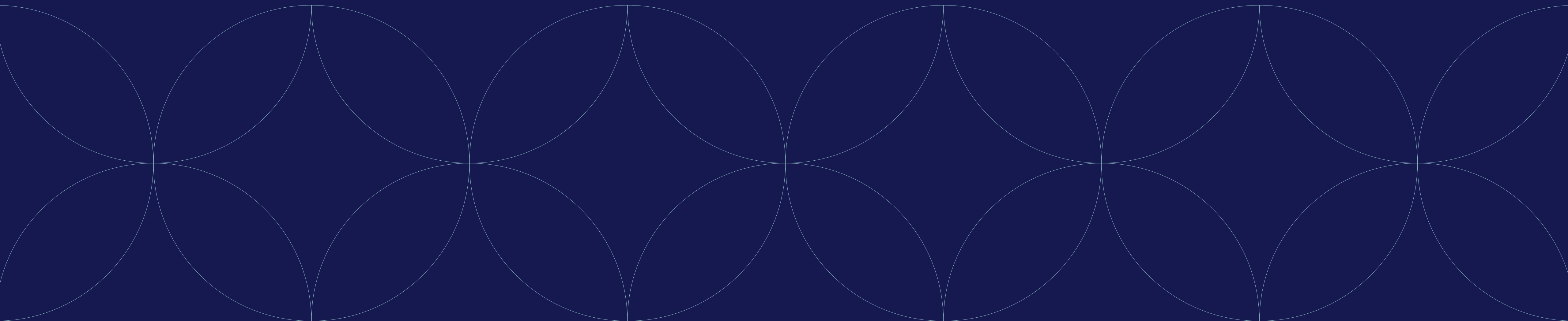



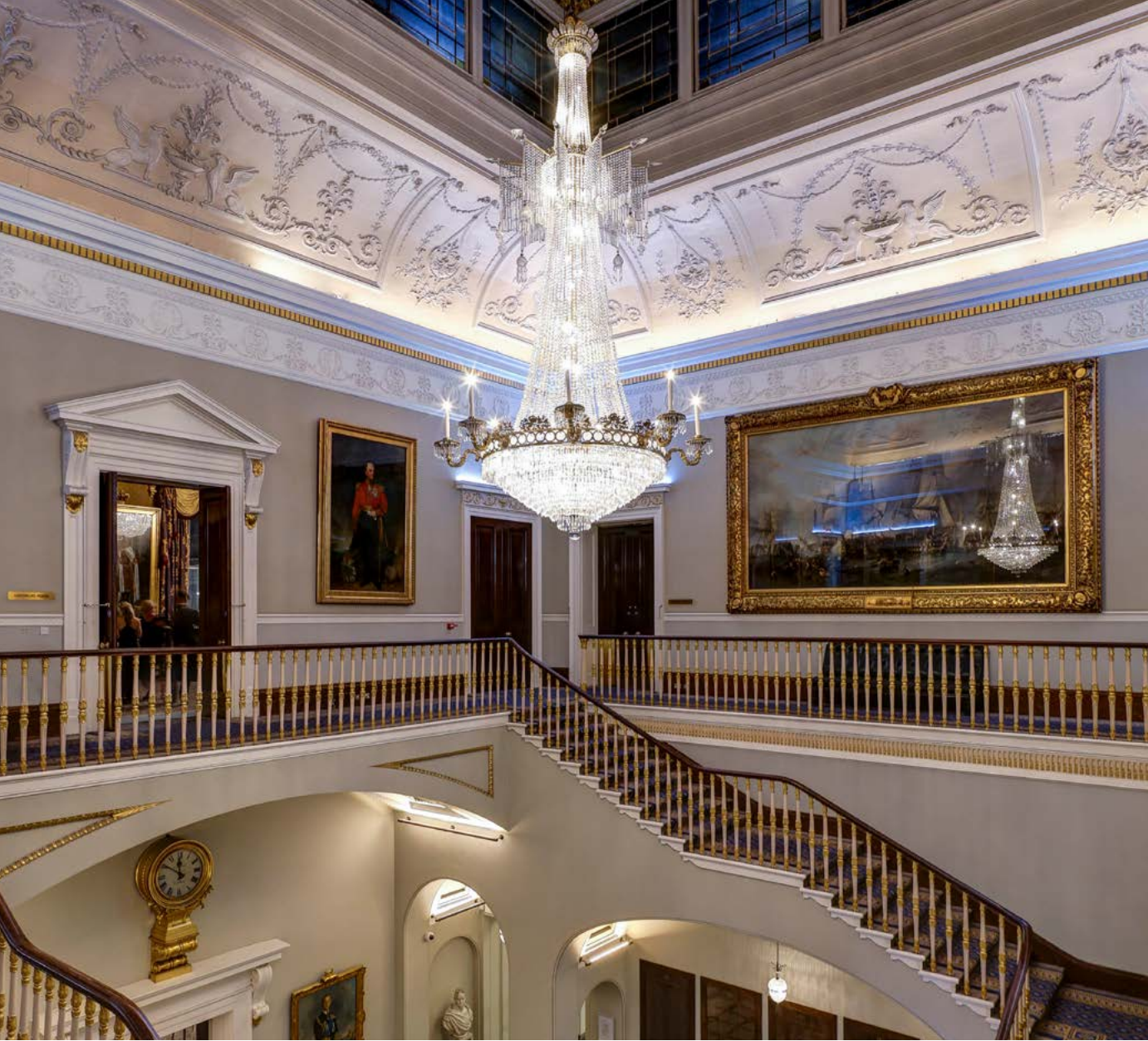



# History of 116 Pall Mall

John Nash, the famous and fashionable 19<sup>th</sup> century architect, designed 116 Pall Mall in the early 1820s.

Its imposing Regency exterior is typical of Nash's distinct style which is visible in many other buildings in the vicinity including those on Regent Street and nearby Carlton House Terrace. Nash also famously designed the Brighton Pavillion, Marble Arch and many more of London's most popular attractions.

116 is built on the site of Carlton House, the one-time London residence of the Prince of Wales prior to his accession to the throne as George IV in 1820. Carlton House was subsequently demolished when the King moved his household to the newly renovated Buckingham Palace.

The site, in the heart of London's genteel and fashionable "clubland", was then chosen as appropriate for the United Service Club. Building work took two years and was completed in 1828, £7,000 over budget and at a total bill of £45,000 (a figure in today's economy approximating £7.7 million).

The next three decades saw substantial changes to the building both inside and out as fashions changed. In 1842, Decimus Burton was employed as architect to the club and instigated a complete redecoration and some structural alterations.

Burton was the designer of the Athenaeum which stands opposite 116 across Waterloo Place. The similarities between the two buildings are obvious and owe much to Burton's alterations. They

include a large external cornice with balustrade, the frieze on the northern façade, and the fluting of the Corinthian columns on the upper portico.

Perhaps most imposingly, Burton also added the 19 cast iron flambeaux, or lanterns, around the building which were lit for ceremonial occasions, state visits and for remembrance of significant battles in British military and naval history. The flambeaux are still fully operational and can be lit for evening functions in the building.

The United Service Club occupied 116 for most of the next century and during its tenancy expanded into the adjacent buildings to provide overnight accommodation for members. These bedrooms now form the Business Centre meeting facilities on the third and fourth floors.

**Today, 116 Pall Mall is home to the Institute of Directors, a thriving membership community for directors in the UK and beyond, where you can connect with other leaders, develop your skills and be heard.**

**To find out more about the IoD and to join, please visit [iod.com](https://www.iod.com)**

**Discover more at [116pallmall.com](https://www.116pallmall.com)**





# The Nash

Named in honour of the renowned architect John Nash, who designed 116 Pall Mall in the 1820s, The Nash is one of London’s most beautiful event rooms and our most popular choice for larger gatherings.

Luxurious in style and steeped in grandeur, this 3,000 sq ft space offers a stunning setting for conferences, performances, and unforgettable events.

The Nash links seamlessly to the adjacent Waterloo Room, allowing for additional versatility and a natural flow between spaces. Guests can also enjoy the breathtaking balcony that overlooks the serene gardens, providing a peaceful retreat amid London’s historic heart.

## IDEAL FOR

Gala dinners, awards ceremonies, conferences, drinks receptions, exhibitions, meetings, press launches

## CAPACITIES

- Theatre: 350
- Cabaret: 184
- Dining: 250
- Reception: 350
- Boardroom: 90
- Hollow Square: 99
- U Shape: 90
- Classroom: 120
- Expo: 46







# The Waterloo

Overlooking both Pall Mall and Waterloo Place, The Waterloo Room is a versatile double-aspect space, ideal for conferences, presentations, or as a breakout area.

This light-filled room provides a vibrant and inviting atmosphere for a range of events.

The Waterloo Room works perfectly alongside The Nash, allowing for easy transition and added flexibility for networking or drinks receptions, with the option to extend over to the St James 1 & 2 for extra reception space. With panoramic views of Georgian architecture, it creates a memorable setting for any occasion.

## IDEAL FOR

Dinners, conferences, drinks receptions, meetings, wine tastings, Christmas parties

## CAPACITIES

- Theatre: 120
- Cabaret: 56
- Dining: 80
- Reception: 140
- Boardroom: 40
- Hollow Square: 44
- U Shape: 36
- Classroom: 30
- Expo: 17







## St. James 1 & 2

St James 1 & 2 are regal, interconnected rooms with grand sash windows offering views of Pall Mall, perfect for smaller events and gatherings.

These rooms can be used individually for intimate occasions or opened together to create a larger, adaptable space with the Waterloo, perfect for large groups.

Ideal for breakouts or catering, the rooms also seamlessly integrate with other areas like the balcony, offering a versatile solution for any event.

### IDEAL FOR

Break out rooms, breakfast meetings, board meetings, intimate dinners/lunches, drinks receptions

### CAPACITIES

#### St James 1

Theatre: 50  
Cabaret: 32  
Dining: 40  
Reception: 60  
Boardroom: 24  
Hollow Square: 32  
U Shape: 24  
Classroom: 40  
Expo: 12

#### St James 2

Theatre: 40  
Cabaret: 24  
Dining: 30  
Reception: 50  
Boardroom: 24  
U Shape: 20  
Classroom: 30  
Expo: 7

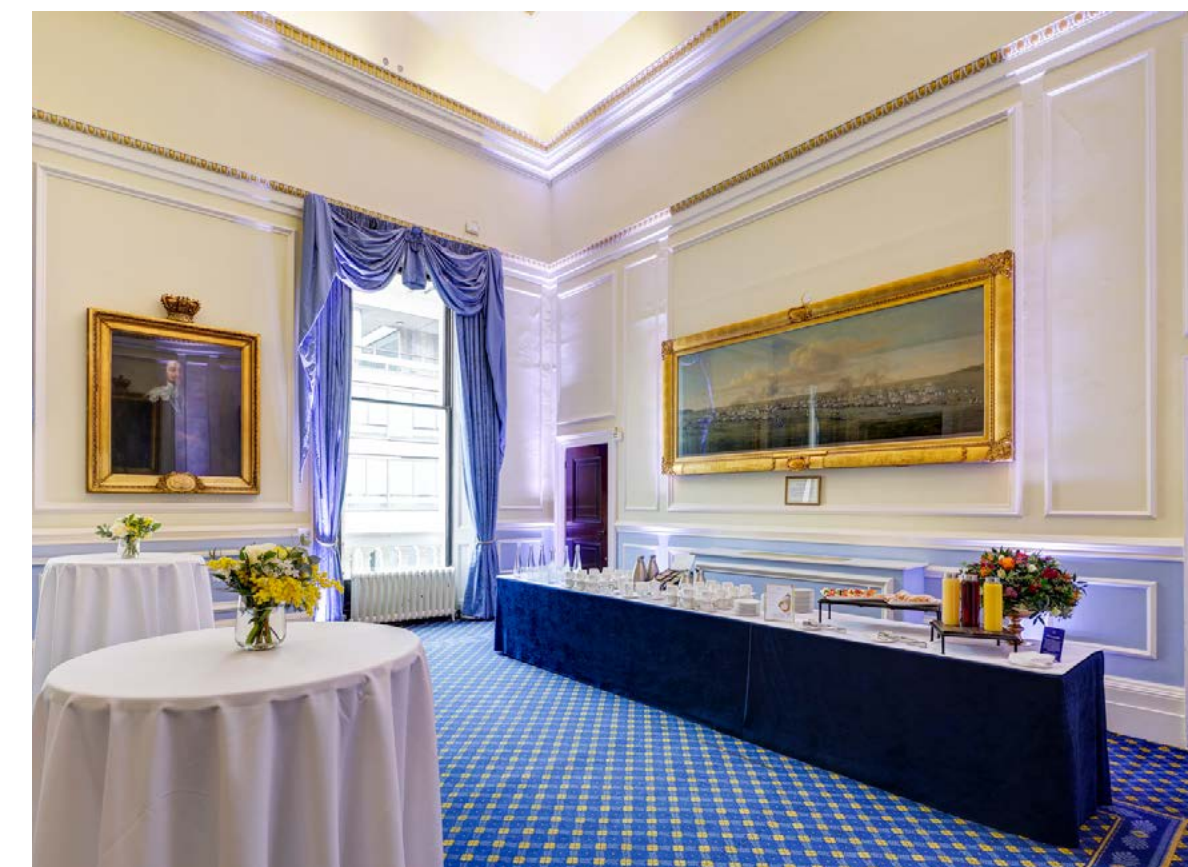





## The Burton

Steeped in classic Georgian charm, The Burton Room is a refined setting ideal for daytime events, from seminars to intimate gatherings.

With its elegant décor and versatile layout, The Burton Room offers a sophisticated space for a variety of events and can be combined with Trafalgar 1 & 2 for additional functionality.

The room is also licensed for weddings, providing an intimate yet grand setting for your special day.

### IDEAL FOR

Conferences, seminars, meetings, drinks receptions, networking events, Christmas parties

### CAPACITIES

Theatre: 140  
Cabaret: 72  
Dining: 100  
Reception: 160  
Boardroom: 40  
Hollow Square: 45  
U Shape: 40  
Classroom: 80  
Expo: 26





# The Trafalgar 1 & 2

Charming and filled with original features, Trafalgar 1 and 2 offer a naturally lit, airy ambiance that makes them ideal for a variety of event styles.

The subtle, neutral tones and timeless elegance create a versatile space, perfect for both intimate gatherings when used separately, or a more spacious setup when combined. Located opposite the Burton Room, these rooms can be hired together, providing an excellent solution for additional break-out spaces.



## IDEAL FOR

Break out room, breakfast meetings, board meetings, intimate dinners/lunches, drinks receptions

## CAPACITIES

### Trafalgar Room 1

Theatre: 50  
Cabaret: 32  
Dining: 40  
Reception: 50  
Boardroom: 24  
U Shape: 26  
Classroom: 30  
Expo: 10

### Trafalgar Room 2

Theatre: 60  
Cabaret: 40  
Dining: 50  
Reception: 80  
Boardroom: 24  
Hollow Square: 44  
U Shape: 33  
Classroom: 40  
Expo: 12









WEEKEND & EVENING HIRE ONLY

# The Carlton

Once the Smoking Room of the United Service Club, The Carlton Room is an exquisite space filled with rich history and grandeur. Featuring dramatic Ionic columns finished in marble-esque scagliola and walls lavishly adorned with gold leaf on linen, the room exudes an air of glamour and opulence.

This striking venue is a popular choice for large-scale parties and celebrations, offering flexibility to add a DJ, dancefloor, and round tables for dining to suit your event needs. The south-facing doors open onto a beautiful private terrace, offering picturesque views of the garden – making it an ideal location for summer parties and drinks receptions. The terrace also provides a welcome shelter for unpredictable weather, allowing guests to enjoy the sun and the tranquillity of green surroundings – a rare gem in the heart of central London.

With its timeless elegance, The Carlton Room is the perfect venue for a range of events, including corporate functions, birthday celebrations, and networking events, ensuring your occasion is unforgettable.

## IDEAL FOR

Drinks receptions, gala dinners, weddings, exhibitions, networking events, Christmas parties

## CAPACITIES

Theatre: 220  
Cabaret: 144  
Dining: 180 / 120 with dance floor  
Reception: 300  
Boardroom: 80  
Hollow Square: 96  
U Shape: 90  
Classroom: 120  
Expo: 30







# The Garden & Terrace

The Terrace & Garden provide a peaceful outdoor oasis in the heart of London, perfect for alfresco events, summer parties, and filming projects.

Surrounded by lush greenery, the garden offers a tranquil backdrop for any event, while the Terrace provides a stylish space for pre-theatre drinks or post-event mingling.

Searcys' seasonally curated menus and selected beverages elevate the experience, making the Terrace a perfect venue for any occasion.

## IDEAL FOR

Company events, drinks receptions, birthday celebrations or networking events.

## CAPACITIES

**Garden**  
Standing: 200

**Terrace**  
Standing: 100







WEEKEND & EVENING HIRE ONLY

## Morning & Spears Room

The Morning & Spears Rooms have hosted a variety of high-profile events, including a MasterChef semi-final, alongside numerous successful business events and unforgettable family celebrations.

This bright and airy space, with stunning views overlooking Waterloo Place, is ideal for intimate dining experiences, welcoming groups of four to 80 guests. Situated directly below the magnificent Grand Staircase with its striking 15ft chandelier, this prime location within 116 Pall Mall adds a touch of glamour to any occasion.

Whether for business gatherings, family celebrations, or private dining, the Morning & Spears Rooms provide the ideal setting for a range of events in the heart of London.

### IDEAL FOR

Drinks receptions, private dining, exhibitions, networking events, Christmas parties

### CAPACITIES

#### Morning Room

Theatre: 130 without stage / 110 with stage  
Cabaret: 60  
Dining: 70  
Reception: 120  
Boardroom: 40  
Hollow Square: 36  
U Shape: 28  
Classroom: 36  
Expo: 18

#### Spears

Reception: 30  
Boardroom: 24





WEEKEND & EVENING HIRE ONLY

# The Champagne Bar & Annexe

Discover a dynamic space at 116 Pall Mall, where contemporary live music gigs and free events set the stage for memorable moments. With its striking vaulted ceilings and exposed brickwork, the Champagne Bar is a unique venue brimming with character and charm, offering a distinct atmosphere for your event.

By day and night, the Champagne Bar serves as a stylish hub, perfect for a wide range of events. Adjacent to the bar, two private annexes provide an ideal setting for drinks receptions, private dining, and networking events. These spaces can be combined to accommodate up to 50 guests standing or kept separate for more intimate gatherings, hosting 24 seated guests in each.

For larger events, the entire Champagne Bar is available for exclusive hire on evenings and weekends, accommodating up to 150 standing guests. Whether it's a wedding after-party, birthday celebration, or corporate event, the Champagne Bar offers a distinctive, vibrant atmosphere for every occasion.

IDEAL FOR

Drinks receptions, gala dinners, weddings, exhibitions, networking events, Christmas parties

CAPACITIES

**Champagne Bar**  
Reception: 120  
or 150 with  
one annex

**Annexe**  
Theatre: 24  
Dining: 20  
Reception: 25  
(one annex)/  
50 (both annex)  
Boardroom: 26





WEEKEND & EVENING HIRE ONLY

# Café Duke

Originally the washrooms for officers of the United Service Club, Café Duke is a distinctive and quirky venue that blends original features with a rich history.

With its striking tiled walls, intricate ceiling arches, and bold architectural details, this space has also made its mark as a filming location for the blockbuster Batman movie, The Dark Knight, and the award-winning series Downton Abbey.

For those seeking a truly unusual venue, Café Duke offers a memorable setting for dinners, networking events, and drinks receptions. Its unique charm and character provide the perfect backdrop for any occasion.

Frequently hired for post-wedding celebrations or as an after-party venue, Café Duke truly comes alive with a DJ, dynamic lighting, and its own permanent bar and serving area, making it the ideal spot for guests to unwind and socialise.

Whether you're hosting a social gathering or a more formal event, Café Duke promises to impress and provide an unforgettable experience.

## IDEAL FOR

Drinks receptions, parties, private dining, networking events, wine tastings, Christmas parties

## CAPACITIES

Theatre: 80  
Cabaret: 40  
Dining: 60  
Reception: 120  
Boardroom: 30  
U Shape: 62  
Classroom: 40  
Expo: 17





# The Link

A state-of-the-art training facility, designed with flexibility in mind to accommodate a variety of professional events.

With six adaptable meeting suites, The Link is equipped with modern AV technology, ideal for workshops, training sessions, and collaborative meetings.

A shared networking area and refueling station ensure a comfortable environment, while the barista bar adds a touch of sophistication to any professional gathering



## CAPACITY

From 2 to 40 guests

## HIRE TYPE

By the day, half day or evening. Hourly rates are available for last minute bookings.

## LAYOUTS

Theatre style, boardroom, cabaret style, U shape. There is also a private entrance and dedicated reception, with six high tech rooms, including breakout areas.

## AV EQUIPMENT

Complimentary wi-fi, projector screens, plasma screens, video conferencing, recording facilities, click share, power docking.





# Location

You will find our Grade I-listed building at 116 Pall Mall, in the heart of the West End and close to Trafalgar Square and St James's Park.



## Transport links

### Tube & train

Five minutes walking distance of Piccadilly Circus (Piccadilly & Bakerloo Lines),  
Ten minutes from Charing Cross Station (Bakerloo & Northern Lines, National Rail links).

### Buses

Numerous bus destinations from Trafalgar Square.

### Parking

Pay and Display in Waterloo Place.  
Q Park: 20% off parking when quoting “IOD” Qpark.



# 116 Pall Mall

Ground floor overview

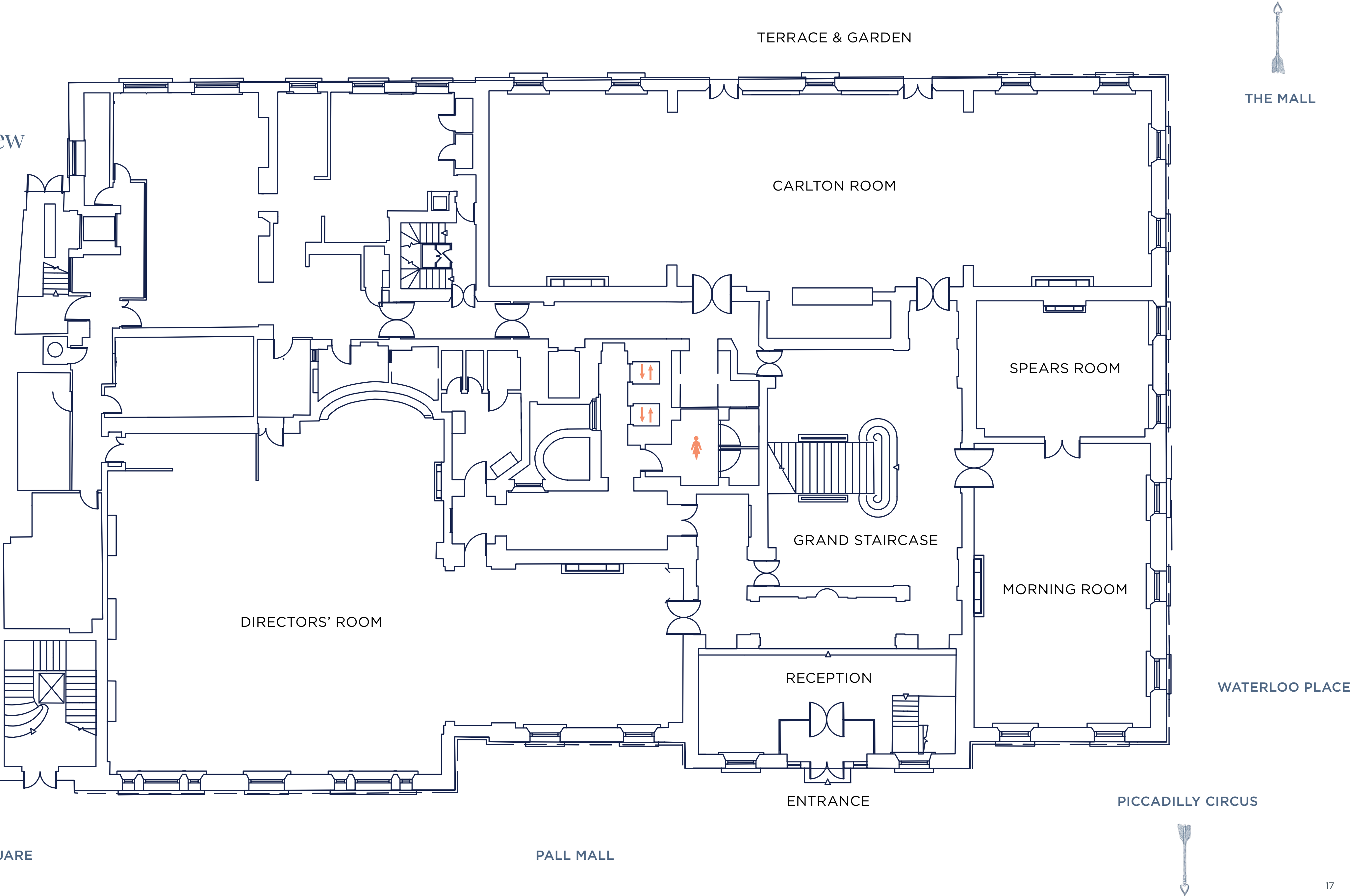



# 116 Pall Mall

Second floor overview

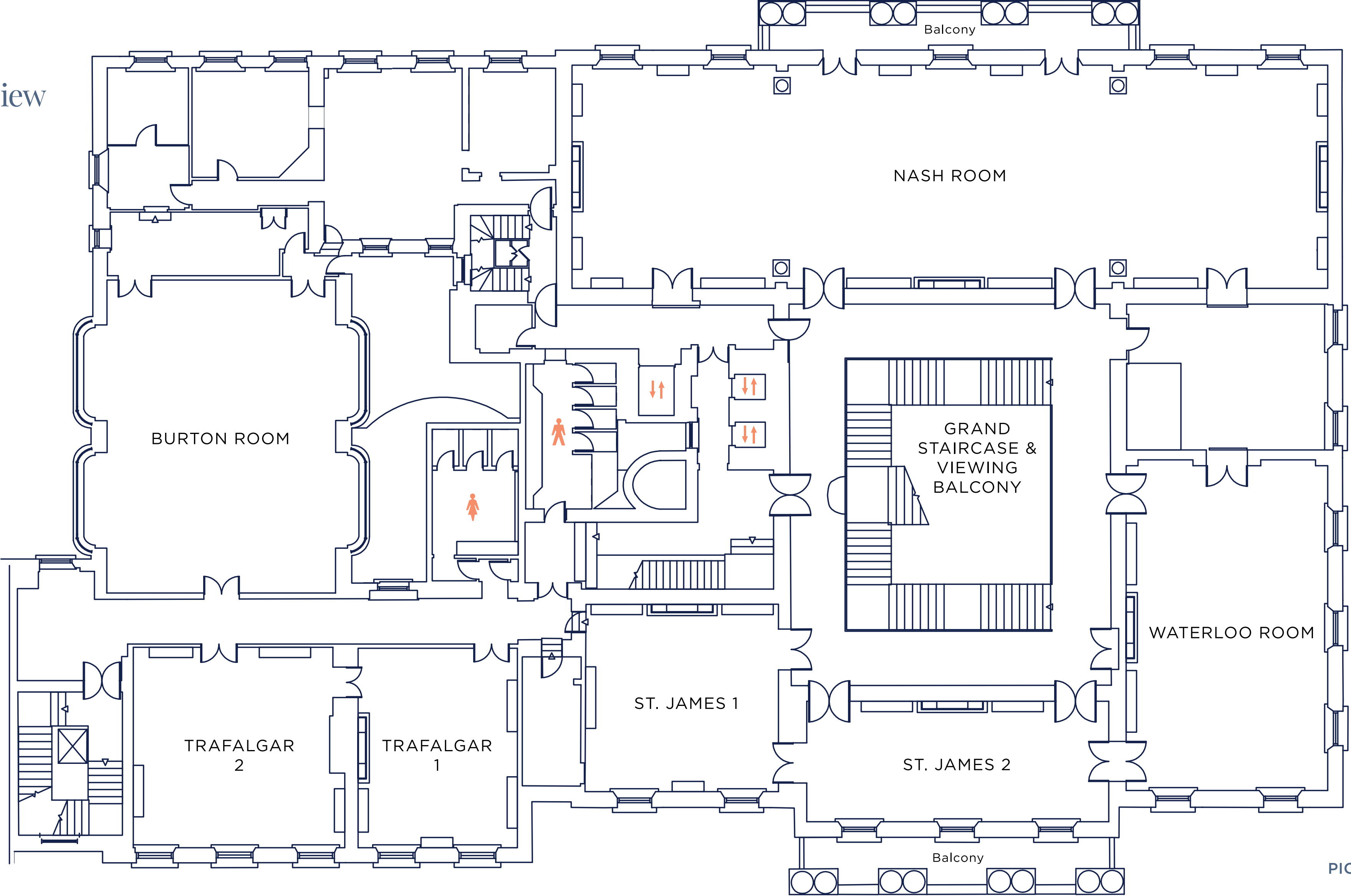

THE MALL

WATERLOO PLACE

PICCADILLY CIRCUS



TRAFALGAR SQUARE

PALL MALL



# Institute of Directors

---

116 Pall Mall is home to the Institute of Directors (IoD), a thriving membership community for directors in the UK and beyond, where you can connect with other leaders, develop your skills and be heard.

## IoD membership

At a time when great directors have never been more important, the IoD offers professional development, valuable connections and influence.

With a wide range of benefits available to support you as a director, the IoD is a great place to connect and share knowledge.

---

**Full membership:**  
**£494 per year (£44.46 per month)**

**International membership:**  
**£248 per year**

---

[\*\*iod.com/why-join-us\*\*](https://iod.com/why-join-us)

## Professional development and training with the IoD

Whether you're starting or cementing your role as a company director the IoD can help you develop your existing business skills and broaden your knowledge with new ones.

Our world-class professional development is designed by directors for directors to help you and your senior leaders steer your organisation effectively and successfully supporting a shared commitment to lifelong learning.

We are the only institute to offer the internationally recognised Chartered Director Qualification.

---

With reduced rates for members on all our courses.

---

[\*\*iod.com/professional-development\*\*](https://iod.com/professional-development)







116 Pall Mall, London SW1Y 5ED

T: 020 7451 3107

E: [info@116pallmall.com](mailto:info@116pallmall.com)

[116pallmall.com](http://116pallmall.com)

[sign up to our newsletter](#)



EST · 1847  
**SEARCYS**  
LONDON