

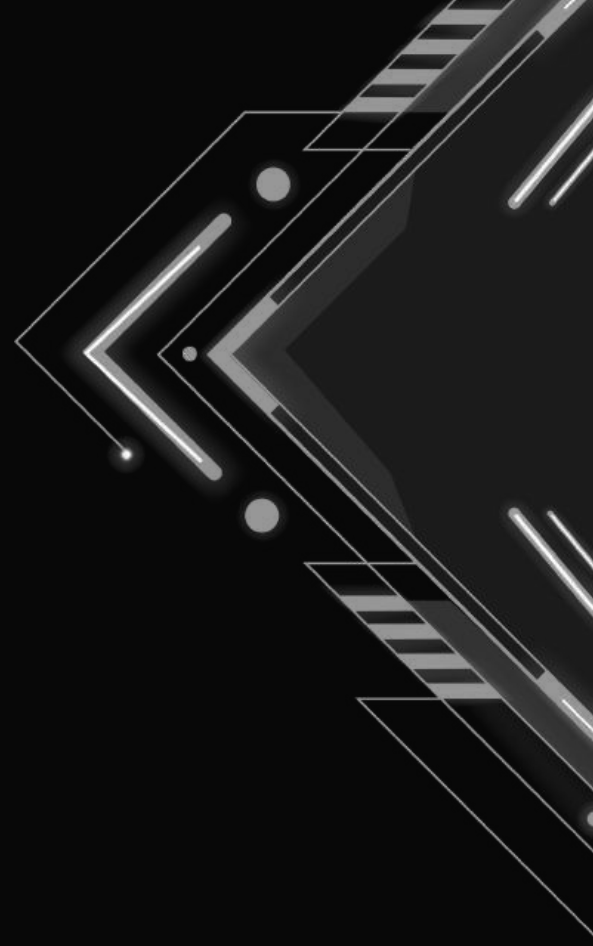

# THE HANGAR WOLVERHAMPTON

VENUE INFORMATION & TECHNICAL SPECS.





This is a condensed version of our venue specification deck.  
For the most up-to-date and comprehensive version, please contact us at  
[info@hangarvenues.co.uk](mailto:info@hangarvenues.co.uk) and we'll be happy to provide the latest document.





Formally one of the oldest steel manufacturing warehouses in Wolverhampton, The Hangar is a 17,000 sq ft venue offering event organisers a unique, versatile and exciting space.

The building itself is a single bay industrial building of steel truss roof construction and brick side elevations. It contains translucent roof lights, fully operational overhead cranes, the latest in sound and light technology and giant LED screens for visual effect.

The Hangar can be transformed and resized to suit the requirements of many different events, from large-scale concerts and intimate comedy nights, to live sport, cinema and street food festivals. The possibilities are endless.

Our passionate team is experienced in creating exceptional and memorable events. Get in touch today to discuss how we can bring your event ideas to life. Email [info@hangarvenues.co.uk](mailto:info@hangarvenues.co.uk).

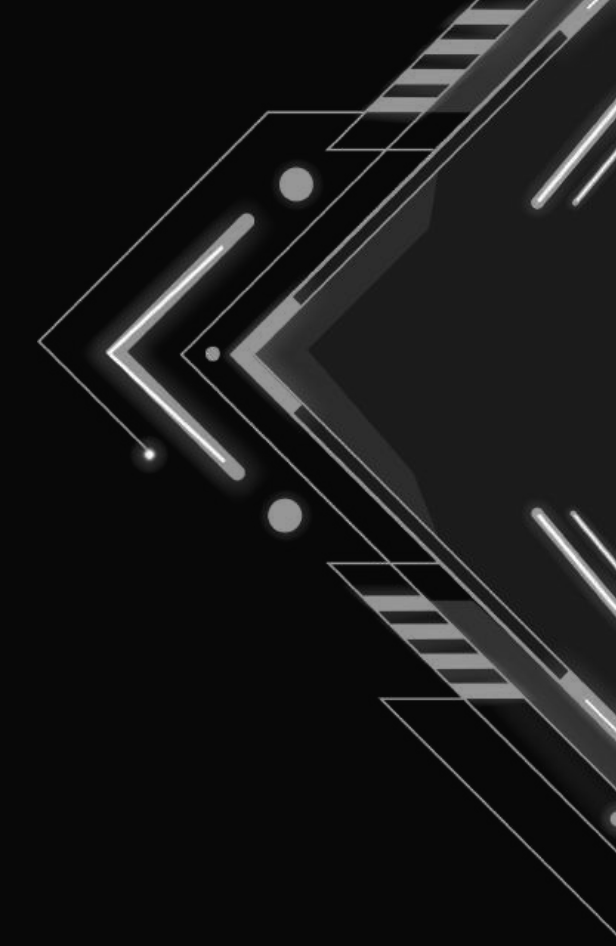



## LOCATION

The Hangar is located in Wolverhampton, in the heart of the West Midlands, just outside the city centre. The venue benefits from excellent transport links, making it easily accessible for guests, artists, promoters and production teams.

Positioned within one of the UK's largest urban regions, The Hangar provides access to millions of people within a short travel distance and is conveniently located near major road and public transport routes connecting Birmingham, the wider Midlands and beyond.

Address: Pearson St, Wolverhampton WV2 4HP

WhatThreeWords: ///HARDER.TRANSMITTED.ELBOW

## PARKING

### Parking Capacity:

- 1 bus
- 1 truck
- 3 vans / splitters
- Various cars

Additional Parking: Parking available around the venue, on street parking  
Power: 32amp Single phase available on Pountney Street

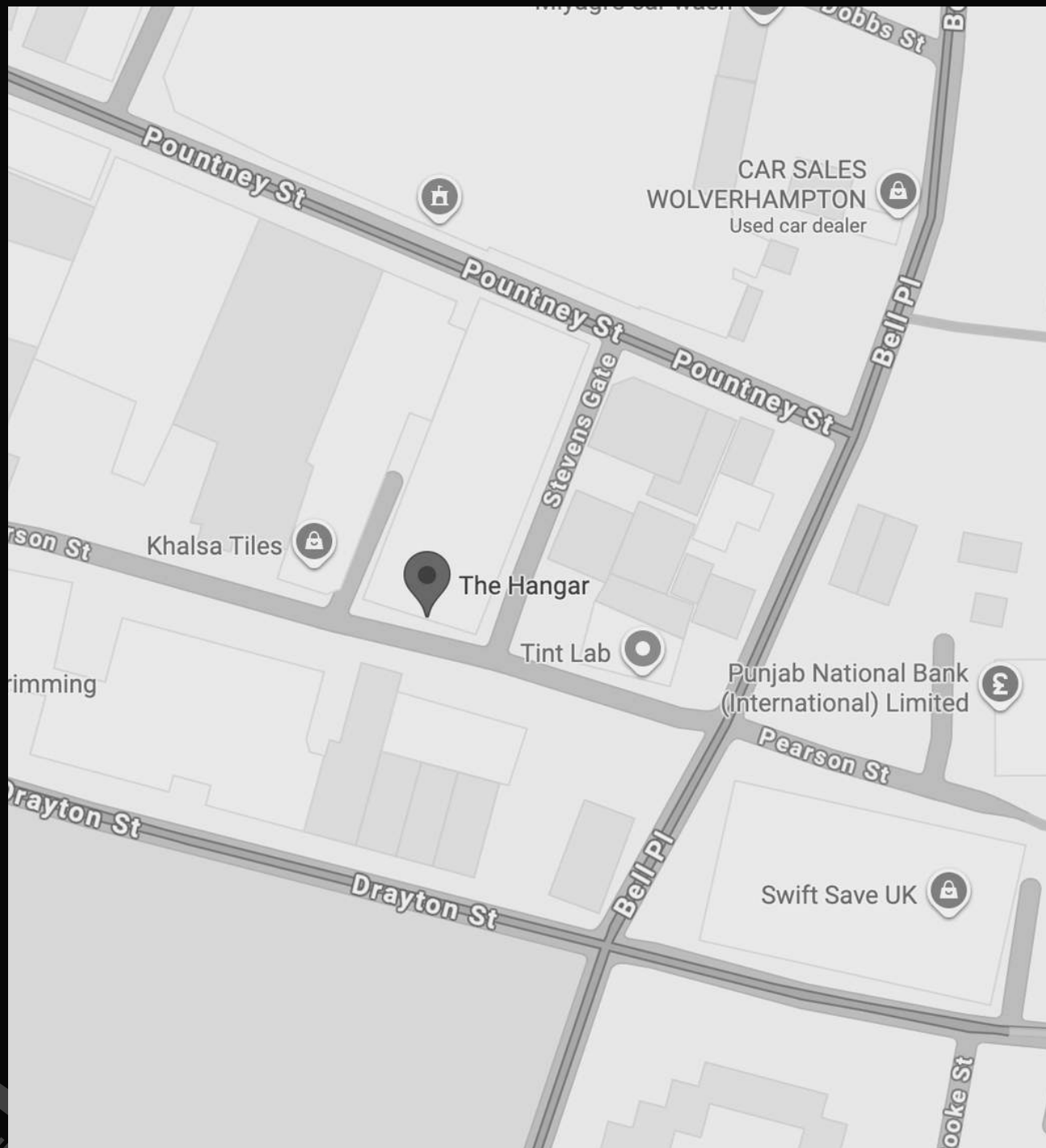

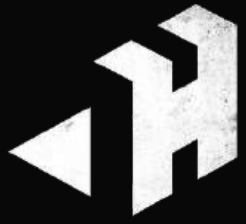

# VENUE MAP

*Detailed maps are available upon request.*

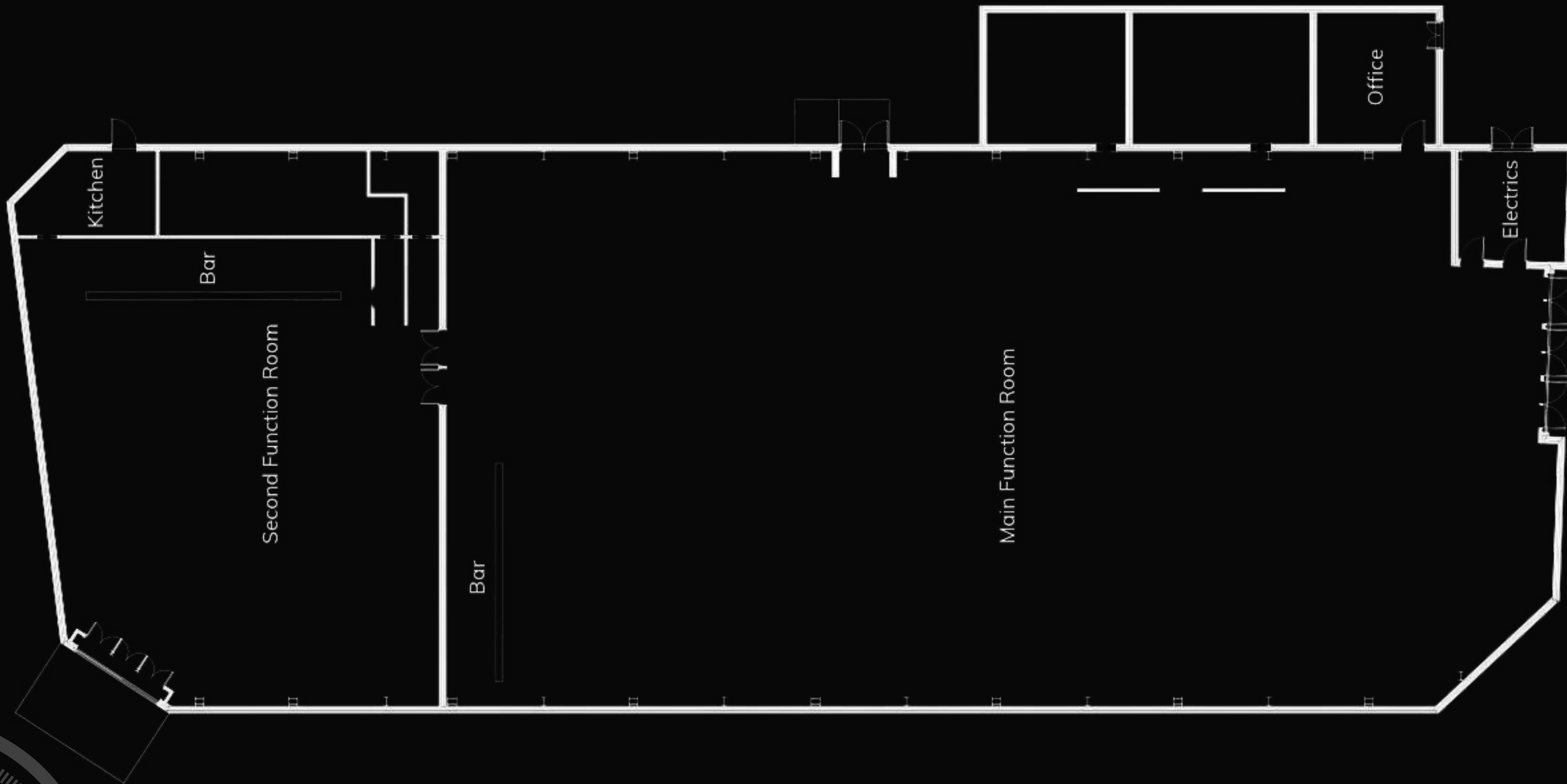



# VENUE MAP

Detailed maps are available upon request.

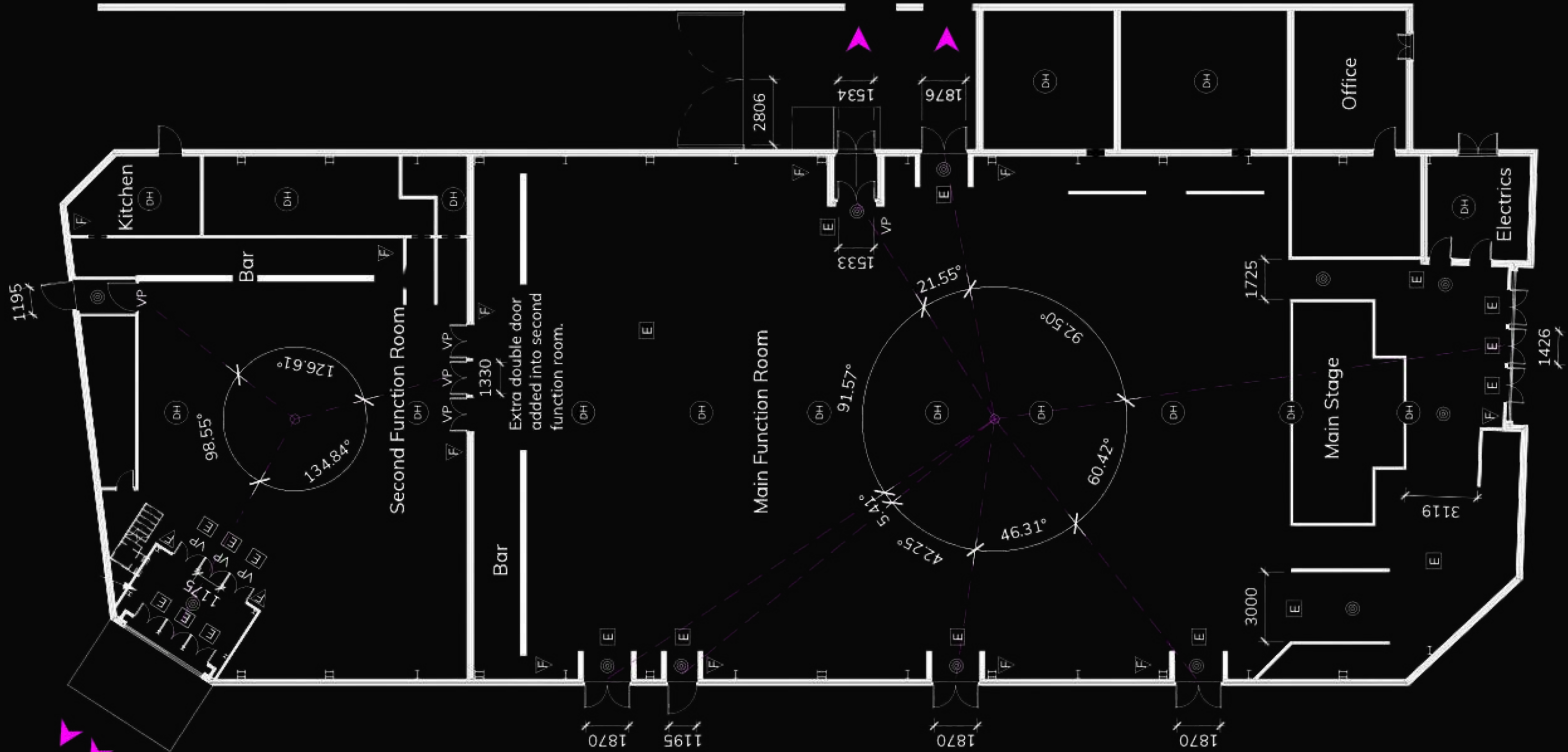



## VENUE LICENCE & CURFEWS

The Hangar is licensed to open to the public from 8:00am – 1:30am Sunday to Thursday, and 8:00am – 4:00am on Friday and Saturday.

The venue holds a 1:00am licence midweek for live music and club events, and a 3:30am licence on weekends.

Door times can be tailored to suit event requirements; however, the following are our typical operating times:

### Boxing Events

Typical timings: 5:00pm – 10:00/11:00pm

### Live Gigs / Concerts

Typical timings: Doors 6:00pm | Curfew 10:00pm

### Club Nights / Late Events

Typical operating hours: 10:00pm – 4:00am

### Bottomless Brunch Events

Typical timings: 12:00pm – 4:00pm

### Bingo / Interactive Shows

Typical timings: 6:00pm – 10:00pm

*Alternative schedules can be tailored to suit event requirements, provided they remain within the conditions of the venue licence.*

## TICKETING

### Preferred Ticketing Platforms

The Hangar works primarily with Skiddle and Fatsoma, both of which integrate with our venue systems and entry scanning. Promoters are welcome to discuss alternative platforms where required, provided they are compatible with the venue's ticket scanning systems.

### Venue Allocation

For ticketed events, the venue may require an agreed ticket allocation via the venue box office. This allows the venue to support marketing activity and track ticket sales. The exact allocation can be agreed with promoters depending on the event.

### Presale Access

Where applicable, the venue may request a short presale window via the venue ticket link prior to general release to support venue marketing channels.

### Door Scanning & Ticket Compatibility

All ticketing platforms must be compatible with the venue's entry scanning systems. Where compatibility is not available, the venue can provide approved ticket stock or scanning solutions to ensure smooth entry operations on the event day.

## CAPACITY

### Whole Venue

Seated: 1,200

Standing: 2,000 - 2,200

Boxing Events: 1000 - 1,200+ (Depending on venue set up)

### Club Exit

Standing: 300

Seated: 100-150

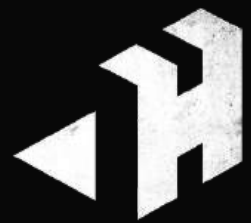

# VENUE SPACES

---

## HANGAR MAIN SPACE

This is the main event space, utilising the full venue footprint, including the primary floor and bar area located in the rear room.



## CLUB EXIT

This configuration utilises the rear bar area as a standalone space, with the main floor entrance draped off to create a more contained environment. This space offers a maximum capacity of up to 300 guests.

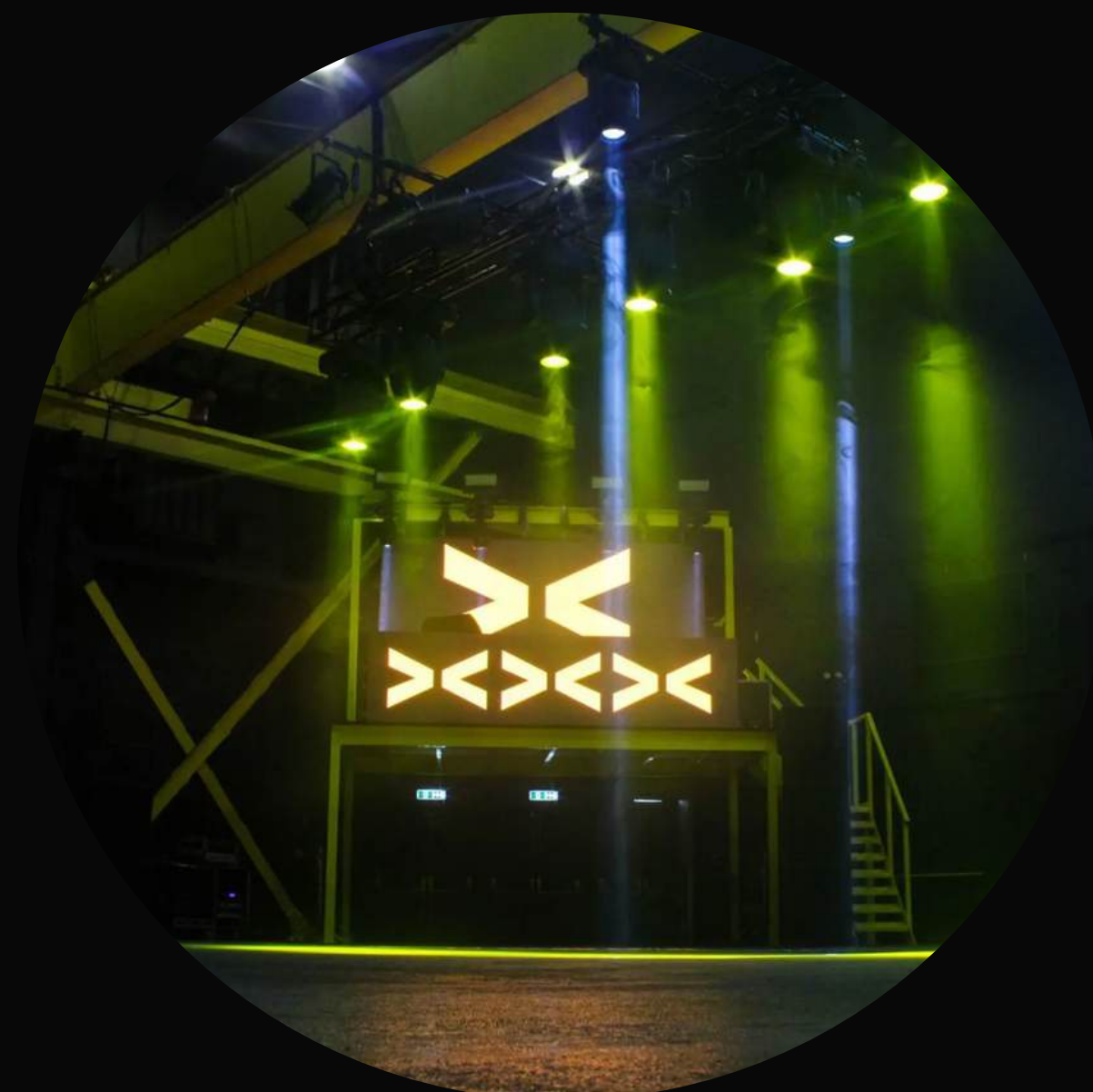



## AGE RESTRICTIONS

All Ages are permitted to attend events finishing before 11pm, Under 14's must be accompanied by an adult (18+).

All events which run past 11pm are strictly 18+ and this must be included on all advertising.

## ACCESSIBILITY

Customers with accessible requirements will be offered space within the venue accessible area. Complimentary carer tickets are available via the venue who manage all eligibility and allocations.

All other ticket agencies should direct customers to the venue for any enquiries / purchase.

## WELFARE

The Hangar operates a number of recognised safety and welfare initiatives, including Ask for Angela, the Clive Scheme, and anti-spiking.

A dedicated welfare area is available within the venue where customers can seek support if needed. The welfare space is staffed by trained personnel who are able to assist guests and respond to welfare concerns quickly and appropriately.



**32AMP**

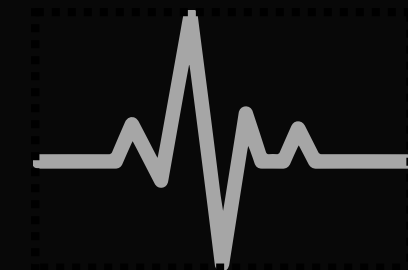



# FACILITIES

## BACKSTAGE & ARTIST FACILITIES

### Dressing Rooms & Green Room

The venue provides 1 dressing room and 1 green room. All backstage areas have direct stage access via the green room.

Backstage access is located one flight of stairs above stage level. Please note there is no lift access available.

### Wi-Fi

Wi-Fi is available in the backstage area only. The password will be provided on the day of the show.

### Green Room

A green room is located immediately off stage, leading through to the dressing room area.

## PRODUCTION & EVENT SUPPORT

### Crowd Management

Crowd management services are supplied in-house by TLG

### Front of Stage Barrier

The venue provides a MOJO-style front of stage barrier system suitable for live music and standing events.

### Crew & Event Staff

Additional crew can be arranged during the advancing process via the venue's preferred suppliers. External suppliers must be recognised companies with appropriate insurance.

### Additional Event Options

#### After Show Events

The venue has the capacity to host after-show events for a maximum of 300 guests. Please discuss requirements with the venue team in advance.

### Filming & Recording

Any filming or recording at the venue, whether commercial or non-commercial, must be approved in advance by the venue team.





## VENUE SPACE

The venue can be hired as a full venue, or the rear room (Club Exit) can be hired separately as an independent space, depending on the requirements of the event.

## BAR

The venue features a large main bar, typically configured into five serving lanes with ten till points to allow for fast and efficient service during busy events. A secondary pop-up bar is located at the rear of the main room, and the venue also has the capability to install additional pop-up bars throughout the space depending on event requirements.

## TOILETS

The venue has separate male and female toilet blocks, along with an accessible toilet facility available for guests who require it.

## FOOD & CATERING

The venue has an in-house kitchen capable of serving a variety of food suitable for a wide range of occasions. A range of catering options can also be arranged depending on the requirements of the event.





## LOAD IN / LOAD OUT

Load in times to be discussed with venue in advanced depending on the event.

**Load in address:** Pountney Street, WV2 4HX

**Load in details:** Load in is through fire doors at the rear of stage, approx. 10m push to stage, the venue does not own a ramp.

**Load in doors:** Width: 3 x 1.9m / Height: 2.00m doors (back stage)

## STAGE / STAGING

**Stage Construction:** 8'x4' steel deck sections

**Max stage width:** 9.75m / 32'

**Max stage depth:** 4.87m / 16' – Centre 2 sections

**Min stage depth:** 3.66m / 12' – Outside 2 sections

**Stage Height:** 1.10m / 3' 6"

**Risers:** 2x 8'x4' riser available – Various Size legs available.

## FLYING / RIGGING

There is a house Front and Rear Truss. There are also trusses at the rear of the venue used for club events.

The venue also has some traditional 6 way par cans in the roof space utilised for boxing style events.

**Back Truss:** 1000Kgs

**Front Truss:** 1000Kgs

## STAGE POWER

All power at the venue is on the Wall approx. 20' upstage from stage left.

It is then run to a small closed off area at the wall, immediately stage left.





# LIGHTING SYSTEM

## Control

Avolites T3 Console  
Avolites Titan Software

## Back of stage

Elation Satura Spot CMY  
ADJ F4YBAR 18 Light Bars  
Fusion 260ZR MKII Moving Head Beam / Spot Hybrid

## Front of stage

Elation Satura Spot CMY  
Satura Spot CMY PRO

## Vertical / Side Lighting (Stage Wings / Uprights)

ADJ Jolt 300 Strobe  
Fusion 260ZR MKII Moving Head Beam / Spot Hybrid  
Satura Spot CMY PRO

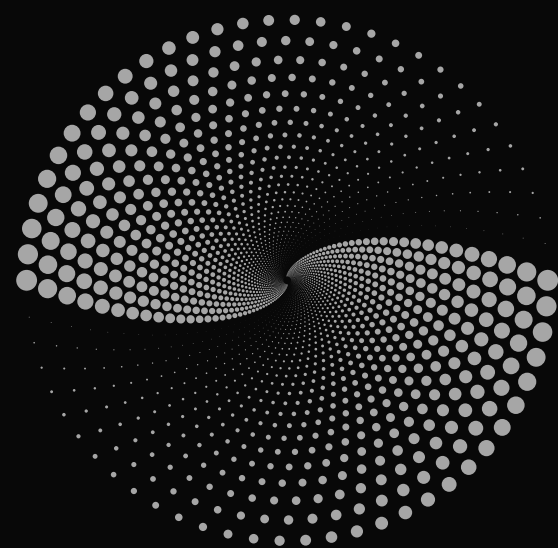
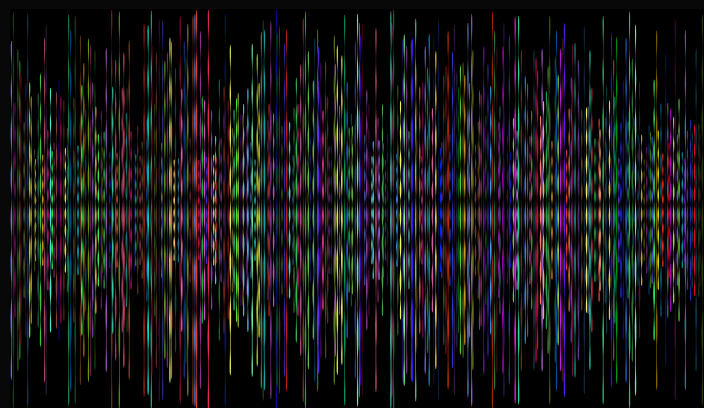

## Front of stage Truss (overhead)

Elation Satura Spot CMY  
Satura Spot CMY PRO  
LED PAR / wash lights

## Overhead Track Mounted Lighting System (Facing floor)

Elation Satura Spot CMY  
ADJ Jolt 300 Strobe  
Satura Spot CMY PRO

## Rear of venue

Elation Satura Spot CMY

## Special Effects:

Smoke and haze may be used freely. Pyrotechnics and lasers may only be used by prior arrangement. Method statements, risk assessments and insurance documentation will be required, and all operators must be deemed competent. A minimum of 2 weeks' notice is required.



*A/V solutions can be customised to suit the specific needs of each event. Enquire for further details.*



# LIGHTING SYSTEM

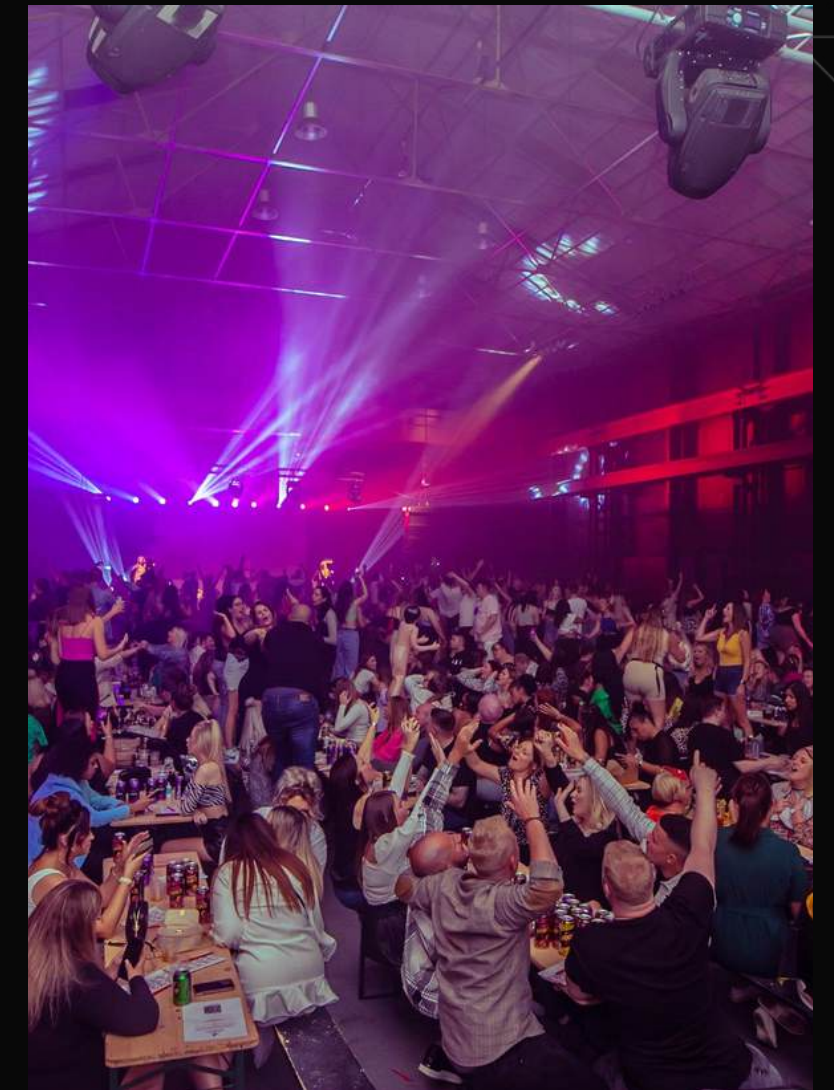



*A/V solutions can be customised to suit the specific needs of each event. Enquire for further details.*

## VIDEO SYSTEM

**Video Screen Main Room (Rear of Stage):**  
6m x 3m Absen LED screen

**Video Screen - Club Exit**  
6m x 1m Absen LED screen (top)  
6m x 1m Absen LED screen (bottom)

**DJ Riser Video:**  
Enquire as multiple options available  
Please note: for live shows the DJ riser will not be in place.

**Screen Type:**  
Absen A3 Pro – 3.9mm pitch  
**Processor:**  
Novastar 660





*A/V solutions can be customised to suit the specific needs of each event. Enquire for further details.*

## AUDIO SYSTEM

### Configuration:

#### Flown

#### Flown per side:

4 × L-Acoustics V-DOSC

4 × L-Acoustics dv-DOSC

#### In-fills per side:

2 × L-Acoustics ARCS

#### Subs per side:

3 × L-Acoustics SB28

### Control for Live Events

#### FOH Desk:

1 × Midas M32 Digital Mixing Console

#### Multicore System:

1 × 48-way multicore and split system

#### Monitors:

12 × L-Acoustic wedges

1 × 18" drum sub

#### Monitor Mixes:

6 mixes available on stage

#### Backline Power:

8 × 13A drops available on stage

#### Microphones:

Touring microphone and DI box package

#### Miscellaneous:

12 × tall boom stands

12 × short boom stands

### Control for DJ / Club Events

#### FOH Desk:

1 × Midas M32 Digital Mixing Console

#### Monitors:

4 × L-Acoustic wedges

#### Miscellaneous:

4 × tall boom stands

4 × DI boxes

2 × Shure SM58 microphones

2 × Sennheiser EW 300 G4 handheld microphones

The audio setup can be fully customised to suit the specific requirements of each event, with configurations tailored to the format, audience size, and production needs.

All requirements can be discussed directly with our technical team to ensure the most suitable setup is delivered.

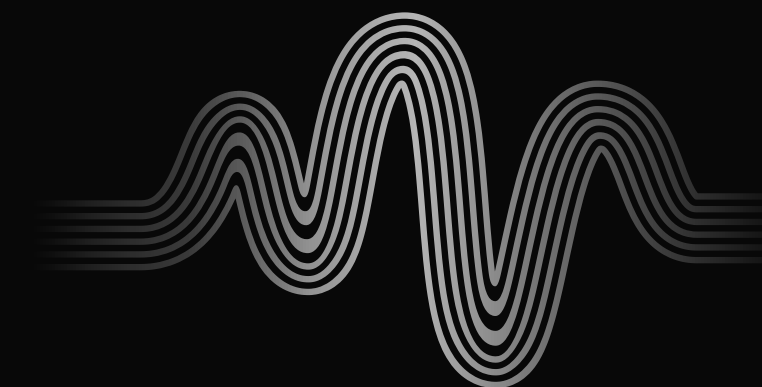



# EXAMPLE OF SET UP

---





## EXAMPLE EVENTS



**GIGS & LIVE MUSIC**



**COMBAT SPORTS**

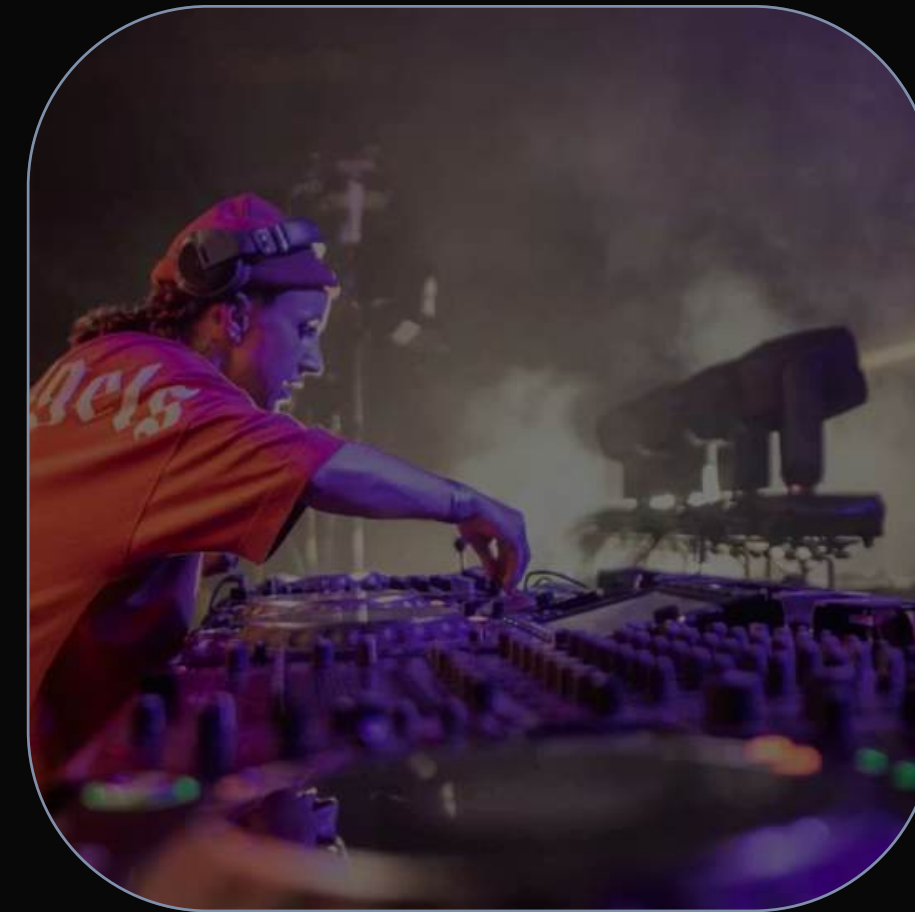

**DJ / NIGHT CLUB SHOWS**



## EXAMPLE EVENTS



**BRUNCHES / HYBRID**



**DANCE SHOWS**



**INTERACTIVE SHOWS**  
(BINGOS, GAMES, ETC.)



## EXAMPLE EVENTS



**FOOD SHOWS**



**EXPOS & SHOWCASES**



**BIG SCREEN EVENTS**



## LINKS & SOCIALS

**Linktree:** [www.linktr.ee/Hangarvenue](http://www.linktr.ee/Hangarvenue)

**Facebook:** [www.facebook.com/TheHangarWarehouse/](http://www.facebook.com/TheHangarWarehouse/)

**Instagram:** @thehangarwarehouse

**Fatsoma:** [www.fatsoma.com/p/hangar](http://www.fatsoma.com/p/hangar)

**Skiddle:** <https://www.skiddle.com/whats-on/Wolverhampton/The-Hangar-/>

## CONTACT

**Email:** [info@hangarvenues.co.uk](mailto:info@hangarvenues.co.uk)



MEMPHIS LIGHTS  
NEAR CENTER  
STAY AND STAY

WL3-2T

SWL3-2T

MEMPHIS LIGHTS  
NEAR CENTER  
STAY AND STAY

